

1996 KDX200 PARTS DIAGRAM

Front Fork(KDX200-H1-H3)

F2340

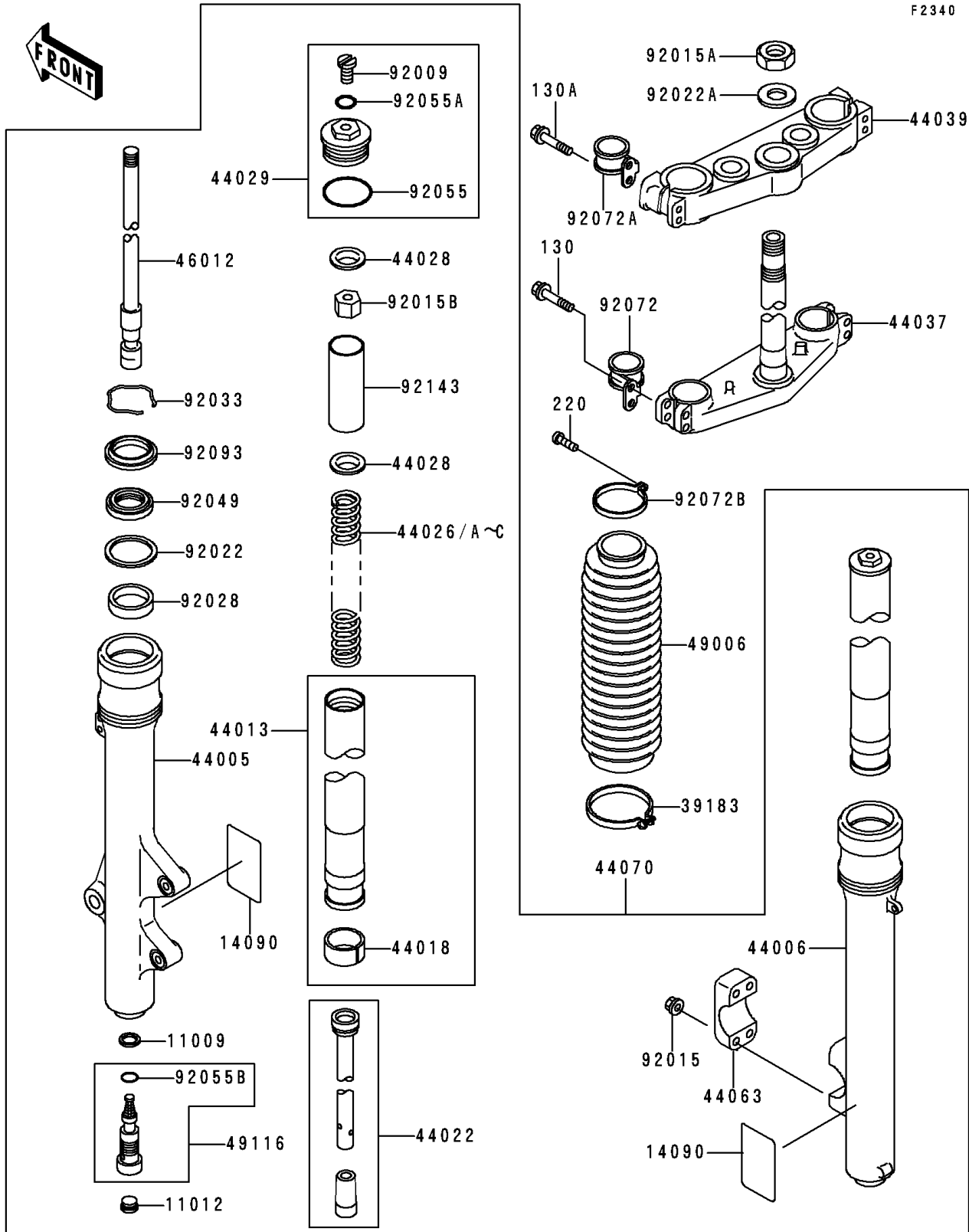

1996 KDX200 PARTS LIST

Front Fork(KDX200-H1-H3)

ITEM NAME	PART NUMBER	QUANTITY
GASKET,FORK CYLINDER BOLT (Ref # 11009)	11009-1592	1
CAP,FORK CYLINDER (Ref # 11012)	11012-1381	1
COVER (Ref # 14090)	14090-1564	1
BAND-ASSY,BOOT (Ref # 39183)	39183-1060	1
PIPE-LEFT FORK OUTER (Ref # 44005)	44005-1345	1
PIPE-RIGHT FORK OUTER (Ref # 44006)	44006-1343	1
PIPE-FORK INNER (Ref # 44013)	44013-1403	1
PISTON-FORK,INNER PIPE (Ref # 44018)	44018-1056	1
CYLINDER-FORK (Ref # 44022)	44022-1299	1
SPRING-FRONT FORK,K=0.35 (Ref # 44026)	44026-1570	1
SPRING-FRONT FORK,K=0.34 (Ref # 44026A)	44026-1574	1
SPRING-FRONT FORK,K=0.36 (Ref # 44026B)	44026-1575	1
SPRING-FRONT FORK,K=0.37 (Ref # 44026C)	44026-1576	1
GUIDE-FORK SPRING (Ref # 44028)	44028-1010	1
SEAT-FORK SPRING (Ref # 44029)	44029-1152	1
HOLDER-FORK UNDER (Ref # 44037)	44037-1331	1
HOLDER-FORK UPPER (Ref # 44039)	44039-1256	1
HOLDER-FRONT AXLE (Ref # 44063)	44063-1056	1
DAMPER-ASSY,FORK SET (Ref # 44070)	44070-1369	1
ROD,FORK (Ref # 46012)	46012-1376	1
BOOT,FORK,J.S.VIOLET (Ref # 49006)	49006-1296-VW	1
VALVE-ASSY,FORK (Ref # 49116)	49116-1132	1
SCREW (Ref # 92009)	92009-1568	1
NUT,FLANGED,6MM (Ref # 92015)	92015-1078	1
NUT,STEERING STEM,22MM (Ref # 92015A)	92015-1653	1
NUT (Ref # 92015B)	92015-1839	1
WASHER (Ref # 92022)	92022-1299	1
WASHER,STEERING STEM (Ref # 92022A)	92022-1873	1
BUSHING (Ref # 92028)	92028-1581	1

1996 KDX200 PARTS LIST

Front Fork(KDX200-H1-H3)

ITEM NAME	PART NUMBER	QUANTITY
RING-SNAP (Ref # 92033)	92033-1077	1
SEAL-OIL,FORK OUTER TUBE (Ref # 92049)	92049-1316	1
RING-O (Ref # 92055)	92055-1123	1
RING-O (Ref # 92055A)	92055-1441	1
RING-O,FORK VALVE (Ref # 92055B)	92055-1502	1
BAND,CABLE (Ref # 92072)	92072-1166	1
BAND (Ref # 92072A)	92072-1268	1
BAND,BOOT (Ref # 92072B)	92072-1316	1
SEAL,FORK DUST (Ref # 92093)	92093-1260	1
COLLAR,FORK,L=90 (Ref # 92143)	92143-1645	1
BOLT-FLANGED,8X45 (Ref # 130)	130G0845	1
BOLT-FLANGED,8X50 (Ref # 130A)	130G0850	1
SCREW-PAN-CROS (Ref # 220)	220B0416	1