

1989 KDX200 PARTS DIAGRAM

Clutch

E1350

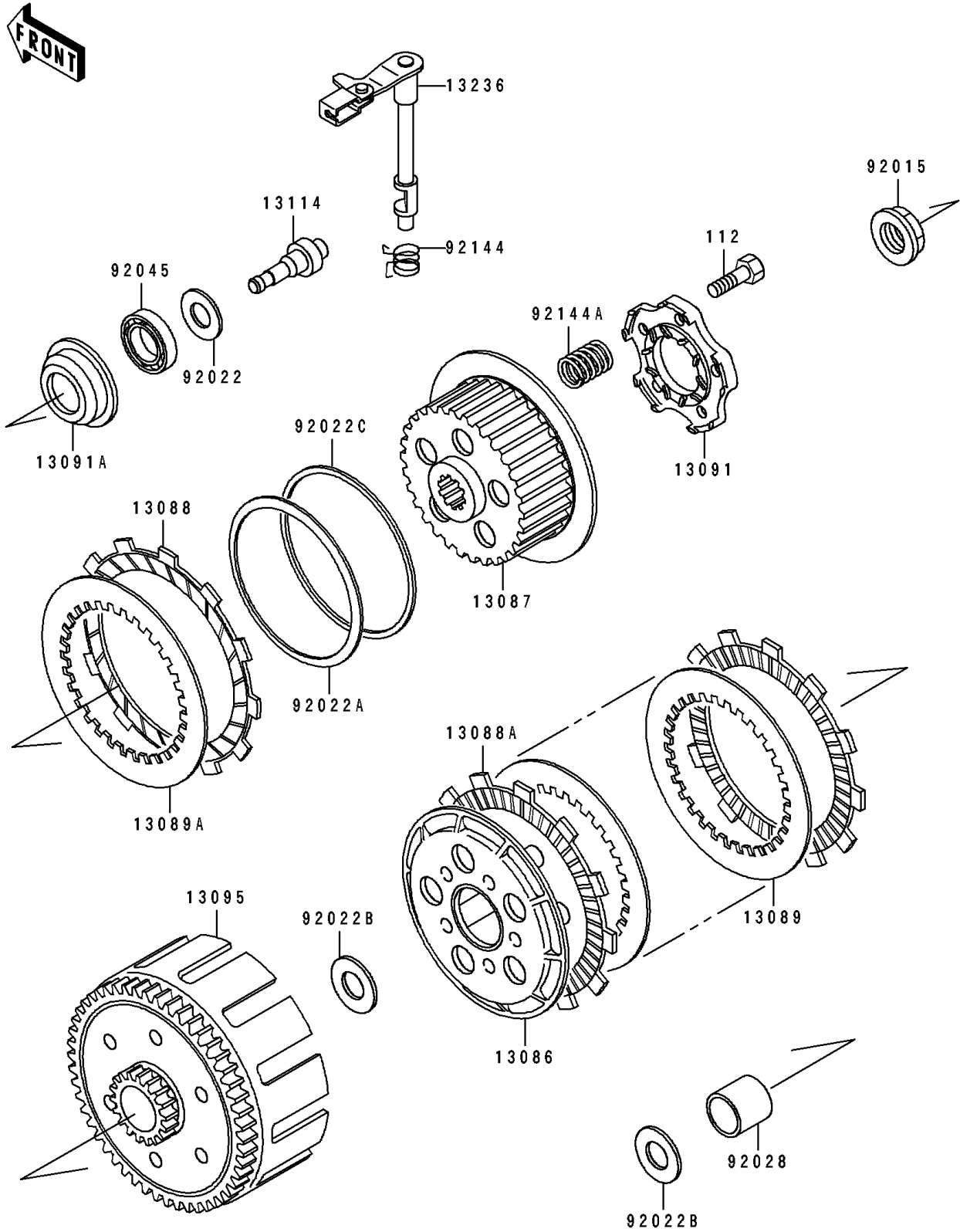

1989 KDX200 PARTS LIST

Clutch

ITEM NAME	PART NUMBER	QUANTITY
WHEEL-CLUTCH (Ref # 13086)	13086-1060	1
HUB-CLUTCH (Ref # 13087)	13087-1111	1
PLATE-FRICTION (Ref # 13088)	13088-1058	1
PLATE-FRICTION,ID=95 (Ref # 13088A)	13088-1081	1
PLATE-CLUTCH (Ref # 13089)	13089-1070	1
PLATE-CLUTCH (Ref # 13089A)	13089-1085	1
HOLDER,CLUTCH SPRING (Ref # 13091)	13091-1502	1
HOLDER,CLUTCH PUSHER (Ref # 13091A)	13091-1712	1
HOUSING-COMP-CLUTCH (Ref # 13095)	13095-1189	1
PUSHER-CLUTCH (Ref # 13114)	13114-1063	1
LEVER-COMP (Ref # 13236)	13236-1195	1
NUT (Ref # 92015)	92015-1581	1
WASHER,10.2X14.5X1.0 (Ref # 92022)	92022-1181	1
WASHER,JUDDER SPRING (Ref # 92022A)	92022-1974	1
WASHER,20.3X30X2.3 (Ref # 92022B)	92022-1979	1
WASHER,JUDDER SPRING SEAT (Ref # 92022C)	92022-1993	1
BUSHING,20X25X26.85 (Ref # 92028)	92028-1388	1
BEARING-BALL,6000M3ML01 (Ref # 92045)	92045-1225	1
SPRING,CLUTCH RELEASE (Ref # 92144)	92144-1287	1
SPRING,CLUTCH (Ref # 92144A)	92144-1403	1
BOLT-UPSET (Ref # 112)	112G0622	1