

# 2000 900 STX PARTS DIAGRAM

Pads

F3147

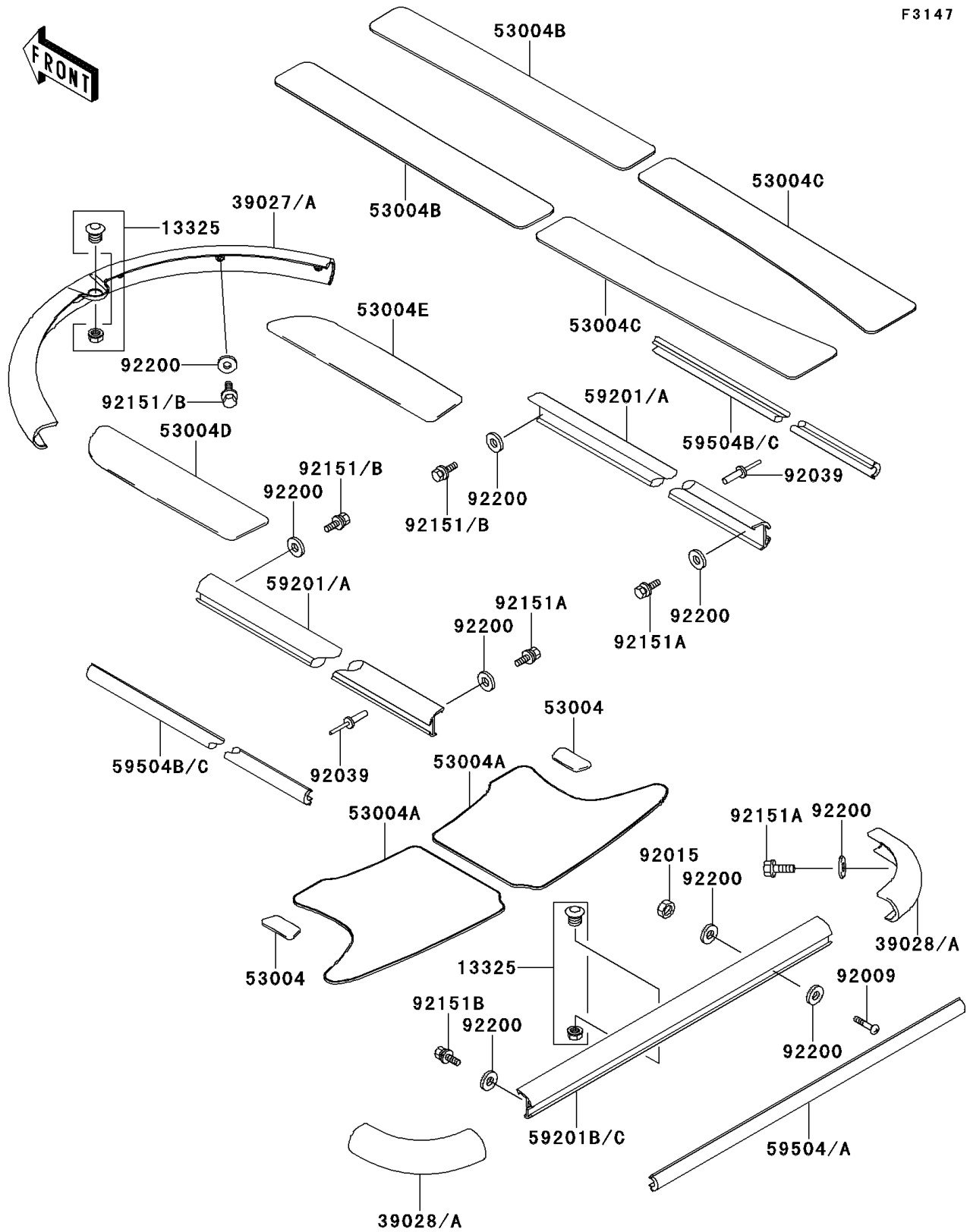

## 2000 900 STX PARTS LIST

### Pads

| ITEM NAME                                    | PART NUMBER   | QUANTITY |
|--|---------------|----------|
| BUSHING-ASSY,BLACK (Ref # 13325)             | 13325-3703    | 2        |
| BUMPER-FRONT,F.BLACK (Ref # 39027A)          | 39027-3735-6Z | 1        |
| BUMPER-REAR,CORNER,F.BLACK (Ref # 39028A)    | 39028-3748-6Z | 2        |
| MAT,FLOOR,RR,S.GRAY (Ref # 53004)            | 53004-3777-RG | 2        |
| MAT,DECK,RR,S.GRAY (Ref # 53004A)            | 53004-3778-RG | 2        |
| MAT,FLOOR,FR,S.GRAY (Ref # 53004B)           | 53004-3781-RG | 2        |
| MAT,FLOOR,RR,S,GRAY (Ref # 53004C)           | 53004-3782-RG | 2        |
| MAT,DECK,FR,LH,S.GRAY (Ref # 53004D)         | 53004-3783-RG | 1        |
| MAT,DECK,FR,RH,S.GRAY (Ref # 53004E)         | 53004-3784-RG | 1        |
| BUMPER,SIDE,F.BLACK (Ref # 59201A)           | 59201-3771-6Z | 2        |
| BUMPER,RR,F.BLACK (Ref # 59201C)             | 59201-3772-6Z | 1        |
| INSERT-BOAT FENDER,RR,F.BLACK (Ref # 59504A) | 59504-3716-6Z | 1        |
| INSERT-BOAT FENDER,SIDE,BLACK (Ref # 59504C) | 59504-3720-6Z | 2        |
| SCREW,5X30 (Ref # 92009)                     | 92009-3834    | 4        |
| NUT,LOCK,5MM (Ref # 92015)                   | 92015-3798    | 4        |
| RIVET (Ref # 92039)                          | 92039-3747    | 24       |
| BOLT,5X20 (Ref # 92151)                      | 92151-3717    | AR       |
| BOLT,5X20 (Ref # 92151A)                     | 92151-3717    | 4        |
| BOLT,5X25 (Ref # 92151B)                     | 92151-3718    | 8        |
| WASHER,5.9X16X1.5 (Ref # 92200)              | 92200-3714    | 20       |