

2000 900 STX PARTS DIAGRAM

Hull Fittings

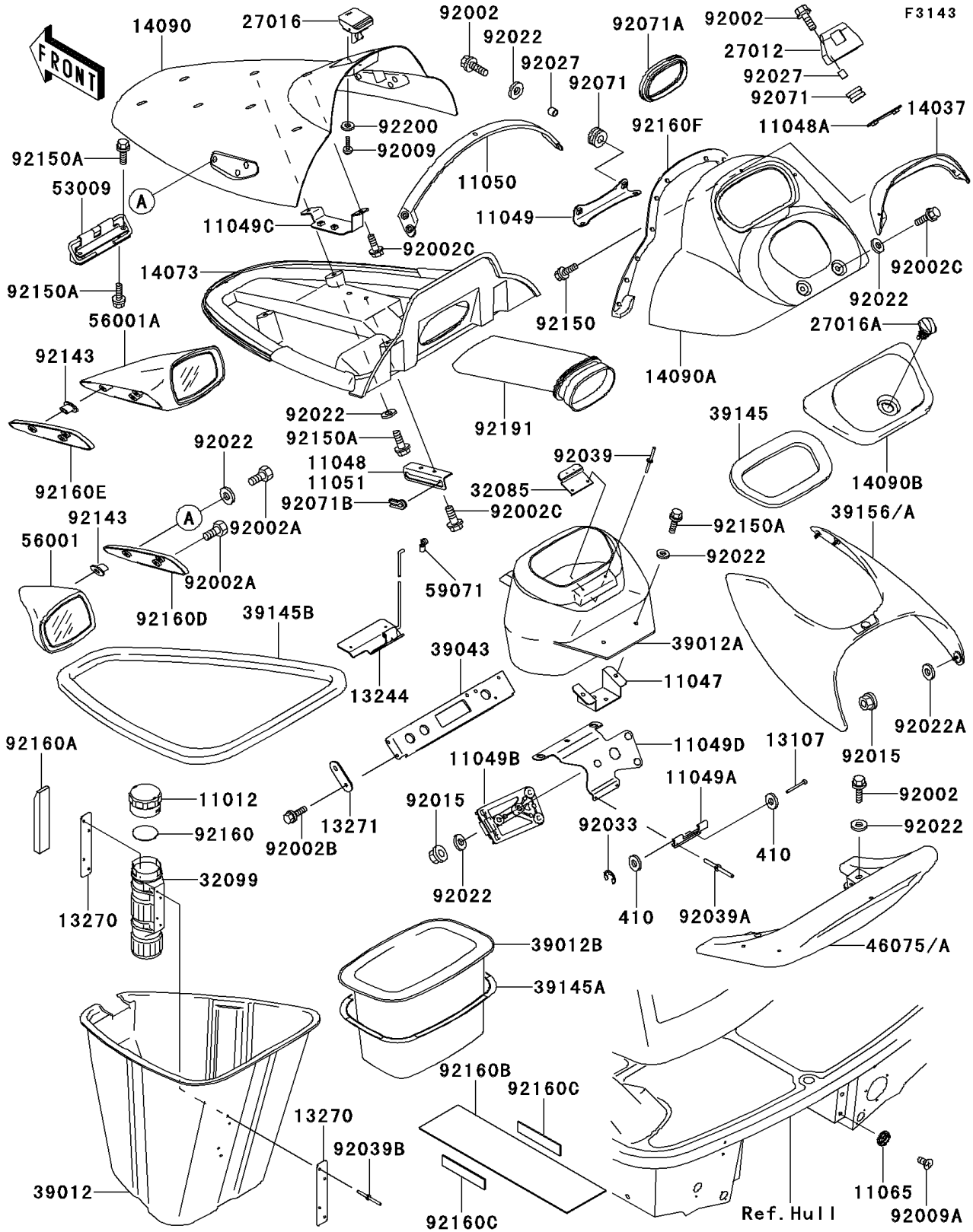

2000 900 STX PARTS LIST

Hull Fittings

ITEM NAME	PART NUMBER	QUANTITY
CAP,FIRE EXTINGUISHER (Ref # 11012)	11012-3766	1
BRACKET,FUEL FILTER (Ref # 11047)	11047-3761	1
BRACKET,HATCH COVER LOCK (Ref # 11048A)	11048-3778	1
BRACKET,HANDLE COVER (Ref # 11049)	11049-3716	1
BRACKET (Ref # 11049A)	11049-3717	1
BRACKET (Ref # 11049B)	11049-3718	1
BRACKET,HATCH COVER (Ref # 11049C)	11049-3736	1
BRACKET (Ref # 11049D)	11049-3743	1
BRACKET,HATCH COVER (Ref # 11050)	11050-3739	1
BRACKET,HATCH COVER (Ref # 11051)	11051-3725	1
CAP,STEP NUT (Ref # 11065)	11065-3712	4
SHAFT,3X32 (Ref # 13107)	13107-3745	2
STOPPER-ASSY,HATCH COVER (Ref # 13244)	13244-3701	1
PLATE,FIRE EXTINGUISHER (Ref # 13270)	13270-3729	2
PLATE (Ref # 13271)	13271-3738	2
SCREEN,METER,F.BLACK (Ref # 14037)	14037-3710-6Z	1
DUCT,FR (Ref # 14073)	14073-3758	1
COVER,HATCH,S.YELLOW (Ref # 14090)	14090-3769-7H	1
COVER,HANDLE,S.YELLOW (Ref # 14090A)	14090-3770-7H	1
COVER,CENTER STORAGE,S.YELLOW (Ref # 14090B)	14090-3771-7H	1
HOOK,HATCH COVER LOCK (Ref # 27012)	27012-3803	1
LOCK-ASSY,HATCH COVER (Ref # 27016)	27016-3737	1
LOCK-ASSY,STORAGE COVER (Ref # 27016A)	27016-3743	1
STOPPER,STORAGE LOCK (Ref # 32085)	32085-3726	1
CASE,FIRE EXTINGUISHER (Ref # 32099)	32099-3769	1
CASE-STORAGE,FR (Ref # 39012)	39012-3715	1
CASE-STORAGE,CNT (Ref # 39012A)	39012-3719	1
CASE-STORAGE,RR (Ref # 39012B)	39012-3720	1
CROSSMEMBER-COMP (Ref # 39043)	39043-3701	1

2000 900 STX PARTS LIST

Hull Fittings

ITEM NAME	PART NUMBER	QUANTITY
TRIM-SEAL (Ref # 39145)	39145-3754	1
TRIM-SEAL,STORAGE CASE (Ref # 39145A)	39145-3755	1
TRIM-SEAL,L=1380 (Ref # 39145B)	39145-3773	1
PAD,KNEE,F.SILVER (Ref # 39156)	39156-3811-MN	1
GRIP,TAIL,F.BLACK (Ref # 46075A)	46075-3745-6Z	1
HINGE,HATCH COVER (Ref # 53009)	53009-3725	1
MIRROR-ASSY,LH,S.YELLOW (Ref # 56001)	56001-3709-AU	1
MIRROR-ASSY,RH,S.YELLOW (Ref # 56001A)	56001-3710-AU	1
JOINT (Ref # 59071)	59071-3743	1
W-PLAIN-S,3MM (Ref # 410)	410S0300	4
BOLT,6X25 (Ref # 92002)	92002-3714	8
BOLT,6X40 (Ref # 92002A)	92002-3716	6
BOLT,6X20 (Ref # 92002B)	92002-3755	4
BOLT,6X12 (Ref # 92002C)	92002-3763	5
SCREW,5X16 (Ref # 92009)	92009-3789	2
SCREW,6X12 (Ref # 92009A)	92009-3852	4
NUT,6MM (Ref # 92015)	92015-3767	10
WASHER,6.5X20X1.5 (Ref # 92022)	92022-3710	17
WASHER,6.2X20X2 (Ref # 92022A)	92022-3714	7
COLLAR,6.2X10X10 (Ref # 92027)	92027-3705	4
RING-SNAP,2MM (Ref # 92033)	92033-3711	2
RIVET,4MM (Ref # 92039)	92039-3703	2
RIVET (Ref # 92039A)	92039-3748	2
RIVET (Ref # 92039B)	92039-3755	4
GROMMET (Ref # 92071)	92071-3716	4
GROMMET (Ref # 92071A)	92071-3812	1
GROMMET (Ref # 92071B)	92071-3816	1
COLLAR (Ref # 92143)	92143-3763	6
BOLT,5X14 (Ref # 92150)	92150-3702	3

2000 900 STX PARTS LIST

Hull Fittings

ITEM NAME	PART NUMBER	QUANTITY
BOLT,6X18 (Ref # 92150A)	92150-3729	8
DAMPER (Ref # 92160)	92160-3814	1
DAMPER (Ref # 92160A)	92160-3821	1
DAMPER (Ref # 92160B)	92160-3839	1
DAMPER (Ref # 92160C)	92160-3840	2
DAMPER,MIRROR,LH,F.BLACK (Ref # 92160D)	92160-3869-6Z	1
DAMPER,MIRROR,RH,F.BLACK (Ref # 92160E)	92160-3870-6Z	1
DAMPER,HANDLE COVER (Ref # 92160F)	92160-3897	1
TUBE (Ref # 92191)	92191-3867	1
WASHER,5.9X16X1.5 (Ref # 92200)	92200-3714	2