

# 2003 Prairie 360 4X4 Advantage Classic PARTS DIAGRAM

Front Bevel Gear

E3131

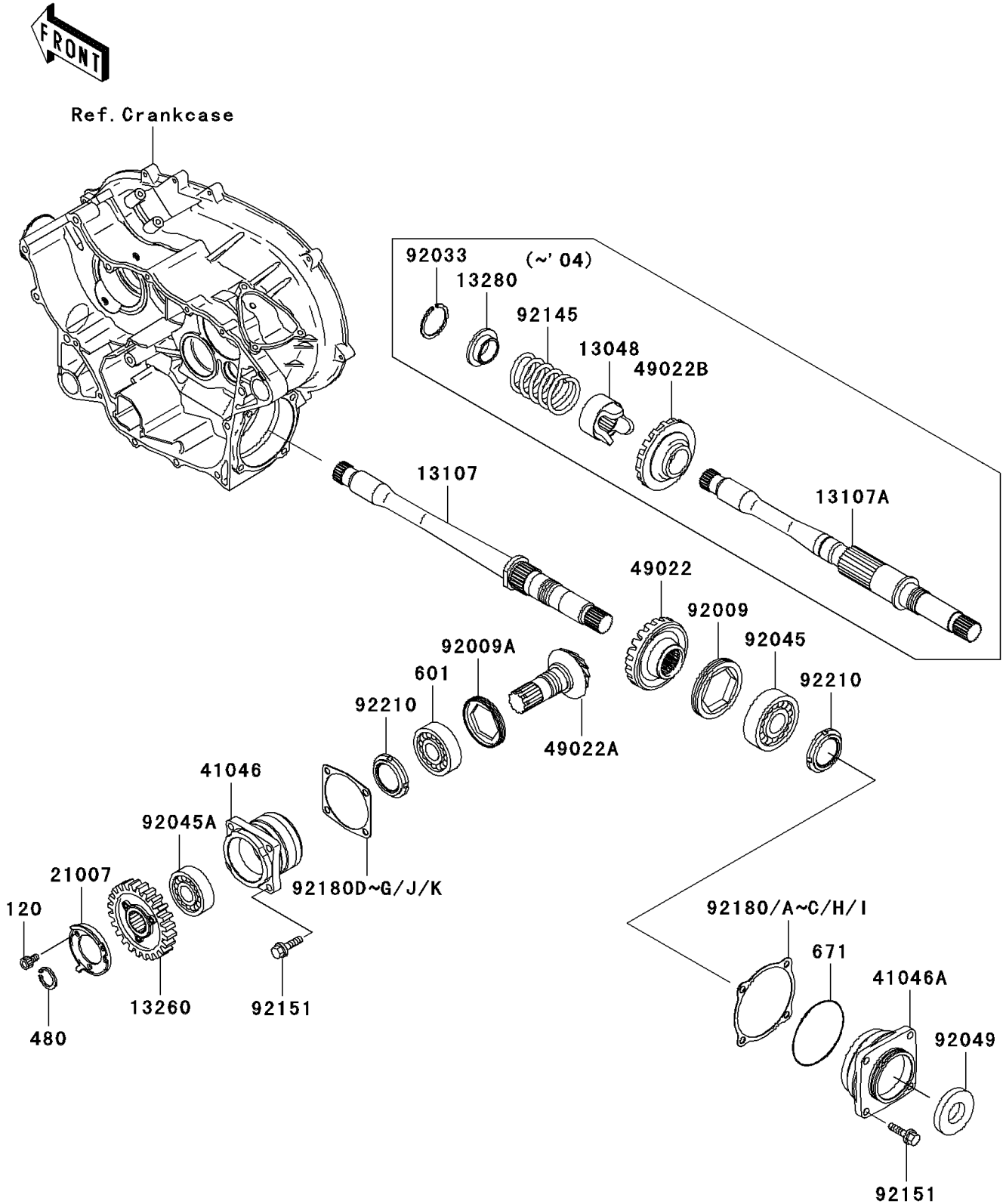

## 2003 Prairie 360 4X4 Advantage Classic PARTS LIST

### Front Bevel Gear

ITEM NAME	PART NUMBER	QUANTITY
BOLT-SOCKET,6X12 (Ref # 120)	120P0612	3
CIRCLIP-TYPE-C,28MM (Ref # 480)	480J2800	1
BEARING-BALL,#6206C3 (Ref # 601)	601B6206	1
O RING (Ref # 671)	671D2585	1
CAM-DAMPER (Ref # 13048)	13048-1088	1
SHAFT (Ref # 13107A)	13107-1438	1
GEAR,OUTPUT 29T (Ref # 13260)	13260-1922	1
HOLDER (Ref # 13280)	13280-1169	1
ROTOR,REVERSE SENSOR (Ref # 21007)	21007-1416	1
HOUSING-BEARING (Ref # 41046)	41046-1101	1
HOUSING-BEARING (Ref # 41046A)	41046-1102	1
GEAR-BEVEL,DRIVE,20T (Ref # 49022A)	49022-1184	1
GEAR-BEVEL,DRIVEN,20T (Ref # 49022B)	49022-1185	1
SCREW (Ref # 92009)	92009-1667	1
SCREW,64MM (Ref # 92009A)	92009-1914	1
RING-SNAP (Ref # 92033)	92033-1320	1
BEARING-BALL,6306SH2 (Ref # 92045)	92045-1190	1
BEARING-BALL,62/28 (Ref # 92045A)	92045-1207	1
SEAL-OIL (Ref # 92049)	92049-1529	1
SPRING (Ref # 92145)	92145-1298	1
BOLT (Ref # 92151)	92151-1688	8
SHIM,DRIVEN,T=0.15 (Ref # 92180)	92180-1307	1
SHIM,DRIVEN,T=0.20 (Ref # 92180A)	92180-1308	1
SHIM,DRIVEN,T=0.50 (Ref # 92180B)	92180-1309	1
SHIM,DRIVEN,T=0.80 (Ref # 92180C)	92180-1310	1
SHIM,DRIVE,T=0.15 (Ref # 92180D)	92180-1311	1
SHIM,DRIVE,T=0.20 (Ref # 92180E)	92180-1312	1
SHIM,DRIVE,T=0.50 (Ref # 92180F)	92180-1313	1
SHIM,DRIVE,T=0.80 (Ref # 92180G)	92180-1314	1

## 2003 Prairie 360 4X4 Advantage Classic PARTS LIST

### Front Bevel Gear

ITEM NAME	PART NUMBER	QUANTITY
SHIM,DRIVEN,T=1.00 (Ref # 92180H)	92180-1349	1
SHIM,DRIVEN,T=1.20 (Ref # 92180I)	92180-1350	1
SHIM,DRIVE,T=1.00 (Ref # 92180J)	92180-1351	1
SHIM,DRIVE,T=1.20 (Ref # 92180K)	92180-1352	1
NUT,30MM (Ref # 92210)	92210-1294	2