

# 1970 Bushwhacker PARTS DIAGRAM

## OIL PUMP

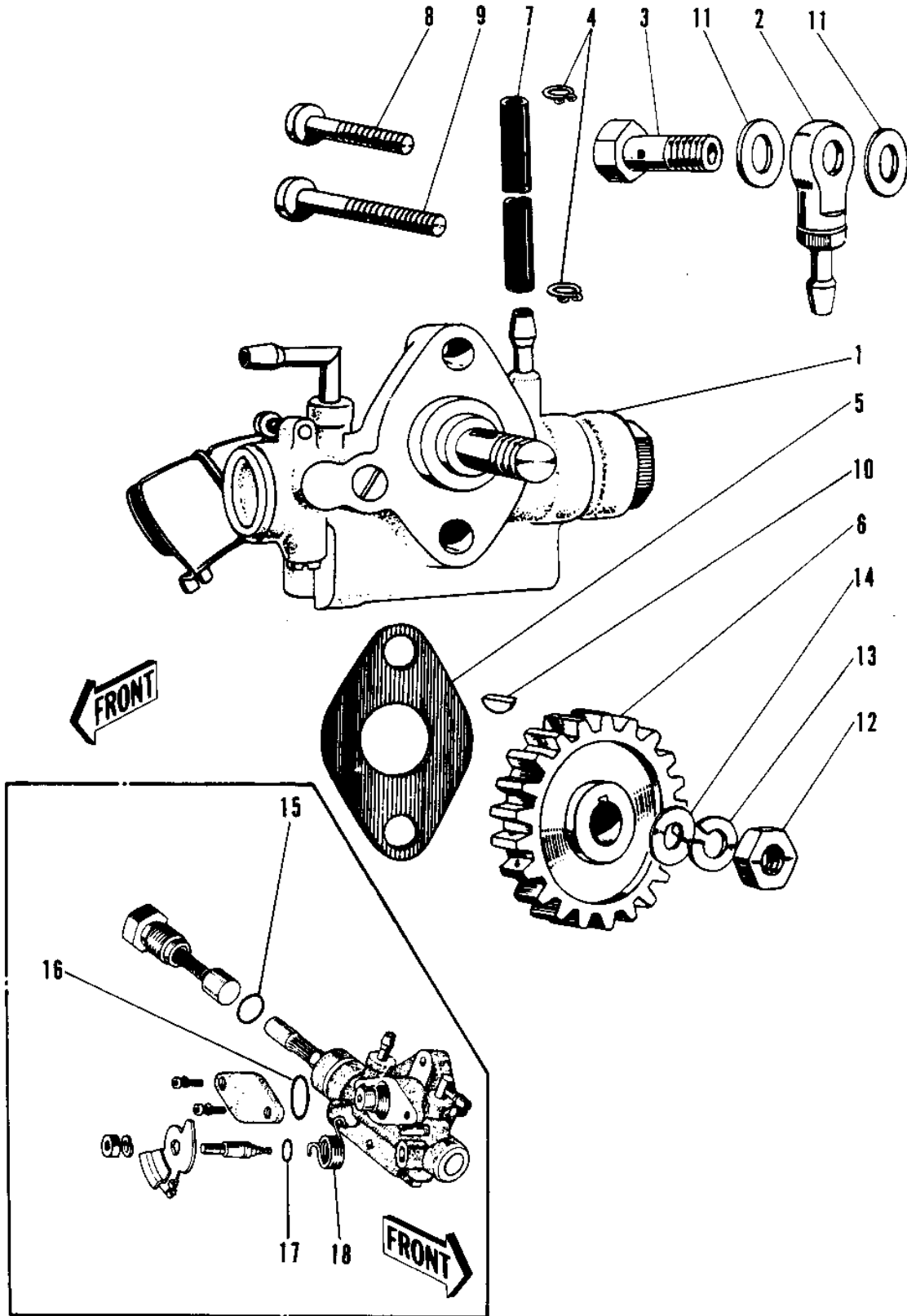

# 1970 Bushwhacker PARTS LIST

## OIL PUMP

| ITEM NAME                         | PART NUMBER | QUANTITY |
|-----------------------------------|-------------|----------|
| OIL PUMP ASSY (Ref # 1)           | 16082-010   |          |
| CHECK VALVE (Ref # 2)             | 16087-002   |          |
| BOLT BANJO 8X21 (Ref # 3)         | 92060-014   |          |
| BOLT BANJO 8X21 (Ref # 3)         | 92060-014   |          |
| CLAMP OIL PIPE (Ref # 4)          | 92037-019   |          |
| GASKET,OIL PUMP (Ref # 5)         | 11060-1160  |          |
| GEAR OIL PUMP (Ref # 6)           | 16085-003   |          |
| TUBE (Ref # 7)                    | 92059-074   |          |
| SCREW-PAN-CROS (Ref # 8)          | 220B0514    |          |
| SCREW, PAN HEAD, 5 X 28 (Ref # 9) | 220B0528A   |          |
| WOODRUFF KEY (Ref # 10)           | 510A2500    |          |
| GASKET 8MM (Ref # 11)             | 751P0800    |          |
| NUT,8MM (Ref # 12)                | 311B0800    |          |
| WASHER SPRING 8MM (Ref # 13)      | 461F0800    |          |
| WASHER SPRING 8MM (Ref # 13)      | 461F0800    |          |
| WASHER PLAIN 8MM (Ref # 14)       | 410B0800    |          |
| "O" RING,HOUSING (Ref # 15)       | 16088-001   |          |
| "O" RING,WORM GEAR (Ref # 16)     | 16090-001   |          |
| SEAL-OIL,CAMSHAFT,"X" (Ref # 17)  | 92049-1294  |          |
| SPRING OIL PUMP LEVER (Ref # 18)  | 16093-001   |          |