

1979 JS440 PARTS DIAGRAM

CARBURETOR ('79-'81 A3/A4/A4A/A5)

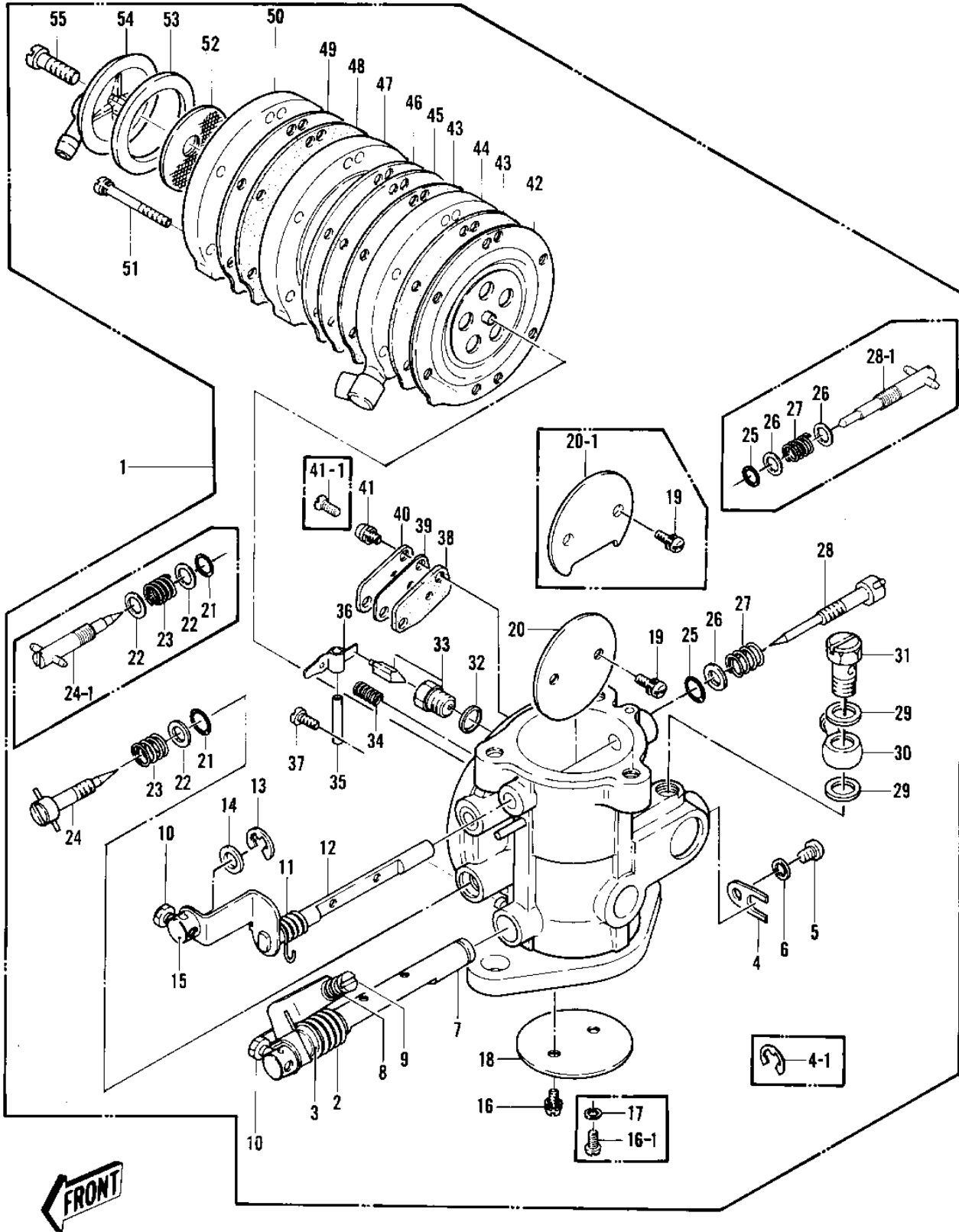

1979 JS440 PARTS LIST

CARBURETOR ('79-'81 A3/A4/A4A/A5)

ITEM NAME	PART NUMBER	QUANTITY
CARBURETOR (Ref # 1)	16001-3003-YR	1
CARBURETOR (Ref # 1)	16001-3003-YR	1
SPRING,THROTTLE SHAFT (Ref # 2)	92081-547	1
BUSHING,THRTLE SHAFT (Ref # 3)	92028-514	1
PLATE,THROTTLE SHAFT (Ref # 4)	59086-543	1
CIRCLIP,5M/M,SUS304 (Ref # 4-1)	92033-3004	1
SCREW PAN HEAD 4X6 (Ref # 5)	220B0406	1
WASHER SPRING 4MM (Ref # 6)	461F0400	1
THROTTLE SHAFT ASSY (Ref # 7)	59111-520	1
THROTTLE SHAFT ASSY (Ref # 7)	16041-3001	1
SPRING,CABLE PULLY (Ref # 8)	16040-022	1
SPRING,CABLE PULLY (Ref # 8)	16040-022	1
SCREW,4X20 (Ref # 9)	92009-3009	1
BOLT,4X8 (Ref # 10)	92001-3026	2
BOLT,4X8 (Ref # 10)	92001-3026	2
SPRING (Ref # 11)	92081-525	1
CHOKE SHAFT ASS'Y (Ref # 12)	59111-513	1
CIRCLIP,5M/M,SUS304 (Ref # 13)	92033-3004	1
WASHER,PLAIN,6NYLON (Ref # 14)	92022-3020	1
TERMINAL,CHOKE SHAFT (Ref # 15)	21169-3008	1
SCREW 3X7 (Ref # 16)	92011-516	2
SCREW-PAN-HEAD 3X6 (Ref # 16-1)	220B0306	2
WASHER SPRING 3MM (Ref # 17)	461F0300	2
VALVE,THROTTLE (Ref # 18)	16025-503	1
SCREW 3X5 (Ref # 19)	92011-517	2
VALVE,CHOKE (Ref # 20)	16126-3001	1
"O" RING (Ref # 21)	92055-510	1
WASHER (Ref # 22)	92022-537	1
WASHER (Ref # 22)	92022-537	2

1979 JS440 PARTS LIST

CARBURETOR ('79-'81 A3/A4/A4A/A5)

ITEM NAME	PART NUMBER	QUANTITY
SPRING (Ref # 23)	92081-528	1
SCREW,LOW SPEED (Ref # 24)	59271-506	1
SCREW,LOW SPEED (Ref # 24-1)	16009-3001	1
"O" RING,DRAIN PLUG (Ref # 25)	92055-1093	1
WASHER (Ref # 26)	92065-528	1
WASHER (Ref # 26)	92065-528	2
SPRING (Ref # 27)	92081-534	1
SCREW,HIGH SPEED (Ref # 28)	59271-507	1
SCREW,HIGH SPEED (Ref # 28-1)	16009-3002	1
GASKET-BANJO BOLT (Ref # 29)	92065-078	2
GASKET-BANJO BOLT (Ref # 29)	92065-078	2
BANJO-CARB (Ref # 30)	59071-505	1
BOLT,BANJO (Ref # 31)	92003-521	1
WASHER FLOAT VLV SEAT (Ref # 32)	16029-004	1
WASHER FLOAT VLV SEAT (Ref # 32)	16029-004	1
VALVE-SEAT (Ref # 33)	16030-503	1
SPRING (Ref # 34)	92081-536	1
FLOAT PIN (Ref # 35)	16032-006	1
FLOAT PIN (Ref # 35)	16032-006	1
ARM (Ref # 36)	59001-506	1
SCREW 3X7 (Ref # 37)	92011-516	1
GASKET (Ref # 38)	11060-3706	1
DIAPHRAGM,CHECK SEAT (Ref # 39)	51069-501	1
PLATE-CARB. SIDE (Ref # 40)	59086-541	1
SCREW 3X7 (Ref # 41)	92011-516	2
SCREW 3X7 (Ref # 41-1)	92011-516	2
DIAPHRAGM,MAIN (Ref # 42)	51069-502	1
GASKET (Ref # 43)	11060-3704	2
BODY,DIAPHRAGM(1) (Ref # 44)	59021-514	1