

1983 KE175 PARTS DIAGRAM

SEAT ('82-'83 KE175-D4/D5)

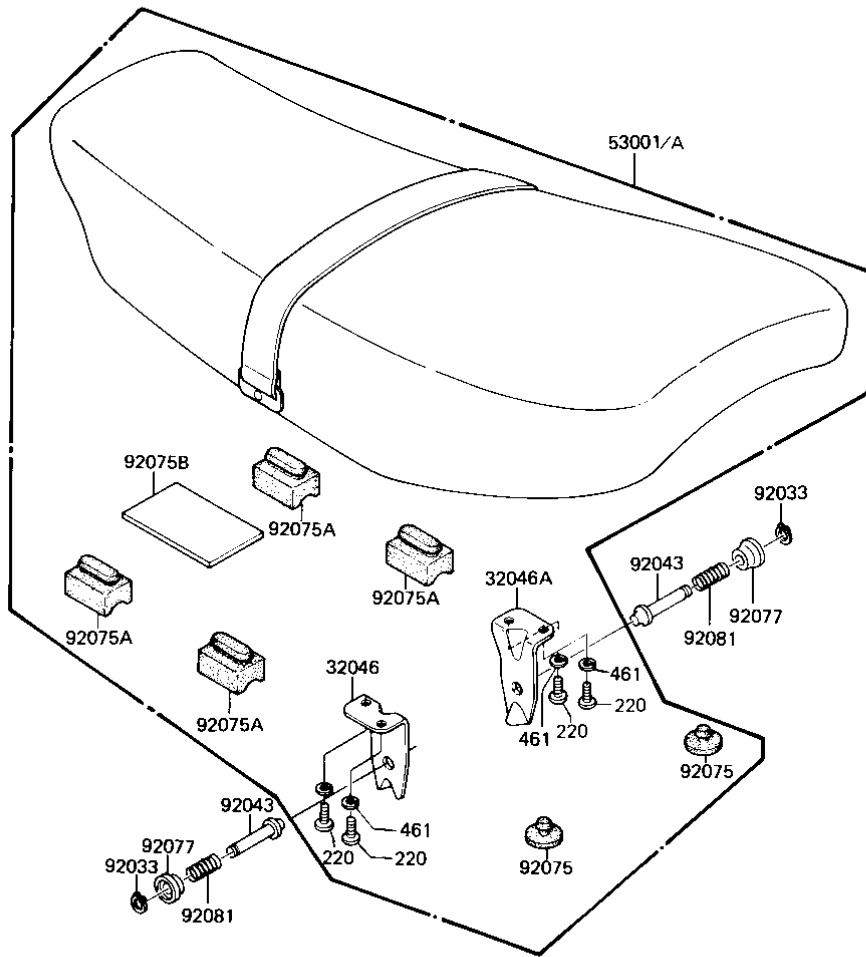

F2510-0148



1983 KE175 PARTS LIST

SEAT ('82-'83 KE175-D4/D5)

ITEM NAME	PART NUMBER	QUANTITY
BRACKET,SEAT CATCH,LH (Ref # 32046)	32046-1030	1
BRACKET,SEAT CATCH,RH (Ref # 32046A)	32046-1031	1
SEAT-ASSY,W/BAND (Ref # 53001A)	53001-1248	1
CIRCLIP,8M/M (Ref # 92033)	92033-1039	2
PIN,SEAT STOPPER (Ref # 92043)	92043-1036	2
DAMPER RUBBER (Ref # 92075)	92075-099	2
DAMPER RUBBER,SEAT (Ref # 92075A)	92075-216	4
DAMPER RUBBER,BATTERY (Ref # 92075B)	92075-224	1
KNOB,SEAT STOPPER (Ref # 92077)	92077-1007	2
SPRING,SEAT STOPPER (Ref # 92081)	92081-1135	2
SCREW PAN HEAD 6X14 (Ref # 220)	220B0614	4
WASHER SPRING 6MM (Ref # 461)	461F0600	4