

1982 KE175 PARTS DIAGRAM

TRANSMISSION ('82-'83 KE175-D4/D5)

E1361-0037

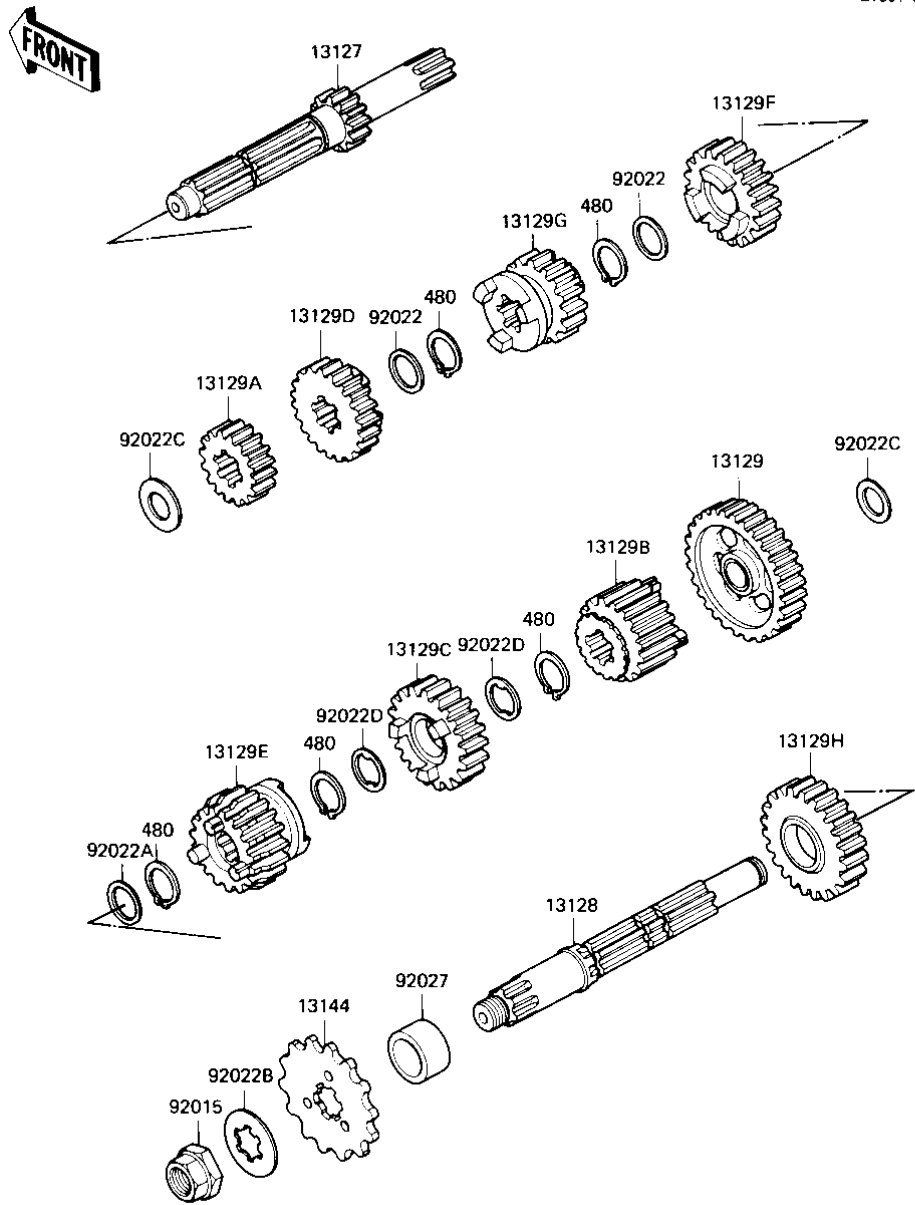

1982 KE175 PARTS LIST

TRANSMISSION ('82-'83 KE175-D4/D5)

ITEM NAME	PART NUMBER	QUANTITY
SHAFT,DRIVE,12T (Ref # 13127)	13127-1006	1
SHAFT,OUTPUT (Ref # 13128)	13128-1008	1
LOW GEAR,OUTPUT SHAFT (Ref # 13129)	13129-051	1
2ND GEAR,DRIVE,17T (Ref # 13129A)	13129-1075	1
TOP GEAR,DRIVEN,20T (Ref # 13129B)	13129-1134	1
3RD GEAR,DRIVEN,22T (Ref # 13129C)	13129-1142	1
4TH GEAR,DRIVE,20T (Ref # 13129D)	13129-1143	1
4TH GEAR,DRIVEN,19T (Ref # 13129E)	13129-1144	1
TOP GEAR,DRIVE,25T (Ref # 13129F)	13129-1145	1
3RD GEAR,DRIVE,18T (Ref # 13129G)	13129-1212	1
2ND GEAR OUTPUT 28T (Ref # 13129H)	13129-1278	1
SPROCKET-OUTPUT,14T (Ref # 13144)	13144-1058	1
NUT,14M/M (Ref # 92015)	92015-1062	1
WASHER 22MM (Ref # 92022)	92022-106	2
WASHER,22X28X2 (Ref # 92022A)	92022-1087	1
WASHER,SPLINE (Ref # 92022B)	92022-1113	1
WASHER-THRUST (Ref # 92022C)	92022-170	2
WASHER-LOCK (Ref # 92022D)	92024-031	2
COLLAR,20X30X15 (Ref # 92027)	92027-1083	1
CIRCRIP TYPE-C,21MM (Ref # 480)	480J2100	5