

# 1980 KE175 PARTS DIAGRAM

CABLES ('80-'81 KE175-D2/D3)

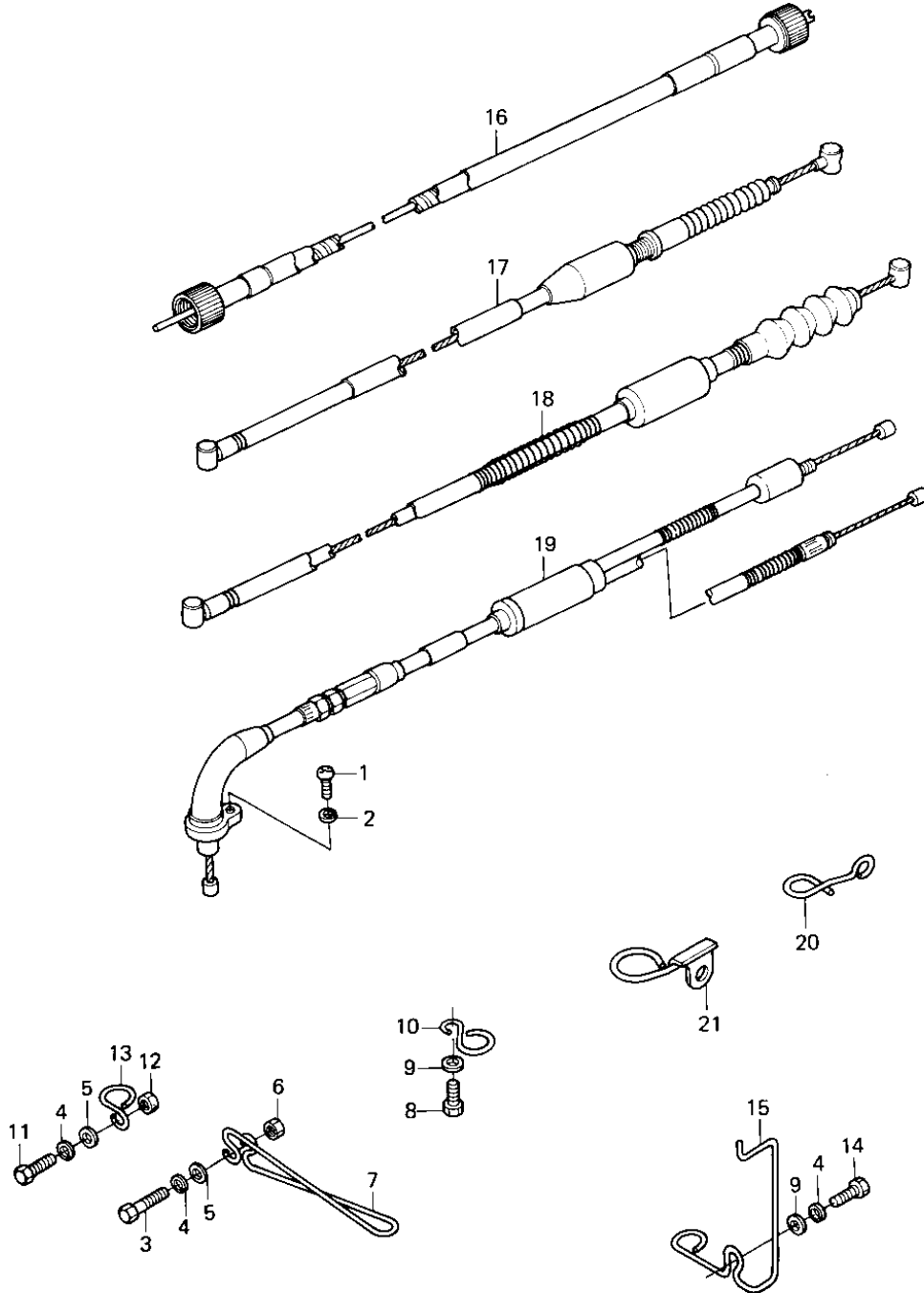

# 1980 KE175 PARTS LIST

## CABLES ('80-'81 KE175-D2/D3)

ITEM NAME	PART NUMBER	QUANTITY
SCREW PAN HEAD 5X10 (Ref # 1)	220B0510	1
WASHER SPRING 5MM (Ref # 2)	461F0500	1
BOLT-UPSET (Ref # 3)	112G0625	1
WASHER SPRING 6MM (Ref # 4)	461F0600	3
WASHER PLAIN 6MM (Ref # 5)	410B0600	2
NUT 6MM (Ref # 6)	311B0600	1
CLAMP,CABLE (Ref # 7)	92037-1014	1
BOLT-UPSET,6X12 (Ref # 8)	112G0612	1
WASHER PLAIN 6MM (Ref # 9)	411B0600	2
CLAMP,CABLE (Ref # 10)	92037-1034	1
BOLT-UPSET (Ref # 11)	112G0618	1
NUT 6MM (Ref # 12)	311B0600	1
CLAMP,CABLE (Ref # 13)	92037-1033	1
BOLT-UPSET,6X12 (Ref # 14)	112G0612	1
CLAMP (Ref # 15)	92037-1084	1
CABLE,SPEEDOMETER (Ref # 16)	54001-1011	1
CABLE,FRONT BRAKE (Ref # 17)	54005-1014	1
CABLE-BRAKE (Ref # 17)	54005-1030	1
CABLE-CLUTCH (Ref # 18)	54011-1063	1
CABLE,THROTTLE CONTRL (Ref # 19)	54012-1023	1
CLAMP,CABLE (Ref # 20)	92037-1016	1
CLAMP,CABLE (Ref # 21)	92037-1015	1