

# 1981 GPz PARTS DIAGRAM

SEAT/SEAT COVER

F2510-0044

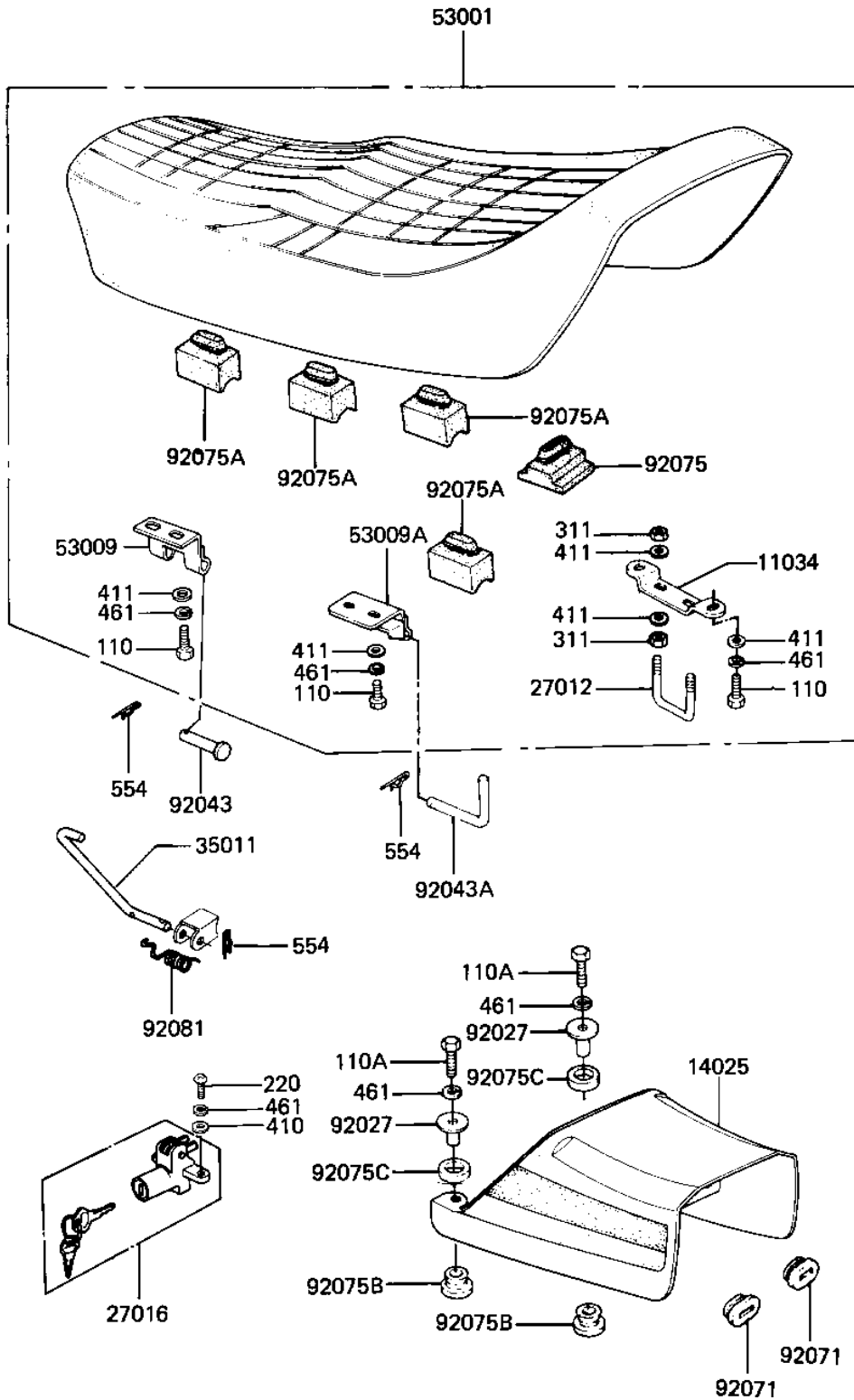

# 1981 GPz PARTS LIST

## SEAT/SEAT COVER

ITEM NAME	PART NUMBER	QUANTITY
BRACKET, SEAT CATCH (Ref # 11034)	53058-001	1
COVER,SEAT,F.RED (Ref # 14025)	14025-5038-B1	1
CATCH, SEAT (Ref # 27012)	53056-002	1
LOCK-ASSY,SEAT (Ref # 27016)	27016-5010	1
HOOK SEAT (Ref # 35011)	53054-001	1
SEAT-ASSY,DUAL (Ref # 53001)	53001-1145	1
HINGE,BLACK (Ref # 53009)	53009-017-10	1
HINGE,SEAT,FRONT (Ref # 53009A)	53009-1010	1
COLLAR (Ref # 92027)	92027-251	2
PIN (Ref # 92043)	53011-002	1
PIN,DUAL SEAT PIVOT (Ref # 92043A)	53011-008	1
GROMMET,SIDE COVER (Ref # 92071)	92071-072	2
DAMPER RUBBER,SEAT (Ref # 92075)	92075-1061	1
DAMPER RUBBER-SEAT (Ref # 92075A)	92075-156	4
RUBBER,FENDER COVER (Ref # 92075B)	92075-174	2
DAMPER RUBBER (Ref # 92075C)	92075-175	2
SPRING,SEAT HOOK (Ref # 92081)	92081-1053	1
BOLT-UPSET 6X14 (Ref # 110)	112B0614	6
BOLT 6X22 (Ref # 110A)	112B0622	2
SCREW PAN HEAD 6X14 (Ref # 220)	220B0614	1
NUT 6MM (Ref # 311)	311B0600	4
WASHER PLAIN 6MM (Ref # 410)	410B0600	1
WASHER PLAIN 6MM (Ref # 411)	411B0600	10
WASHER SPRING 6MM (Ref # 461)	461F0600	9
PIN,SNAP (Ref # 554)	554A0600	3