

## 1980 KZ1300-A2 PARTS DIAGRAM

SEAT/SEAT COVER

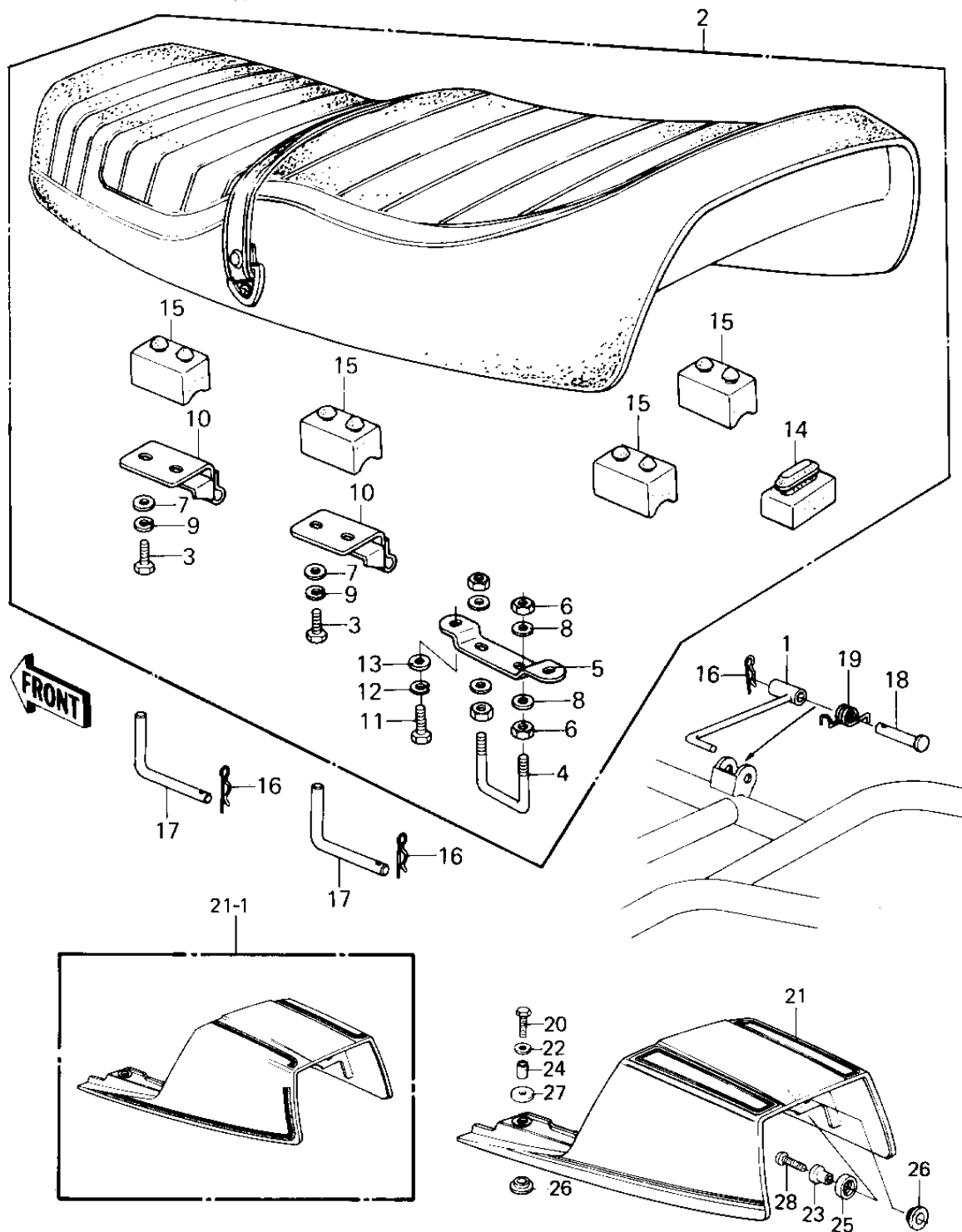

## 1980 KZ1300-A2 PARTS LIST

### SEAT/SEAT COVER

ITEM NAME	PART NUMBER	QUANTITY
STAY,SEAT STAND (Ref # 1)	35011-1018	1
DESC-SEAT-ASSY,DUAL (Ref # 2)	53001-1358	2
BOLT-UPSET 6X14 (Ref # 3)	112B0614	2
CATCH, SEAT (Ref # 4)	53056-002	1
BRACKET, SEAT CATCH (Ref # 5)	53058-001	1
NUT 6MM (Ref # 6)	311B0600	1
WASHER PLAIN 6MM (Ref # 7)	411B0600	3
WASHER SPRING 6MM (Ref # 9)	461F0600	2
HINGE,SEAT (Ref # 10)	53009-1011	1
DAMPER RUBBER (Ref # 14)	92075-099	1
DAMPER RUBBER,SEAT (Ref # 15)	92075-139	1
COTTER PIN (Ref # 16)	92041-003	1
PIN,SNAP (Ref # 16)	554A0600	1
PIN,SEAT PIVOT (Ref # 17)	92043-1021	1
PIN,SEAT STAND (Ref # 18)	92043-1045	1
SPRING,SEAT STAND (Ref # 19)	92081-1100	1
BOLT 6X22 (Ref # 20)	112B0622	1
COVER,SEAT,L.S.BLUE (Ref # 21)	14025-1064-C1	1
COVER,SEAT,EBONY (Ref # 21-1)	14025-1064-8G	1
WASHER,PLAIN,7MM (Ref # 22)	92022-228	1
COLLAR,SEAT COVER (Ref # 23)	92027-1122	1
COLLAR (Ref # 24)	92027-241	1
DAMPER,SEAT COVER FIT (Ref # 25)	92075-1097	1
RUBBER,FENDER COVER (Ref # 26)	92075-174	1
DAMPER RUBBER (Ref # 27)	92075-175	1
SCREW PAN HEAD 6X25 (Ref # 28)	220B0625	1