

1979 KZ1000 LTD PARTS DIAGRAM

REAR MASTER CYLINDER/BRAKE PEDAL (KZ1000)

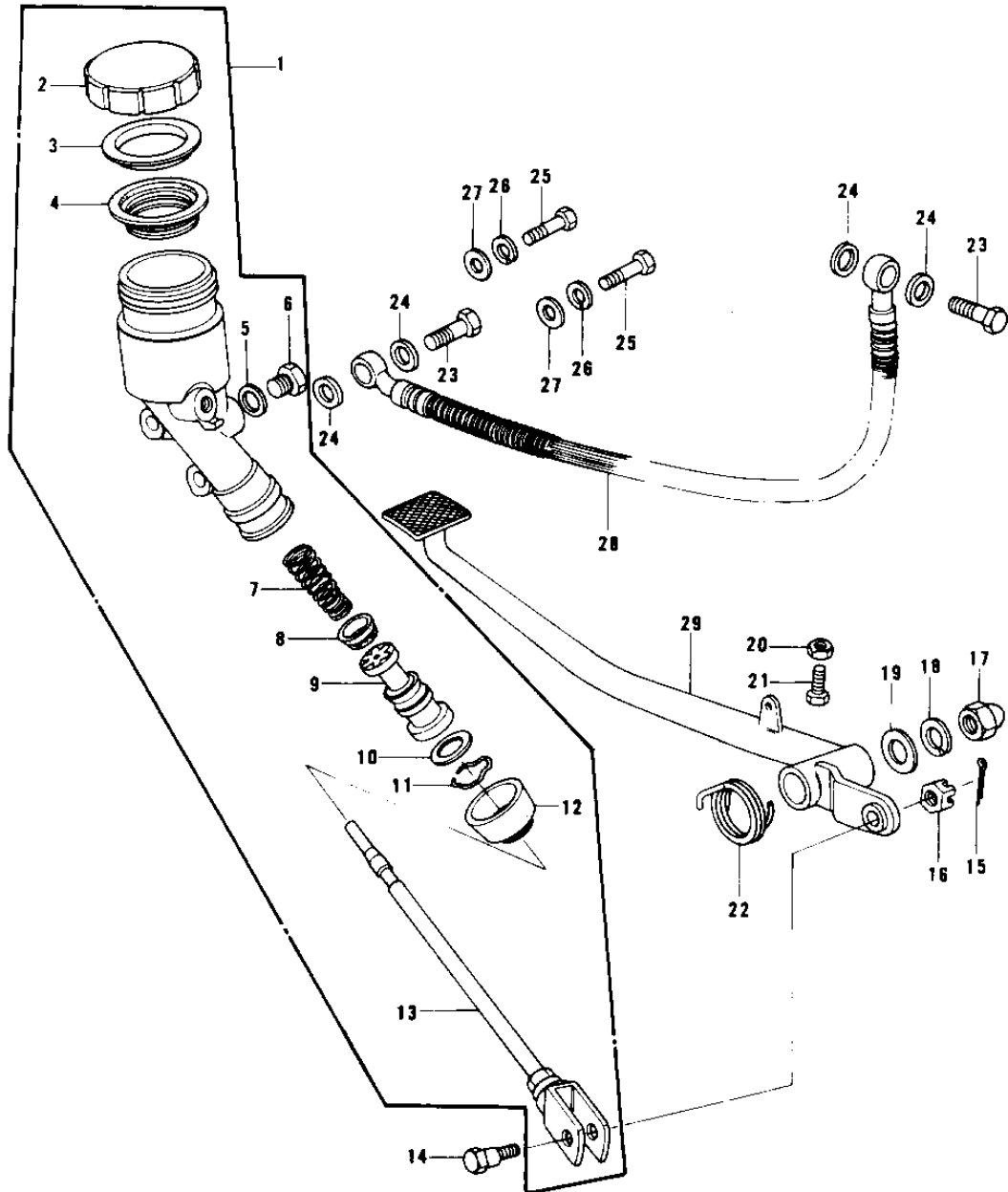

1979 KZ1000 LTD PARTS LIST

REAR MASTER CYLINDER/BRAKE PEDAL (KZ1000)

| ITEM NAME | PART NUMBER | QUANTITY |
|---------------------------------|-------------|----------|
| CYLINDER ASSY,PR MAST (Ref # 1) | 43015-1029 | 1 |
| CAP,OIL CUP (Ref # 2) | 43026-004 | 1 |
| PLATE-MASTER CYLINDER (Ref # 3) | 43027-001 | 1 |
| DIAPHRAGM (Ref # 4) | 43028-003 | 1 |
| 'O'RING (Ref # 5) | 43079-002 | 1 |
| BOLT (Ref # 6) | 43070-003 | 1 |
| SPRING ASSY, RETURN (Ref # 7) | 43018-002 | 1 |
| CUP, PRIMARY (Ref # 8) | 43019-002 | 1 |
| PISTON ASSY (Ref # 9) | 43072-004 | 1 |
| STOPPER,PISTON (Ref # 10) | 43022-002 | 1 |
| RING,DUST SEAL (Ref # 11) | 43058-004 | 1 |
| DUST COVER (Ref # 12) | 43024-003 | 1 |
| ROD,BRAKE (Ref # 13) | 43010-021 | 1 |
| BOLT (Ref # 14) | 92003-198 | 1 |
| PIN COTTER 2.0X20 (Ref # 15) | 550D2020 | 1 |
| NUT CASTLE (Ref # 16) | 321B0800 | 1 |
| NUT,CAP AND LOCK,8MM (Ref # 17) | 92019-013 | 1 |
| WASHER SPRING 8MM (Ref # 18) | 461F0800 | 1 |
| WASHER,8.5X20X1.6 (Ref # 19) | 92022-1561 | 1 |
| NUT 6MM (Ref # 20) | 311B0600 | 1 |
| BOLT-UPSET,6X20 (Ref # 21) | 112G0620 | 1 |
| SPRING,BRAKE PEDAL (Ref # 22) | 43005-041 | 1 |
| BOLT,OIL,L=23 (Ref # 23) | 92002-1888 | 2 |
| WASHER-OIL BOLT (Ref # 24) | 43067-001 | 4 |
| BOLT,10X45 (Ref # 25) | 92001-1182 | 2 |
| WASHER SPRING 8MM (Ref # 26) | 461F0800 | 2 |
| WASHER PLAIN 8MM (Ref # 27) | 410B0800 | 2 |
| HOSE,REAR MASTER CYL (Ref # 28) | 43059-031 | 1 |
| PEDAL,BRAKE (Ref # 29) | 43001-1030 | 1 |