

1977 KZ750-B2 PARTS DIAGRAM

CLUTCH

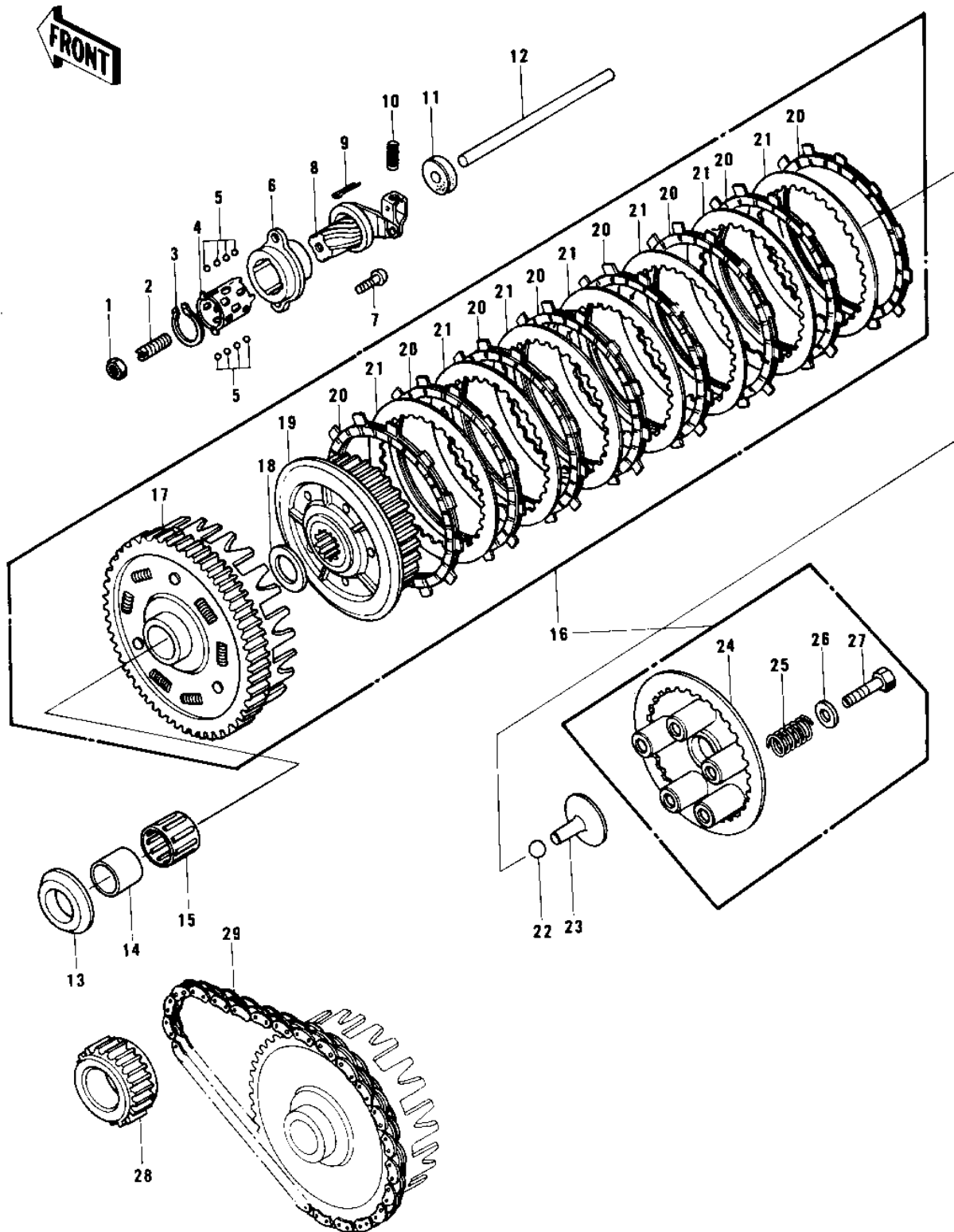

F
—

1977 KZ750-B2 PARTS LIST

CLUTCH

ITEM NAME	PART NUMBER	QUANTITY
NUT 8MM (Ref # 1)	318B0800	1
SCREW,SLOTTED,8X25 (Ref # 2)	92014-014	1
CIRCLIP 15MM (Ref # 3)	480J1500	1
RETAINER (Ref # 4)	13197-004	1
BALL,STEEL,1/8" (Ref # 5)	600A0400	1
OUTER,CLUTCH RELEASE (Ref # 6)	13118-011	1
SCREW PAN HEAD 6X16 (Ref # 7)	220B0616	1
INNER,CLUTCH RELEASE (Ref # 8)	13102-019	1
PIN COTTER 1.6X15 (Ref # 9)	550D1615	1
UNAVAILABLE IN PRICE BOOK (Ref # 10)	92081-1069	1
OIL SEAL,TC7187 (Ref # 11)	92050-048	1
ROD,CLUTCH PUSH (Ref # 12)	13116-035	2
SPACER (Ref # 13)	92026-123	5
BUSHING,CLUTCH (Ref # 14)	92028-178	1
BEARING,KTV323723 (Ref # 15)	92046-028	1
CLUTCH-ASSY (Ref # 16)	13081-1006	2
HOUSING,CLUTCH (Ref # 17)	13095-050	1
WASHER TH 25.5X47X2.5 (Ref # 18)	92026-022	1
HUB,CLUTCH (Ref # 19)	13087-042	1
PLATE,CLUTCH FRICTION (Ref # 20)	13088-040	1
PLATE,CLUTCH STEL (Ref # 21)	13089-027	1
BALL STEEL 3/8" (Ref # 22)	600A1200	1
PUSHER,CLUTCH SPRG PL (Ref # 23)	13116-022	1
PLATE,CLUTCH SPRING (Ref # 24)	13187-008	1
SPRING,CLUTCH (Ref # 25)	92081-1033	2
HOLDER,CLUTCH SPRING (Ref # 26)	13091-011	1
BOLT-UPSET (Ref # 27)	112G0618	1
BOLT,CLUTCH SPR FITT (Ref # 27)	92001-1066	1
GEAR,PRIMARY (Ref # 28)	13121-034	1

1977 KZ750-B2 PARTS LIST

CLUTCH

ITEM NAME	PART NUMBER	QUANTITY
CHAIN,PRIMARY (Ref # 29)	13122-008	1