

# 1972 Mach IV PARTS DIAGRAM

CRANKSHAFT/PISTONS

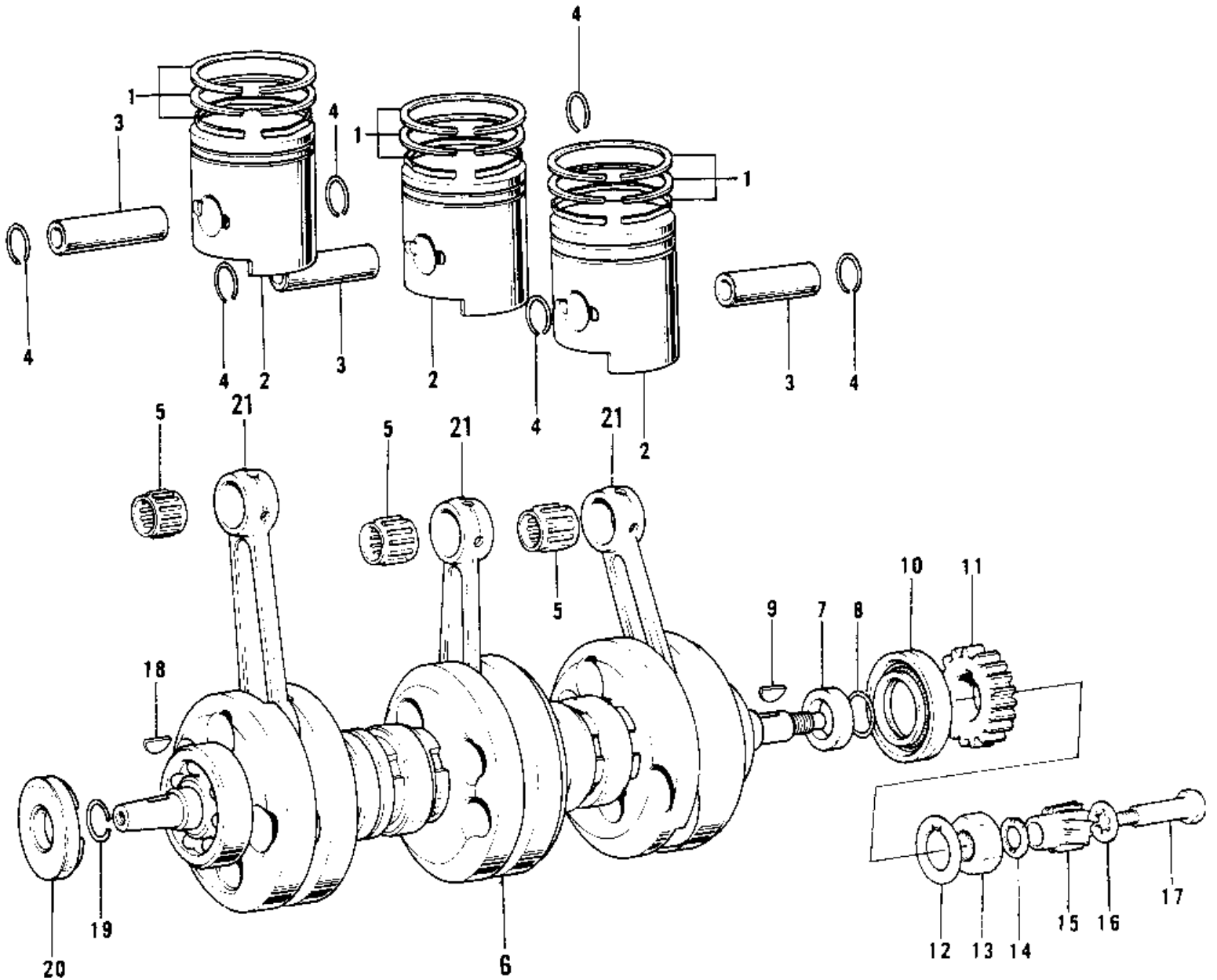

# 1972 Mach IV PARTS LIST

## CRANKSHAFT/PISTONS

ITEM NAME	PART NUMBER	QUANTITY
RING SET-STD (Ref # 1)	13008-042	3
RING SET,0.020" O.S (Ref # 1)	13025-045	(3
RING SET.0.040" O.S (Ref # 1)	13024-049	(3
PISTON,STD (Ref # 2)	13001-050	3
PISTON,0.020" O.S (Ref # 2)	13029-051	(3
PISTON,0.040" O.S (Ref # 2)	13027-049	(3
PIN-PISTON (Ref # 3)	13002-020	3
CIRCLIP PISTON PIN (Ref # 4)	92036-004	6
BRG-N,71KTV012 (Ref # 5)	13033-027	3
CRANK&CONROD ASSY (Ref # 6)	13031-050	NA
CRANK&CONROD ASSY (Ref # 6)	13031-050	1
COLLAR-R.H CRNK SHFT (Ref # 7)	92027-133	1
"O" RING,24MM (Ref # 8)	670B3024	1
WOODRUFF KEY (Ref # 9)	510A5100	1
OIL SEAL,TCY36729 (Ref # 10)	92050-054	1
PINION-PRIMARY (Ref # 11)	13121-020	1
WASHER-LOCK,20MM (Ref # 12)	420B2014	1
NUT,20MM (Ref # 13)	92016-043	1
WASHER-LOCK (Ref # 14)	92024-032	1
PINION OIL PUMP (Ref # 15)	16084-010	1
WASHER LOCK 6MM (Ref # 16)	463H0600	1
BOLT OIL PUMP PINION (Ref # 17)	92001-060	1
WOODRUFF KEY (Ref # 18)	92038-001	1
CIRCLIP (Ref # 19)	92036-019	1
SEAL-OIL (Ref # 20)	92050-053	1
CONNECTING ROD SET (Ref # 21)	13044-035	AR