

1968 W1SS PARTS DIAGRAM

MUFFLERS (W1)

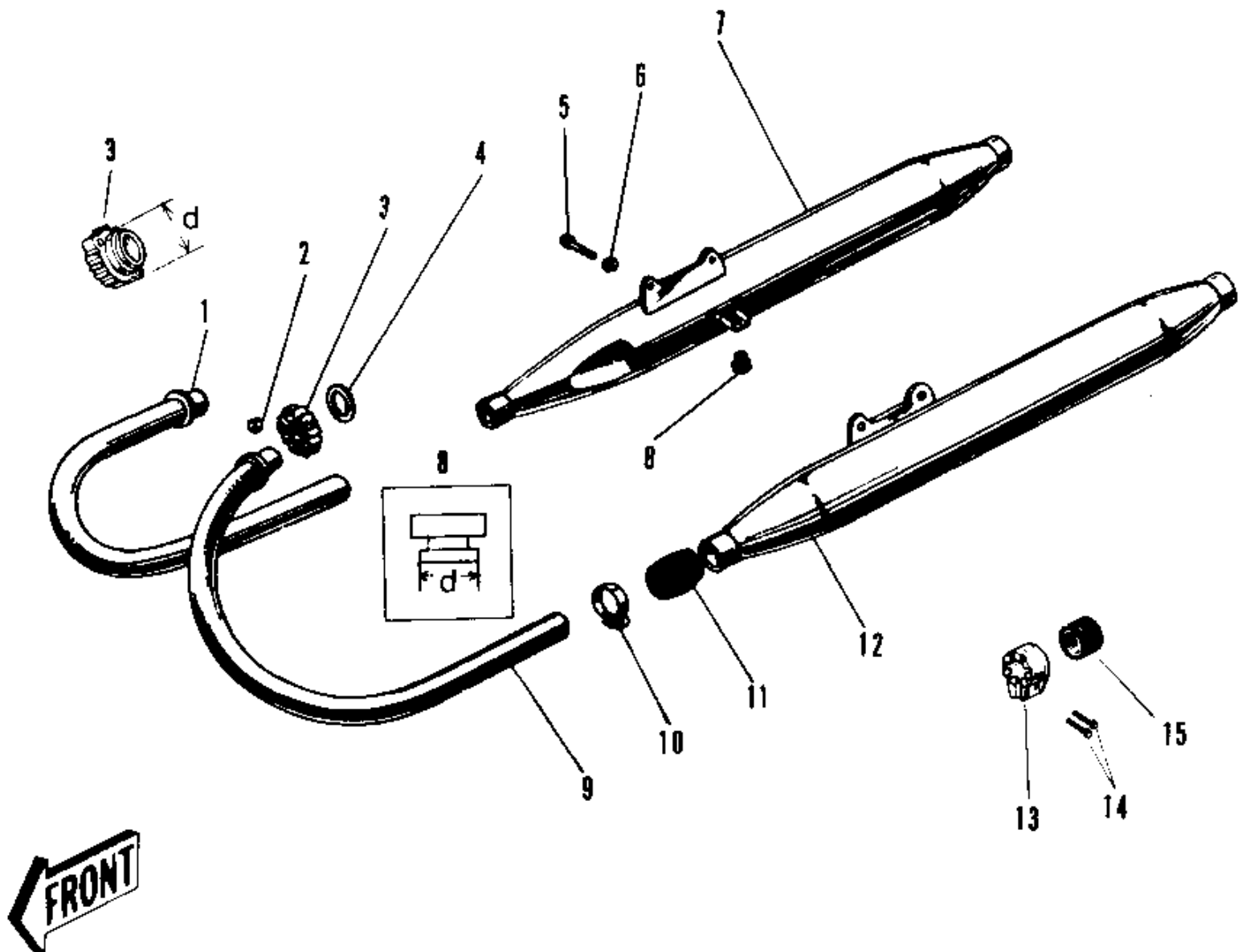

1968 W1SS PARTS LIST

MUFFLERS (W1)

| ITEM NAME | PART NUMBER | QUANTITY |
|-------------------------------------|--------------|----------|
| UNAVAILABLE IN PRICE BOOK (Ref # 1) | 18049-036 | 1 |
| PIPE-EXHAUST,R.H (Ref # 1) | 18049-073 | 1 |
| UNAVAILABLE IN PRICE BOOK (Ref # 2) | 92015-012 | 1 |
| CLAMP EXHAUST PIPE (Ref # 3) | 18069-009 | 1 |
| UNAVAILABLE IN PRICE BOOK (Ref # 3) | 18069-018 | 1 |
| JOINT EXHAUST PIPE (Ref # 3) | 18069-019 | 1 |
| GASKET,EXHAUST PIPE H (Ref # 4) | 11009-1840 | 1 |
| BOLT-SMALL-UPSET,8X18 (Ref # 5) | 115G0818 | 1 |
| WASHER SPRING 8MM (Ref # 6) | 461F0800 | 1 |
| UNAVAILABLE IN PRICE BOOK (Ref # 7) | 18003-010 | 1 |
| MUFFLER ASSY R.H (Ref # 7) | 18003-027 | 1 |
| UNAVAILABLE IN PRICE BOOK (Ref # 8) | 18055-001 | 1 |
| RUBBER-MAIN STAND ST (Ref # 8) | 18055-002 | 1 |
| DAMPER RUBB MAIN STAD (Ref # 8) | 92075-015 | 1 |
| UNAVAILABLE IN PRICE BOOK (Ref # 9) | 18049-035 | 1 |
| PIPE-EXHAUST,L.H (Ref # 9) | 18049-072 | 1 |
| CLAMP MUFFLER CONNECT (Ref # 10) | 92037-006 | 1 |
| CONNECTOR MUFFLER (Ref # 11) | 18043-002 | 1 |
| MUFFLER ASSY L.H (Ref # 12) | 18002-029 | 1 |
| HOLDER-MFLR CONECT,CR (Ref # 13) | 18044-004-79 | 1 |
| SCREW PAN HEAD 6X25 (Ref # 14) | 220B0625 | 1 |
| CONNECTOR MUFFLER (Ref # 15) | 18043-008 | 1 |