

1978 Custom PARTS DIAGRAM

TRANSMISSION

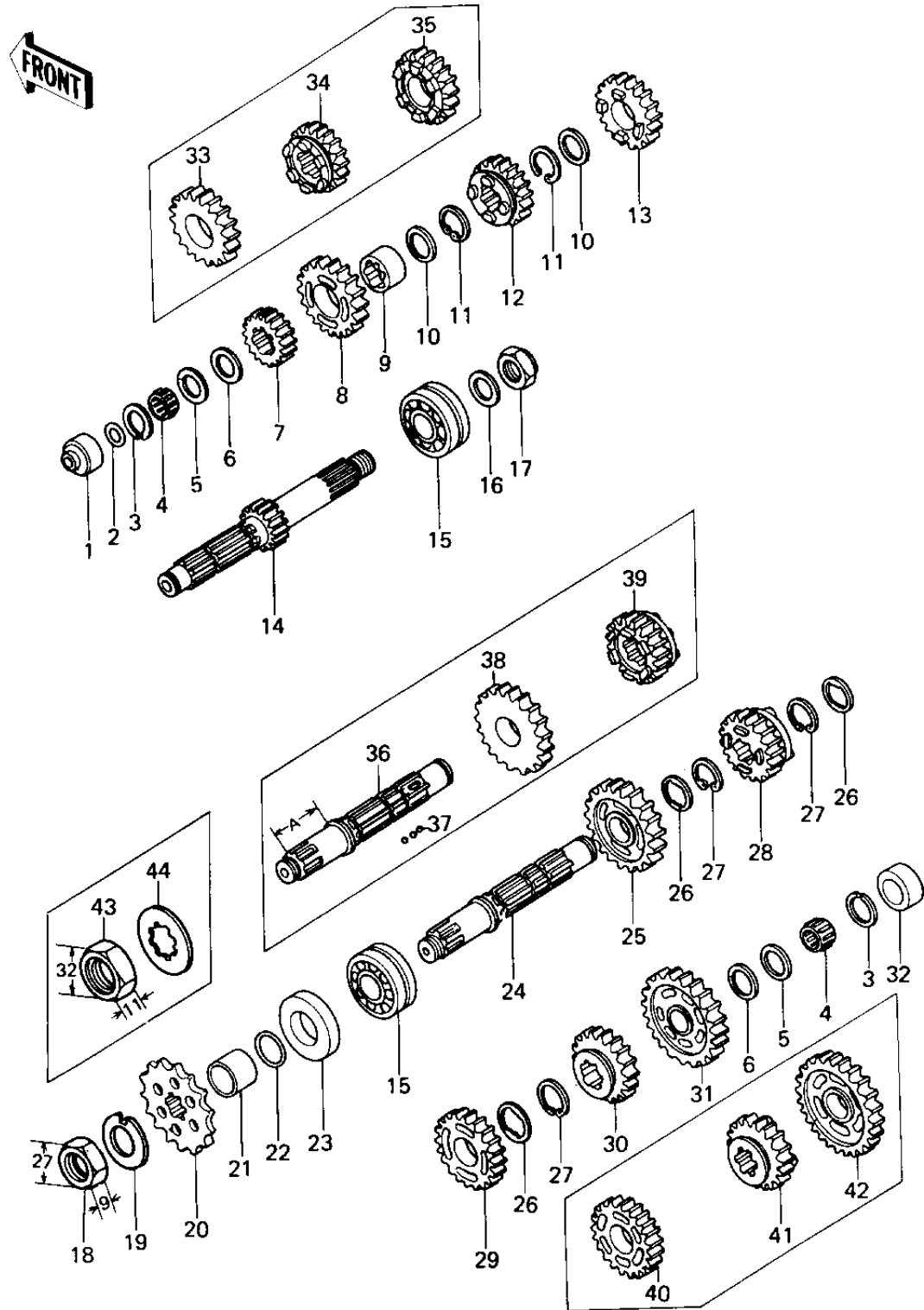

1978 Custom PARTS LIST

TRANSMISSION

ITEM NAME	PART NUMBER	QUANTITY
BUSHING,DRIVE SHAFT (Ref # 1)	92028-179	2
UNAVAILABLE IN PRICE BOOK (Ref # 2)	67081507	2
CIRCLIP (Ref # 3)	92033-015	2
BEARING,VS20/14A (Ref # 4)	92046-1030	2
WASHER THRUST (Ref # 5)	92022-112	2
SHIM-KICK SHAFT (Ref # 5)	92022-144	2
WASHER,PLAIN (Ref # 5)	92022-1026	2
WASHER THRUST (Ref # 6)	92022-113	2
2ND GEAR,DRIVE (Ref # 7)	13130-041	2
TOP GEAR,DRIVE (Ref # 8)	13136-060	2
BUSHING,DRV SHFT TOP (Ref # 9)	92028-1007	2
BUSHING,DRV SHFT TOP (Ref # 9)	92028-1007	2
WASHER PLAIN (Ref # 10)	92022-161	2
CIRCLIP (Ref # 11)	92033-026	2
3RD GEAR,DRIVE (Ref # 12)	13132-044	2
4TH GEAR,DRIVE (Ref # 13)	13134-029	2
SHAFT,DRIVE (Ref # 14)	13127-051	2
BEARING,BALL (Ref # 15)	92045-035	2
WASHER (Ref # 16)	92125-002	2
NUT,20MM (Ref # 17)	92015-1555	2
NUT 20MM (Ref # 18)	92016-028	2
WASHER,LOCK,20MM (Ref # 19)	92024-044	2
ENGINE SPROCKET,16T (Ref # 20)	13144-063	2
ENGINE SPROCKET,17T (Ref # 20)	13144-1009	2
COLLAR,ENG SPROCKET (Ref # 21)	92027-288	2
"O" RING (Ref # 22)	92055-035	2
OIL SEAL SC325210 (Ref # 23)	92050-024	2
SHAFT,OUTPUT (Ref # 24)	13128-044	2
2ND GEAR,OUTPUT (Ref # 25)	13131-052	2

1978 Custom PARTS LIST

TRANSMISSION

ITEM NAME	PART NUMBER	QUANTITY
WASHER,LOCK (Ref # 26)	92024-069	2
CIRCLIP,30MM (Ref # 27)	480J3000	2
TOP GEAR,OUTPUT (Ref # 28)	13137-039	2
3RD GEAR, OUTPUT SHAFT, 28T (Ref # 29)	13133-041	2
4TH GEAR,OUTPUT (Ref # 30)	13135-030	2
LOW GEAR,OUTPUT (Ref # 31)	13129-056	2
BUSHING, OUTPUT SHAFT (Ref # 32)	92028-180	2
TOP GEAR,DRIVE SHAFT (Ref # 33)	13129-1045	2
3RD GEAR,DRIVE SHAFT (Ref # 34)	13129-1032	2
4TH GEAR,DRIVE SHAFT (Ref # 35)	13129-1044	2
SHAFT,OUTPUT (Ref # 36)	13128-5005	2
SHAFT,OUTPUT (Ref # 36)	13128-1012	2
BALL STEEL 3/16' (Ref # 37)	600A0600	2
2ND GEAR,OUTPUT SHAF (Ref # 38)	13129-1047	2
TOP GEAR,OUTPUT SHAF (Ref # 39)	13129-1033	2
3RD GEAR,OUTPUT SHAF (Ref # 40)	13129-1048	2
4TH GEAR,OUTPUT SHAF (Ref # 41)	13129-1049	2
LOW GEAR,OUTPUT SHAF (Ref # 42)	13129-1046	2
NUT,20MM (Ref # 43)	92015-1254	2
WASHER (Ref # 44)	92200-1065	2