

# 1979 KZ400-B2 PARTS DIAGRAM

## FRAME/FRAME FITTINGS

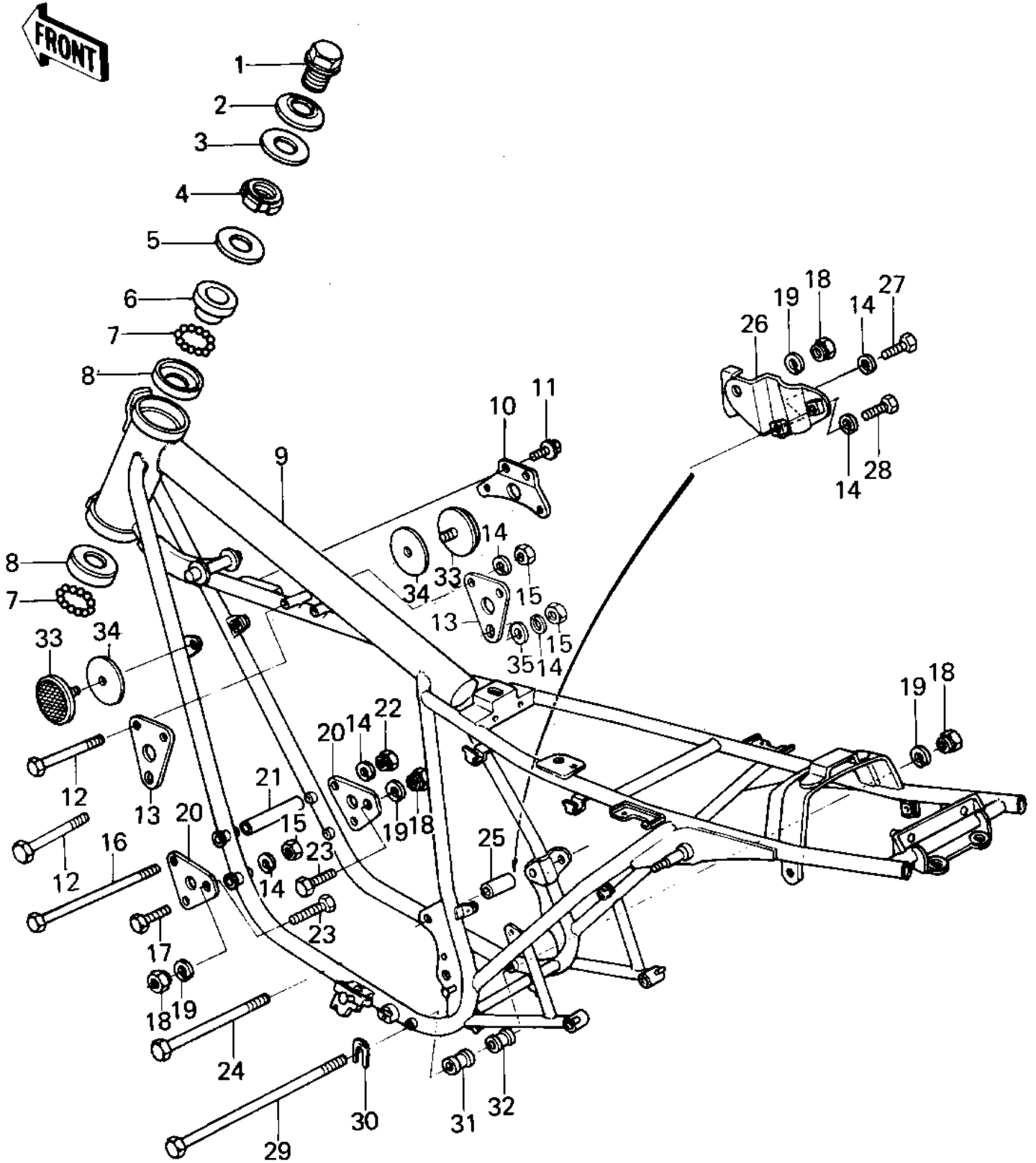

# 1979 KZ400-B2 PARTS LIST

## FRAME/FRAME FITTINGS

ITEM NAME	PART NUMBER	QUANTITY
BOLT,STEERG STEM HEAD (Ref # 1)	92007-031	
WASHER,STEERG STM HD (Ref # 2)	92022-230	
WASHER,WAVE (Ref # 3)	46100-003	
NUT STEERING STEM LCK (Ref # 4)	92090-007	
CAP, STEERING STEM (Ref # 5)	46098-016	
CONE STRNG STEM BERNG (Ref # 6)	92047-006	
BALL STEEL 1/4' (Ref # 7)	600A0800	
RACE STRNG STEM BERNG (Ref # 8)	92048-006	
FRAME-COMP (Ref # 9)	32002-1260	
BRACKET,IGNITON COIL (Ref # 10)	32058-049	
BOLT,SPROCKET FITTING (Ref # 11)	92003-208	
BOLT,FLANGED,8X60 (Ref # 12)	92001-1581	
BRACKET,ENGINE (Ref # 13)	32029-1016	
WASHER SPRING 8MM (Ref # 14)	461F0800	
NUT,8MM (Ref # 15)	311B0800	
BOLT,HEX HEAD,8X253 (Ref # 16)	92003-171	
BOLT,HEX HEAD,8X59 (Ref # 17)	110G0859	
NUT,LOCK,10MM (Ref # 18)	92019-021	
WASHER SPRING 10MM (Ref # 19)	461F1000	
PLATE,ENG MOUNT,FRNT (Ref # 20)	32030-044	
COLLAR,ENG PLAT,FRNT (Ref # 21)	92027-233	
NUT,LOCK,8MM (Ref # 22)	92017-013	
BOLT,HEX HEAD,10X50 (Ref # 23)	92001-1254	
BOLT FLANGED 10X220 (Ref # 24)	92002-1197	
COLLAR,ENG MOUNT UPPE (Ref # 25)	92027-228	
PLATE,ENG MOUNT,REAR (Ref # 26)	32030-034	
BOLT-SMALL-UPSET 8X25 (Ref # 27)	115G0825	
BOLT,8X20 (Ref # 28)	115G0820	
BOLT,HEX HEAD,10X292 (Ref # 29)	92003-162	

## 1979 KZ400-B2 PARTS LIST

### FRAME/FRAME FITTINGS

ITEM NAME	PART NUMBER	QUANTITY
SHIM-ENG FIT FR,0.5MM (Ref # 30)	92025-053	
SHIM-ENG FIT FR,0.8MM (Ref # 30)	92025-054	
SHIM-ENG FIT FR,1.0MM (Ref # 30)	92025-055	
SHIM-ENG FIT FR,1.6MM (Ref # 30)	92025-056	
SHIM-ENG FIT FR,2.0MM (Ref # 30)	92025-057	
SHIM-ENG FIT FR,2.3MM (Ref # 30)	92025-058	
COLLAR,ENG MOUNTING (Ref # 31)	92027-160	
COLLAR (Ref # 32)	92027-250	
REFLECTOR,REFLEX,REAR (Ref # 33)	28012-009	
DAMPER RUBBER,REFLECT (Ref # 34)	92094-011	
WASHER PLAIN 8MM (Ref # 35)	411B0800	