

1977 KH400-A4 PARTS DIAGRAM

IGNITION/GENERATOR/REGULATOR

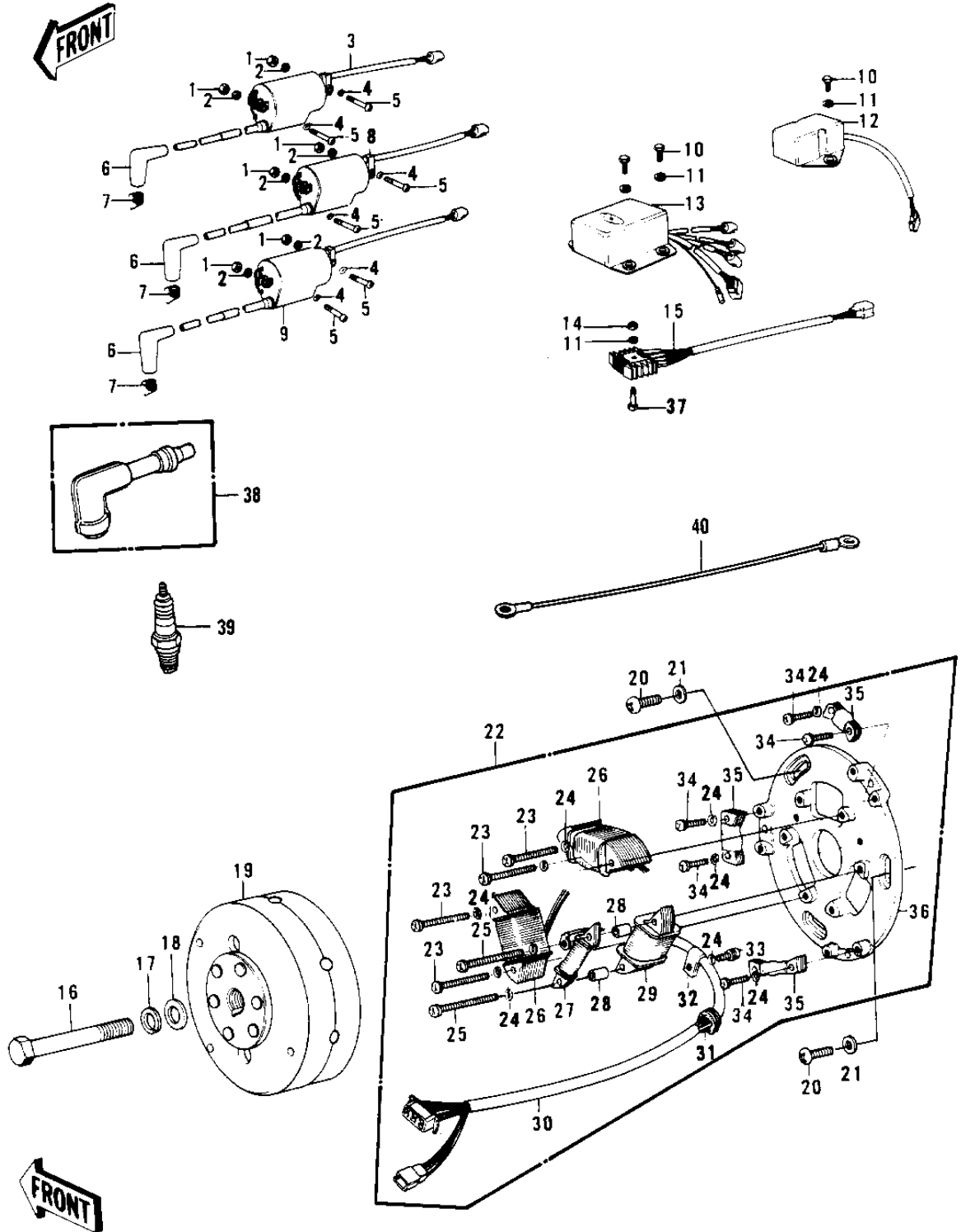

1977 KH400-A4 PARTS LIST

IGNITION/GENERATOR/REGULATOR

| ITEM NAME | PART NUMBER | QUANTITY |
|--------------------------------------|-------------|----------|
| NUT,5MM (Ref # 1) | 311B0500 | 1 |
| WASHER SPRING 5MM (Ref # 2) | 461F0500 | 1 |
| COIL,IGNITION,R.H (Ref # 3) | 21121-080 | 1 |
| WASHER PLAIN 5MM (Ref # 4) | 411B0500 | 1 |
| SCREW PAN HEAD 5X20 (Ref # 5) | 220B0520 | 1 |
| CAP SPARK PLUG (Ref # 6) | 21130-009 | 1 |
| SPRING-SPARK PLUG CAP (Ref # 7) | 92101-001 | 1 |
| COIL,IGNITION,CENTER (Ref # 8) | 21121-079 | 1 |
| COIL,IGNITION,L.H (Ref # 9) | 21121-078 | 1 |
| BOLT-UPSET,6X16 (Ref # 10) | 112G0616 | 1 |
| WASHER SPRING 6MM (Ref # 11) | 461F0600 | 1 |
| REGULATOR (Ref # 12) | 21072-009 | 1 |
| IGNITION UNIT (Ref # 13) | 21119-024 | 1 |
| NUT 6MM (Ref # 14) | 311B0600 | 1 |
| RECTIFIER (Ref # 15) | 21061-022 | 1 |
| BOLT,10X45 (Ref # 16) | 92001-1182 | 2 |
| WASHER SPRING 8MM (Ref # 17) | 461F0800 | 1 |
| WASHER 8.5X23.5X4.5 (Ref # 18) | 92022-218 | 1 |
| FLYWHEEL (Ref # 19) | 21050-022 | 1 |
| UNAVAILABLE IN PRICE BOOK (Ref # 20) | 214B0516A | 1 |
| WASHER PLAIN 5MM (Ref # 21) | 410B0500 | 1 |
| STATOR ASSY (Ref # 22) | 21003-032 | 1 |
| SCREW-PAN HEAD,4X35 (Ref # 23) | 220E0435A | 1 |
| WASHER SPRING 4MM (Ref # 24) | 461F0400 | 1 |
| SCREW,PAN HEAD,4X38 (Ref # 25) | 21022-021 | 1 |
| COIL,LIGHTING (Ref # 26) | 21047-032 | 1 |
| COIL,EXCITE (Ref # 27) | 21047-029 | 1 |
| COLLAR (Ref # 28) | 21033-003 | 1 |
| COIL,CHARGE (Ref # 29) | 21047-028 | 1 |

1977 KH400-A4 PARTS LIST

IGNITION/GENERATOR/REGULATOR

| ITEM NAME | PART NUMBER | QUANTITY |
|---------------------------------|-------------|----------|
| WIRING HARNESS,MAGNT (Ref # 30) | 21029-035 | 1 |
| GROMMET WIRING HARN (Ref # 31) | 21017-002 | 1 |
| CLAMP,WIRING HARNESS (Ref # 32) | 21037-006 | 1 |
| SCREW PAN HEAD 4X8 (Ref # 33) | 220B0408 | 1 |
| SCREW,PAN HEAD,4X18 (Ref # 34) | 21022-022 | 1 |
| COIL,PULSER (Ref # 35) | 21047-030 | 1 |
| BASE,MAGNETO (Ref # 36) | 21048-016 | 1 |
| BOLT-UPSET,6X40 (Ref # 37) | 112G0640 | 1 |
| CAP,SPARK PLUG (Ref # 38) | 21160-005 | 1 |
| SPARK PLUG B8HS (Ref # 39) | B8HS | 2 |
| WIRE-LEAD (Ref # 40) | 26011-084 | 1 |