

# 1973 Mach II PARTS DIAGRAM

FRONT FORK (S2-A)

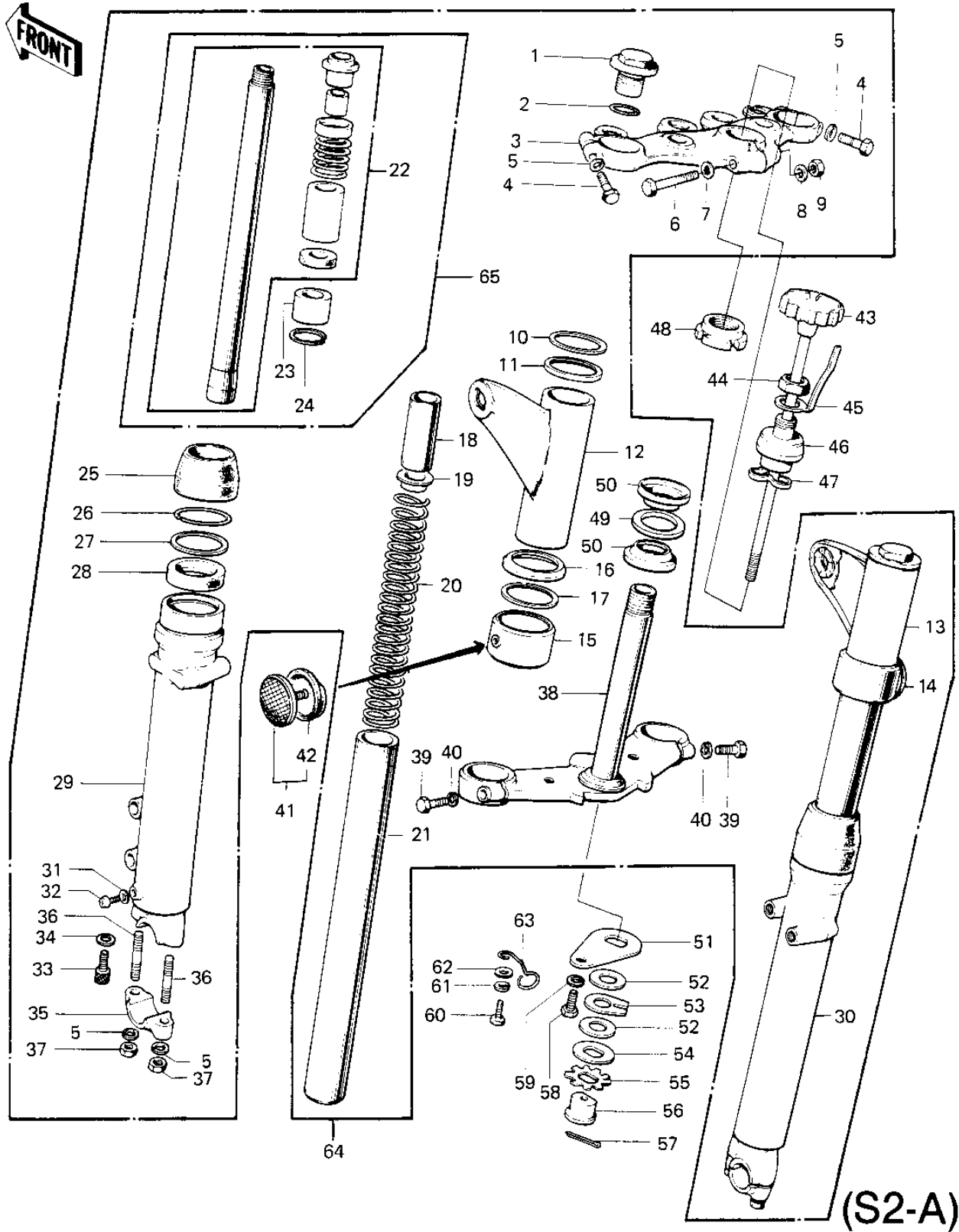

# 1973 Mach II PARTS LIST

## FRONT FORK (S2-A)

ITEM NAME	PART NUMBER	QUANTITY
BOLT-FORK FITTING (Ref # 1)	44041-037	
"O" RING,FORK TOP (Ref # 2)	92055-1012	
"O" RING,FORK TOP (Ref # 2)	92055-1012	
HEAD-STEERING STEM (Ref # 3)	44039-051	
BOLT-STEERING STEM HD (Ref # 4)	44041-044	
WASHER SPRING 8MM (Ref # 5)	461F0800	
BOLT-STEERING STEM HD (Ref # 6)	44041-042	
WASHER LOCK 8MM (Ref # 7)	463H0800	
WASHER PLAIN 8MM (Ref # 8)	410B0800	
NUT,LOCK,8MM (Ref # 9)	92015-1124	
NUT,LOCK,8MM (Ref # 9)	92015-1124	
GASKET,FORK COVER (Ref # 10)	44045-039	
WASHER,FORK COVER (Ref # 11)	44043-047	
COVER-L.H FORK,BLACK (Ref # 12)	44033-053-21	
COTER,L.H FORK (Ref # 12)	44033-067	
COVER-R.H FORK,BLACK (Ref # 13)	44034-053-21	
COVER,R.H FORK (Ref # 13)	44034-067	
GUIDE-FORK COVER,R.H (Ref # 14)	44064-009	
GUIDE-FORK COVER,L.H (Ref # 15)	44064-010	
CAP,FORK COVER (Ref # 16)	44032-005	
GASKET FORK COVER (Ref # 17)	44045-029	
SPACER-FORK SP GUIDE (Ref # 18)	44028-026	
GUIDE-FORK SPRING (Ref # 19)	44029-019	
SPRING-FORK (Ref # 20)	44026-043	
TUBE-FORK INNER (Ref # 21)	44013-038	
CYLINDER-FORK (Ref # 22)	44023-005	
CYLINDER-FORK (Ref # 22)	44022-026	
PISTON FORK (Ref # 23)	44018-001	
PISTON,FORK (Ref # 23)	44018-009	

# 1973 Mach II PARTS LIST

## FRONT FORK (S2-A)

ITEM NAME	PART NUMBER	QUANTITY
CIRCLIP FORK PISTON (Ref # 24)	44044-008	
CIRCLIP FORK PISTON (Ref # 24)	44044-008	
DUST SHIELD-FORK (Ref # 25)	44010-019	
CIRCLIP OIL SEAL FIT (Ref # 26)	44044-005	
WASHER OIL SEAL FIT (Ref # 27)	44043-023	
OIL SEAL,FORK (Ref # 28)	44009-020	
TUBE,LH,FORK OUTER (Ref # 39)	44005-046	
TUBE,RH,FORK OUTER (Ref # 30)	44006-044	
GASKET FORK DRAIN PLG (Ref # 31)	44045-002	
SCREW PAN HEAD 4X8 (Ref # 32)	220B0408	
BOLT-FORK CYLINDER (Ref # 33)	44041-040	
GASKET,FORK CYLINDER (Ref # 34)	44045-057	
HOLDER-FRONT AXLE (Ref # 35)	44063-006	
STUD 8X30 (Ref # 36)	172G0830	
NUT,8MM (Ref # 37)	311B0800	
STEM-STEERING (Ref # 38)	44037-058	
BOLT HEX HEAD 10X32 (Ref # 39)	113B1032	
WASHER SPRING 10MM (Ref # 40)	461F1000	
REFLECTOR,REFLEX,FRNT (Ref # 41)	28001-029	
DAMPER RUBBER-REFLEX (Ref # 42)	28016-002	
KNOB-STEERING DAMPER (Ref # 43)	46101-007	
NUT 12MM (Ref # 44)	315N1200A	
SPRING STRG DAMP KNOB (Ref # 45)	46126-001	
BOLT-STEERING STEM (Ref # 46)	92090-020	
WASHER-WAVE (Ref # 47)	46100-002	
NUT STEERING STEM LCK (Ref # 48)	92090-007	
CAP, STEERING STEM (Ref # 49)	46098-016	
CONE STRNG STEM BERNG (Ref # 50)	92047-006	
PLATE-STRG DAMP STEEL (Ref # 51)	46106-007	

# 1973 Mach II PARTS LIST

## FRONT FORK (S2-A)

ITEM NAME	PART NUMBER	QUANTITY
PLATE STRG DAMP FRCTN (Ref # 52)	46104-005	
PLATE STRG DAMP ANCHR (Ref # 53)	46105-005	
PLATE-STRG DAMP STEEL (Ref # 54)	46106-008	
SPRING-STEERING DAMP (Ref # 55)	46124-006	
NUT STRG DAMPER GUIDE (Ref # 56)	46125-005	
PIN COTTER 1.6X15 (Ref # 57)	550D1615	
BOLT SMALL (Ref # 58)	114G0812	
WASHER SPRING 8MM (Ref # 59)	461F0800	
BOLT,6X10 (Ref # 60)	112G0610	
WASHER SPRING 6MM (Ref # 61)	461F0600	
WASHER PLAIN 6MM (Ref # 62)	410B0600	
CLAMP-CABLE (Ref # 63)	92037-099	
FORK-FRONT (Ref # 64)	44001-144	
FORK-FRONT (Ref # 64)	44001-144	
CYLINDER-FORK (Ref # 65)	44023-005	