

1967 Avenger SS PARTS DIAGRAM

IGNITION/GENERATOR A1/A1SS/A7/A7SS

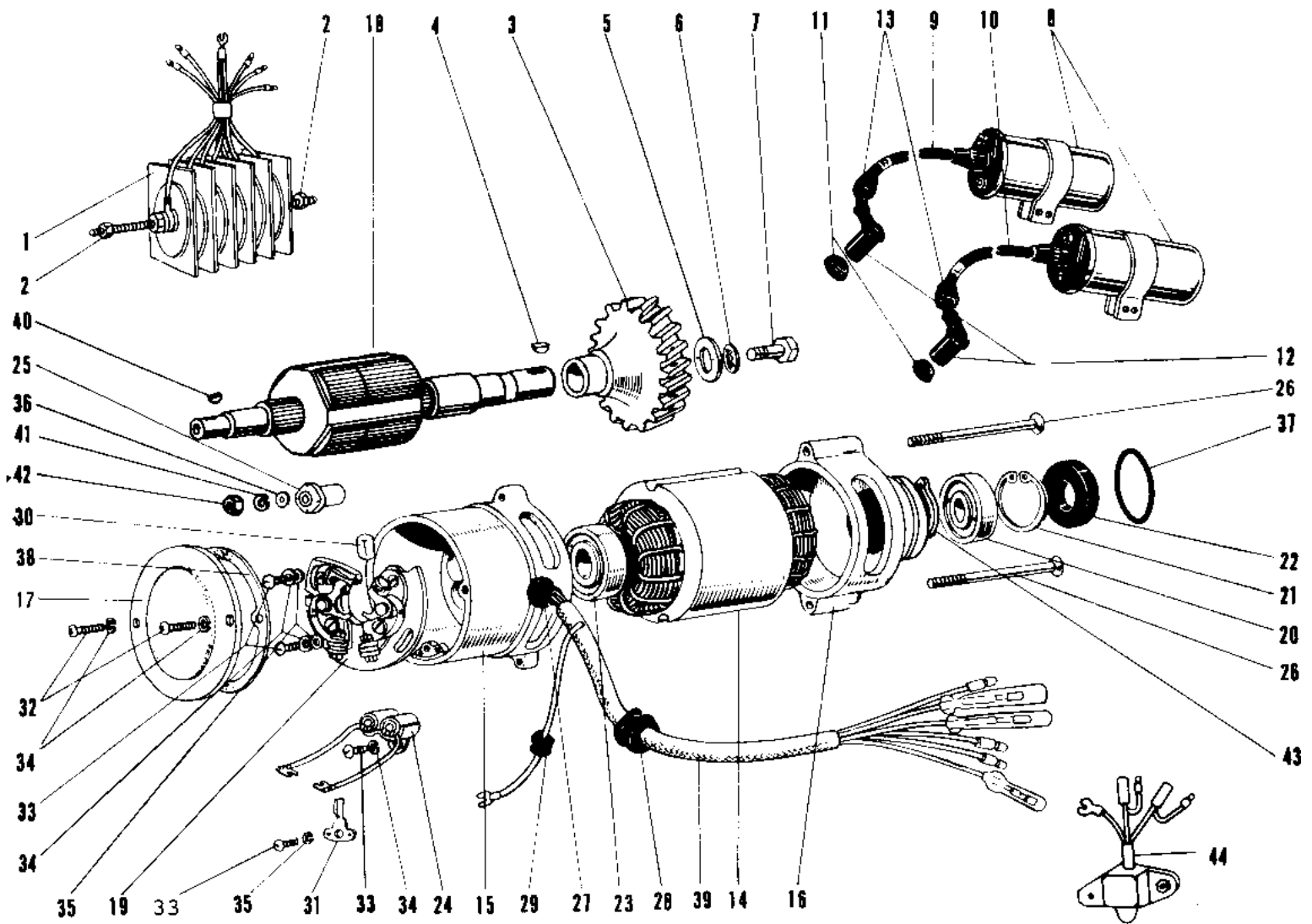

1967 Avenger SS PARTS LIST

IGNITION/GENERATOR A1/A1SS/A7/A7SS

| ITEM NAME | PART NUMBER | QUANTITY |
|--------------------------------------|-------------|----------|
| RECTIFIER (Ref # 1) | 21061-005 | 1 |
| NUT 6MM (Ref # 2) | 312B0600 | 2 |
| GEAR DYNAMO (Ref # 3) | 21069-006 | 1 |
| WOODRUFF KEY (Ref # 4) | 510A3100 | 1 |
| WASHER PLAIN 8MM (Ref # 5) | 92022-079 | 1 |
| WASHER LOCK 8MM (Ref # 6) | 463H0800 | 1 |
| BOLT,8X20 (Ref # 7) | 115G0820 | 1 |
| COIL IGNITION (Ref # 8) | 21121-015 | 2 |
| CORD HIGH TENSION R.H (Ref # 9) | 21133-007 | 1 |
| CORD HIGH TENSION L.H (Ref # 10) | 21133-008 | 1 |
| GROMMET PLUG CAP A (Ref # 11) | 21131-002 | 2 |
| GROMMET-PLUG CAP,A (Ref # 11) | 21131-004 | 2 |
| CAP-SPARK PLUG (Ref # 12) | 21130-016 | 2 |
| CAP-SPARK PLUG (Ref # 12) | 21130-016 | 2 |
| GROMMET (Ref # 13) | 92071-517 | 2 |
| GROMMET,SPARK PLG CAP (Ref # 13) | 21132-005 | 2 |
| DYNAMO EN-08 (Ref # 14~44) | 21001-010 | 1 |
| STATOR (Ref # 14) | 21003-008 | 1 |
| UNAVAILABLE IN PRICE BOOK (Ref # 15) | 21004-006 | 1 |
| UNAVAILABLE IN PRICE BOOK (Ref # 16) | 21005-002 | 1 |
| COVER CONTACT BREAKER (Ref # 17) | 21006-002 | 1 |
| ROTOR (Ref # 18) | 21007-010 | 1 |
| BREAKER ASSY CONTACT (Ref # 19) | 21008-011 | 1 |
| BEARING BALL #6202 (Ref # 20) | 21009-001 | 1 |
| CIRCLIP 35MM (Ref # 21) | 21010-002 | 1 |
| OIL SEAL SB22357 (Ref # 22) | 21011-002 | 1 |
| BEARING BALL #6201ZZ (Ref # 23) | 21009-002 | 1 |
| CONDENSER (Ref # 24) | 21013-007 | 1 |
| CAM (Ref # 25) | 21014-006 | 1 |

1967 Avenger SS PARTS LIST

IGNITION/GENERATOR A1/A1SS/A7/A7SS

| ITEM NAME | PART NUMBER | QUANTITY |
|----------------------------------|-------------|----------|
| SCREW CNTSNK HD 6X98 (Ref # 26) | 21015-004 | 2 |
| GROMMET WIRING HARN A (Ref # 27) | 21017-001 | 1 |
| GROMMET WIRING HARN B (Ref # 28) | 21017-003 | 1 |
| GROMMET WIRING HARN C (Ref # 29) | 21017-005 | 1 |
| FELT OIL (Ref # 30) | 21019-005 | 1 |
| POINTER IGN TIMING (Ref # 31) | 21020-001 | 1 |
| SCREW PAN HEAD 4X10 (Ref # 32) | 220B0410 | 4 |
| SCREW PAN HEAD 4X6 (Ref # 33) | 220B0406 | 6 |
| WASHER SPRING 4MM (Ref # 34) | 461F0400 | 5 |
| WASHER PLAIN 4MM (Ref # 35) | 410B0400 | 3 |
| WASHER PLAIN 6MM (Ref # 36) | 410B0600 | 1 |
| "O" RING,46MM (Ref # 37) | 21027-002 | 1 |
| GASKET CNTCT BRK COV (Ref # 38) | 21028-002 | 1 |
| WIRING HARNESS DYNAMO (Ref # 39) | 21029-007 | 1 |
| WOODRUFF KEY CAM (Ref # 40) | 21030-002 | 1 |
| WASHER SPRING 8MM (Ref # 41) | 461F0800 | 1 |
| NUT 8MM (Ref # 42) | 21032-001 | 1 |
| WASHER WAVE 19MM (Ref # 43) | 21034-001 | 1 |
| REGULATOR VOLTAGE (Ref # 44) | 21066-006 | 1 |