

1967 Avenger SS PARTS DIAGRAM

ENGINE COVERS

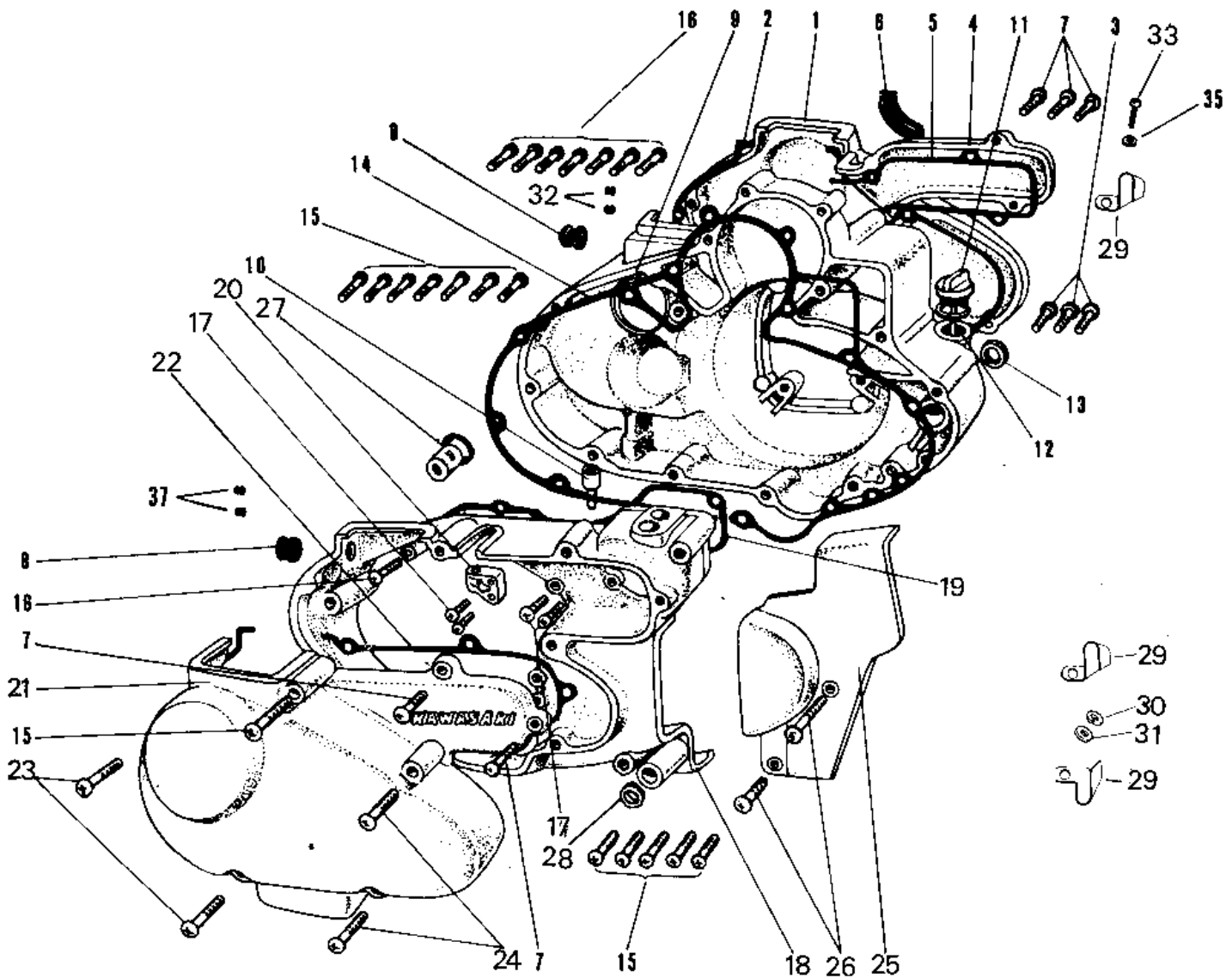

1967 Avenger SS PARTS LIST

ENGINE COVERS

| ITEM NAME | PART NUMBER | QUANTITY |
|----------------------------------|-------------|----------|
| COVER R.H CARBURETOR (Ref # 1) | 14030-007 | 1 |
| GASKET R.H CARB COVER (Ref # 2) | 14047-004 | 1 |
| SCREW OVL CNTSNK 6X25 (Ref # 3) | 222B0625 | 3 |
| CAP R.H ENGINE COVER (Ref # 4) | 14034-001 | 1 |
| GASKET R.H COV CAP A (Ref # 5) | 14046-010 | 1 |
| GSKT RH ENG COV CAP B (Ref # 6) | 14016-011 | 1 |
| SCREW PAN HEAD 6X20 (Ref # 7) | 220B0620 | 5 |
| CAP CARB MOUNT HOLE (Ref # 8) | 14039-001 | 2 |
| COVER R.H ENGINE (Ref # 9) | 14032-023 | 1 |
| PIPE FUEL OVERFLOW (Ref # 10) | 16116-001 | 1 |
| PLUG OIL FILLER (Ref # 11) | 16115-002 | 1 |
| "O" RING,20MM (Ref # 12) | 670B2020 | 1 |
| OIL SEAL TB16267 (Ref # 13) | 92051-003 | 1 |
| GASKET R.H ENGINE COV (Ref # 14) | 14046-008 | 1 |
| SCREW PAN HEAD 6X50 (Ref # 15) | 220B0650 | 17 |
| SCREW PAN HEAD 6X40 (Ref # 16) | 220B0640 | 10 |
| SCREW PAN HEAD 6X25 (Ref # 17) | 220B0625 | 5 |
| COVER L.H ENGINE (Ref # 18) | 14031-029 | 1 |
| GASKET L.H ENGINE COV (Ref # 19) | 14045-002 | 1 |
| GUIDE OIL PUMP CABLE (Ref # 20) | 14044-004 | 1 |
| COVER L.H CARBURETOR (Ref # 21) | 14030-010 | 1 |
| GASKET L.H CARB COVER (Ref # 22) | 14047-006 | 1 |
| SCREW OVL CNTSNK 6X50 (Ref # 23) | 222B0650 | 2 |
| SCREW OVL CNTSNK 6X40 (Ref # 24) | 222B0640 | 2 |
| COVER DRIVE CHAIN FR (Ref # 25) | 14026-001 | 1 |
| SCREW PAN HEAD 6X70 (Ref # 26) | 220B0670 | 2 |
| DRAIN AIR (Ref # 27) | 16116-003 | 2 |
| OIL SEAL SB12205 (Ref # 28) | 92049-004 | 1 |
| GUIDE OVERFLOW PIPE (Ref # 29) | 16068-001 | 3 |

1967 Avenger SS PARTS LIST

ENGINE COVERS

| ITEM NAME | PART NUMBER | QUANTITY |
|----------------------------------|--------------------|-----------------|
| WASHER PLAIN 6MM (Ref # 30) | 410B0600 | 3 |
| PLUG RUBBER (Ref # 32) | 92074-016 | 2 |
| SCREW OVL CNTSNK 6X20 (Ref # 33) | 222B0620 | 1 |