

1974 KX250 PARTS DIAGRAM

SWING ARM/SHOCK ABSORBERS (KX250-A/A3)

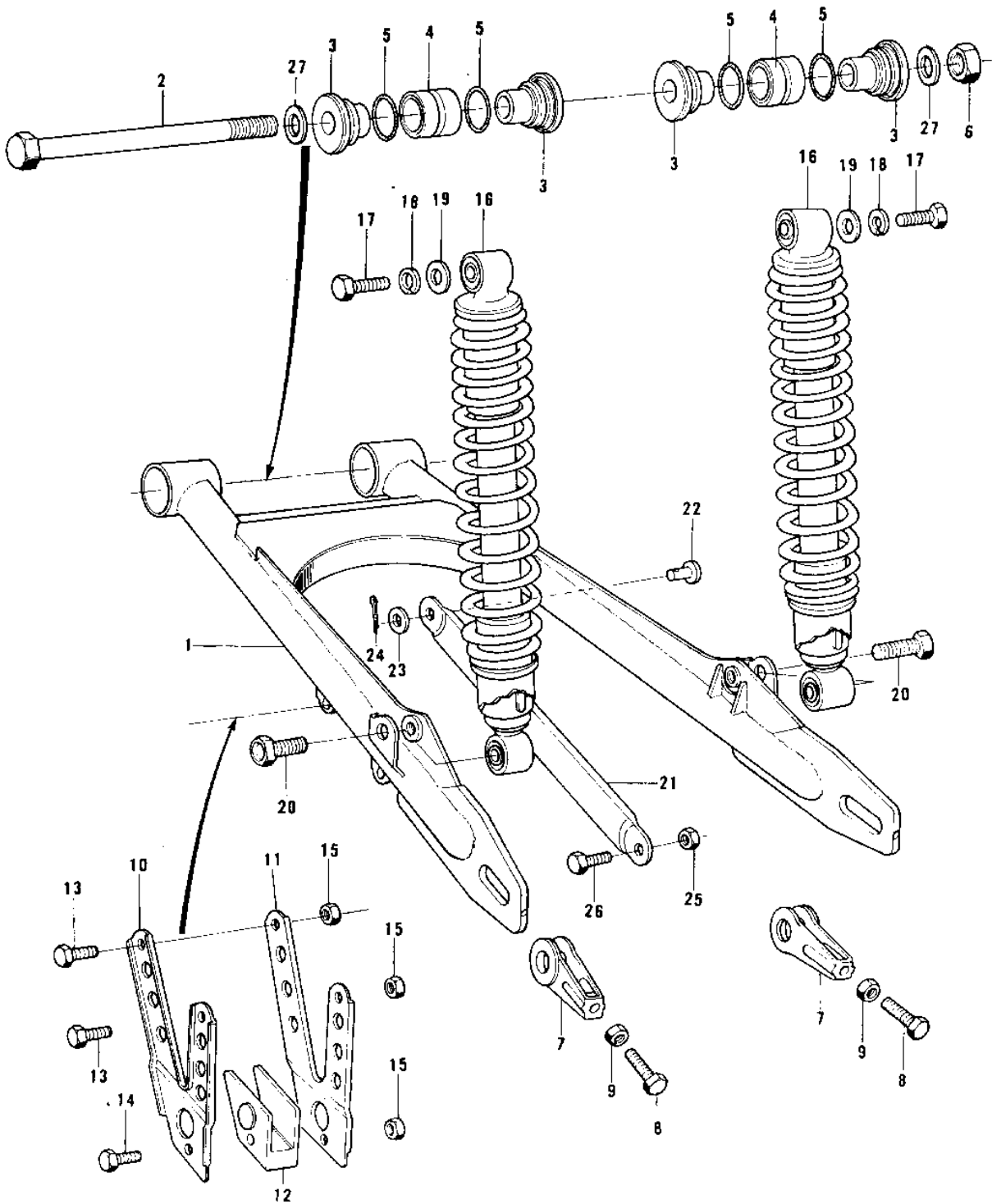

1974 KX250 PARTS LIST

SWING ARM/SHOCK ABSORBERS (KX250-A/A3)

ITEM NAME	PART NUMBER	QUANTITY
ARM,SWING (Ref # 1)	33001-079	1
SHAFT,SWING ARM PIVOT (Ref # 2)	33032-042	1
SHAFT,SWING ARM PIVOT (Ref # 2)	33032-048	1
SLEEVE,SWING ARM (Ref # 3)	33034-020	4
BEARING,NEEDLE (Ref # 4)	92046-047	2
"O" RING,22MM (Ref # 5)	670B3022	4
OIL SEAL (Ref # 5)	92056-008	4
NUT,12MM (Ref # 6)	92019-017	1
ADJUSTER,CHAIN (Ref # 7)	33040-067	2
BOLT,CHAIN ADJUSTER (Ref # 8)	92001-132	2
NUT,8MM (Ref # 9)	312G0800	2
GUARD,CHAIN,L.H (Ref # 10)	55020-017	1
GUARD,CHAIN,R.H (Ref # 11)	55020-018	1
GUARD,CHAIN (Ref # 12)	55020-019	1
BOLT 6X35 (Ref # 13)	110R0635	2
BOLT-UPSET,6X40 (Ref # 14)	112G0640	1
NUT,6MM (Ref # 15)	92019-019	3
SHOCK ABSBR RR (Ref # 16)	45014-104	2
BOLT-UPSET (Ref # 17)	112G0614	2
WASHER SPRING 6MM (Ref # 18)	461F0600	2
WASHER,PLAIN,7MM (Ref # 19)	92022-228	2
BOLT,HEX HEAD,12X35 (Ref # 20)	92001-133	2
TORQUE LINK,RR BRAKE (Ref # 21)	43007-040	1
PIN,TORQUE LINK (Ref # 22)	92043-105	1
WASHER,PLAIN (Ref # 23)	92022-239	1
PIN COTTER 2.0X20 (Ref # 24)	550D2020	1
NUT,10MM (Ref # 25)	92019-016	1
BOLT,10X28 (Ref # 26)	113G1028	1
WASHER PLAIN 12MM (Ref # 27)	411B1200	2