

1973 Mach I PARTS DIAGRAM

CRANKSHAFT/PISTONS

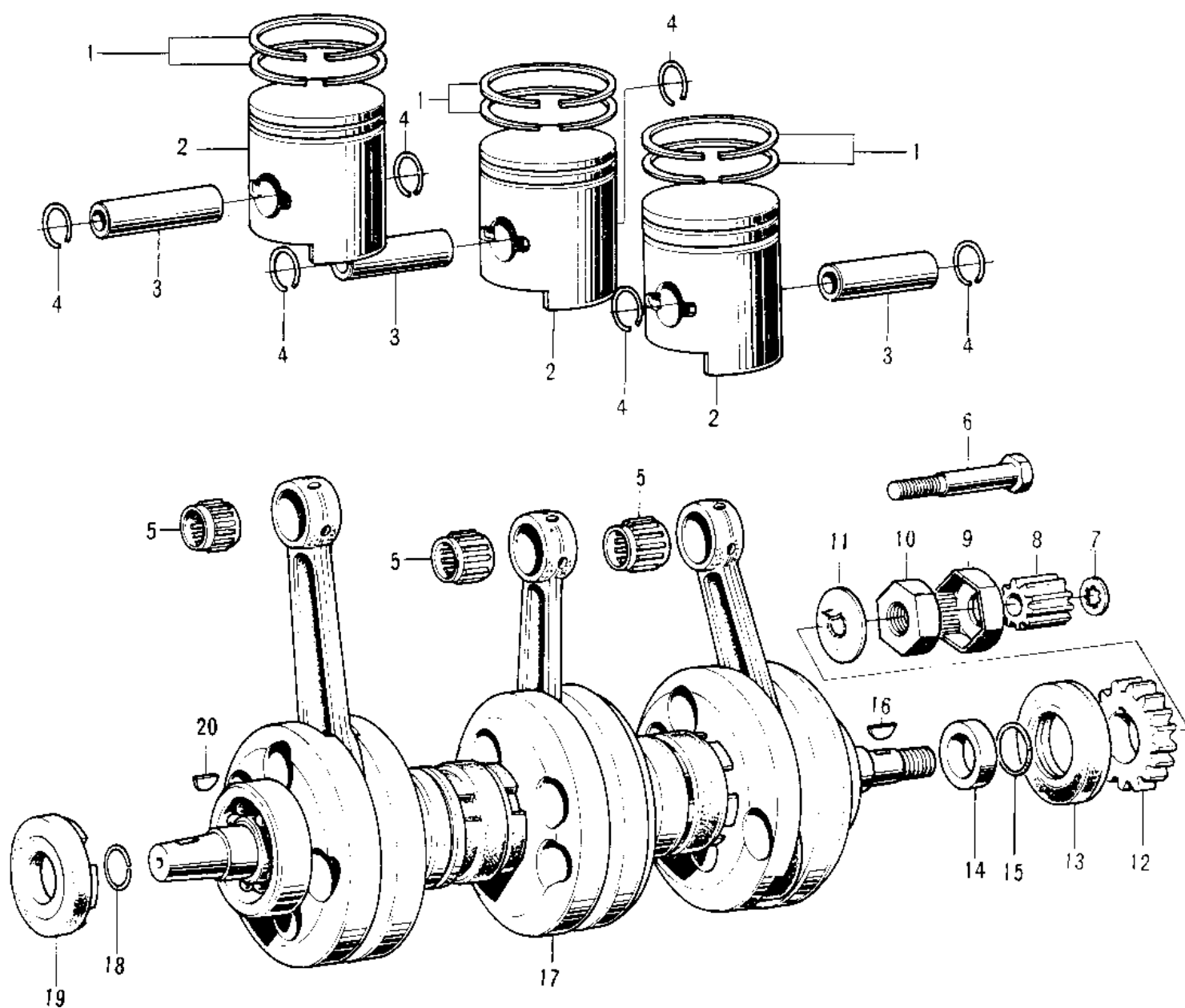

1973 Mach I PARTS LIST

CRANKSHAFT/PISTONS

| ITEM NAME | PART NUMBER | QUANTITY |
|----------------------------------|-------------|----------|
| RING SET,STD (Ref # 1) | 13008-033 | 3 |
| RING SET,0.040'O.S (Ref # 1) | 13024-041 | (3 |
| RING SET,0.020'O.S (Ref # 1) | 13025-038 | (3 |
| PISTON,STD (Ref # 2) | 13001-056 | 3 |
| PISTON,0.040'O.S (Ref # 2) | 13027-055 | (3 |
| PISTON,0.020' O.S (Ref # 2) | 13029-057 | (3 |
| PIN-PISTON (Ref # 3) | 13002-021 | 3 |
| CIRCLIP PISTON PIN (Ref # 4) | 92036-005 | 6 |
| NEEDLE BEARING SM END (Ref # 5) | 13033-007 | 3 |
| BOLT-OIL PUMP GEAR (Ref # 6) | 92003-068 | 1 |
| WASHER LOCK 6MM (Ref # 7) | 463H0600 | 1 |
| PINION-OIL PUMP (Ref # 8) | 16084-014 | 1 |
| WASHER LOCK (Ref # 9) | 92024-021 | 1 |
| NUT 18MM (Ref # 10) | 92015-019 | 1 |
| WASHER,LOCK,18MM (Ref # 11) | 92024-067 | 1 |
| PINION-PRIMARY (Ref # 12) | 13121-021 | 1 |
| OIL SEAL,TC326210 (Ref # 13) | 92050-052 | 1 |
| COLLAR CRANK OIL SEAL (Ref # 14) | 92027-031 | 1 |
| "O" RING,22MM (Ref # 15) | 92055-018 | 1 |
| WOODRUFF KEY (Ref # 16) | 92038-015 | 1 |
| CRANK CONROD ASSY (Ref # 17) | 13031-1008 | 1 |
| CIRCLIP (Ref # 18) | 92036-013 | 1 |
| OIL SEAL TCY256210 (Ref # 19) | 92050-041 | 1 |
| WOODRUFF KEY (Ref # 20) | 92038-001 | 1 |