

## 1977 KE250-B1 PARTS DIAGRAM

CYLINDER HEAD/CYLINDER

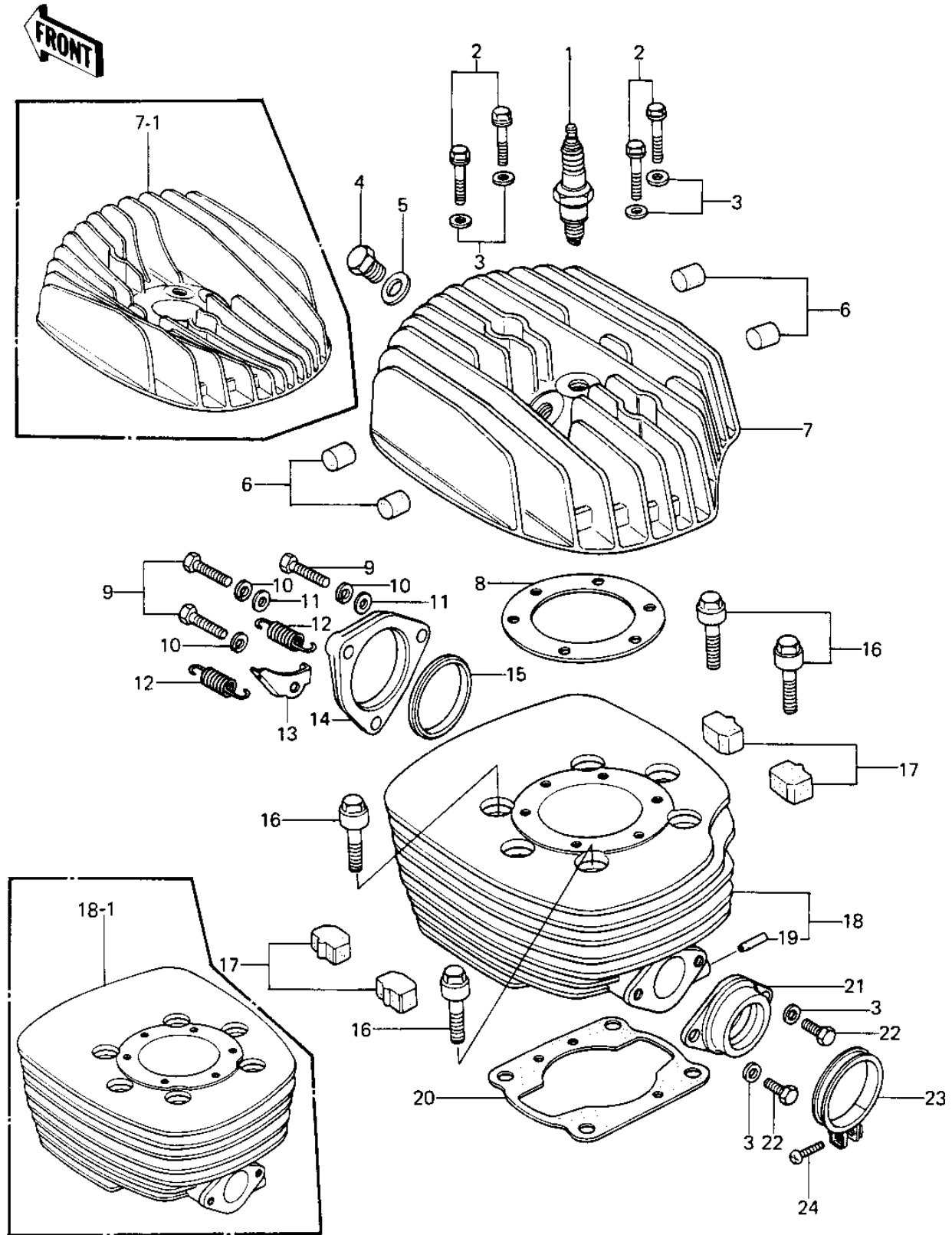

## 1977 KE250-B1 PARTS LIST

### CYLINDER HEAD/CYLINDER

ITEM NAME	PART NUMBER	QUANTITY
SPARK PLUG B8ES (Ref # 1)	B8ES	1
BOLT (Ref # 2)	92001-1578	1
WASHER PLAIN 8MM (Ref # 3)	410B0800	1
PLUG,CYLINDER HEAD (Ref # 4)	92067-023	1
GASKET-CYL HEAD PLUG (Ref # 5)	92065-068	1
DAMPER RUBBER (Ref # 6)	92075-075	2
HEAD,CYLINDER (Ref # 7)	11001-108-21	1
HEAD,CYLINDER,F.BLACK (Ref # 7-1)	11001-1010	1
GASKET,CYLINDER HEAD (Ref # 8)	11004-075	1
BOLT,HEX HEAD,6X35 (Ref # 9)	92001-164	1
WASHER SPRING 6MM (Ref # 10)	461F0600	1
WASHER PLAIN 6MM (Ref # 11)	411B0600	1
SPRING-CONNECTOR (Ref # 12)	18071-003	1
BRACKET,MUFFLER SPRNG (Ref # 13)	18061-059	1
HOLDER,EXHAUST (Ref # 14)	18069-062	1
GASKET,EXHAUST HOLDER (Ref # 15)	18067-021	1
BOLT,CYLINDER,10X40 (Ref # 16)	92003-217	1
DAMPER,RUBBER (Ref # 17)	92075-304	1
CYLINDER,ELECTRO-FUSE (Ref # 18)	11005-157-21	1
CYLINDER,ENG,F.BLACK (Ref # 18-1)	11005-1021	1
NOZZLE (Ref # 19)	92062-009	1
GASKET,CYLINDER BASE (Ref # 20)	11009-045	1
HOLDER-CARBURETOR (Ref # 21)	16065-011	1
BOLT, HEX HEAD, 8 X 20 (Ref # 22)	110B0820	1
CLAMP (Ref # 23)	92037-200	1
SCREW-PAN-CROS,5X25 (Ref # 24)	220B0525	1