

# 1978 KZ200-A1A PARTS DIAGRAM

## FRONT BRAKE

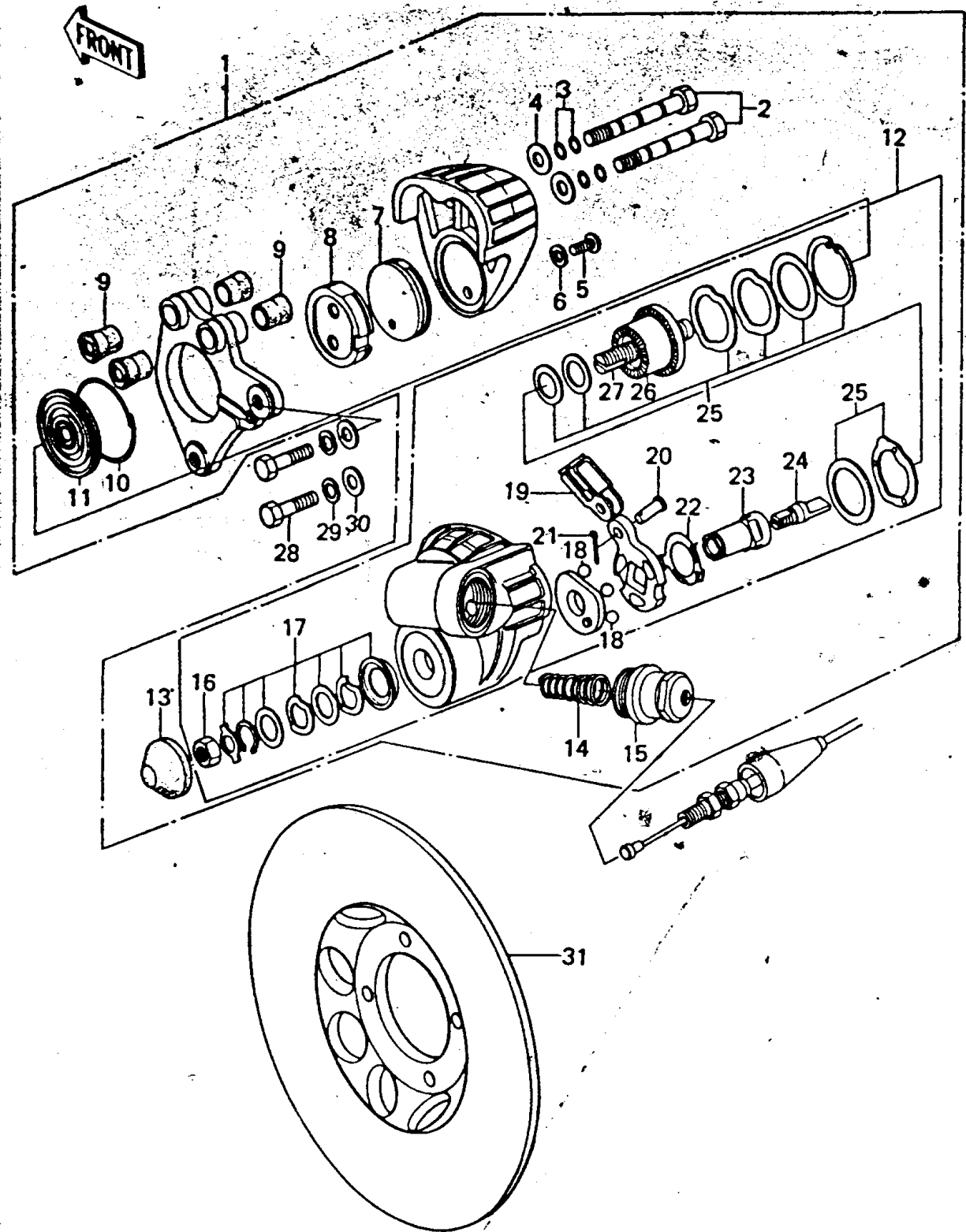

# 1978 KZ200-A1A PARTS LIST

## FRONT BRAKE

ITEM NAME	PART NUMBER	QUANTITY
CALIPER ASSY,FRONT (Ref # 1)	43041-1030	
CALIPER ASSY,FRONT (Ref # 1)	43041-1030	
BOLT (Ref # 2)	43045-1001	
BRACKET-BRAKE HOSE (Ref # 3)	43063-001	
WASHER,PLAIN (Ref # 4)	92022-1001	
SCREW PAN HEAD 6X10 (Ref # 5)	220B0610	
WASHER SPRING 6MM (Ref # 6)	461F0600	
PAD B (Ref # 7)	43050-1010	
PAD A (Ref # 8)	43050-1009	
DUST SEAL-SHAFT (Ref # 9)	43052-002	
CIRCLIP (Ref # 10)	92033-1001	
BOOT (Ref # 11)	49006-1030	
CALIPER A (Ref # 12)	43042-1025	
CALIPER A (Ref # 12)	43042-1025	
BOOT,OUTER (Ref # 13)	49006-1029	
SPRING,RETURN (Ref # 14)	43018-1001	
PLUG (Ref # 15)	92066-1001	
NUT 8MM (Ref # 16)	318B0800	
REPAIR SET,CALIPER (Ref # 17)	99996-5001	
BALL STEEL 1/4' (Ref # 18)	600A0800	
LEVER (Ref # 19)	11034-1439	
PIN (Ref # 20)	92043-1058	
PIN COTTER 1.6X10 (Ref # 21)	550D1610	
STOPPER (Ref # 22)	43022-1004	
SHAFT (Ref # 23)	43045-1003	
STOPPER (Ref # 24)	43022-1005	
REPAIR SET,CALIPER (Ref # 25)	99996-5002	
RATCHET (Ref # 26)	13078-1002	
ROD (Ref # 27)	46102-1003	

# 1978 KZ200-A1A PARTS LIST

## FRONT BRAKE

ITEM NAME	PART NUMBER	QUANTITY
BOLT (Ref # 28)	92007-032	
WASHER SPRING 10MM (Ref # 29)	461F1000	
WASHER PLAIN 10MM (Ref # 30)	410B1000	
DISC PLATE, FROM BRAKE (Ref # 31)	41080-013	