

# 1976 KE175 PARTS DIAGRAM

## OIL PUMP

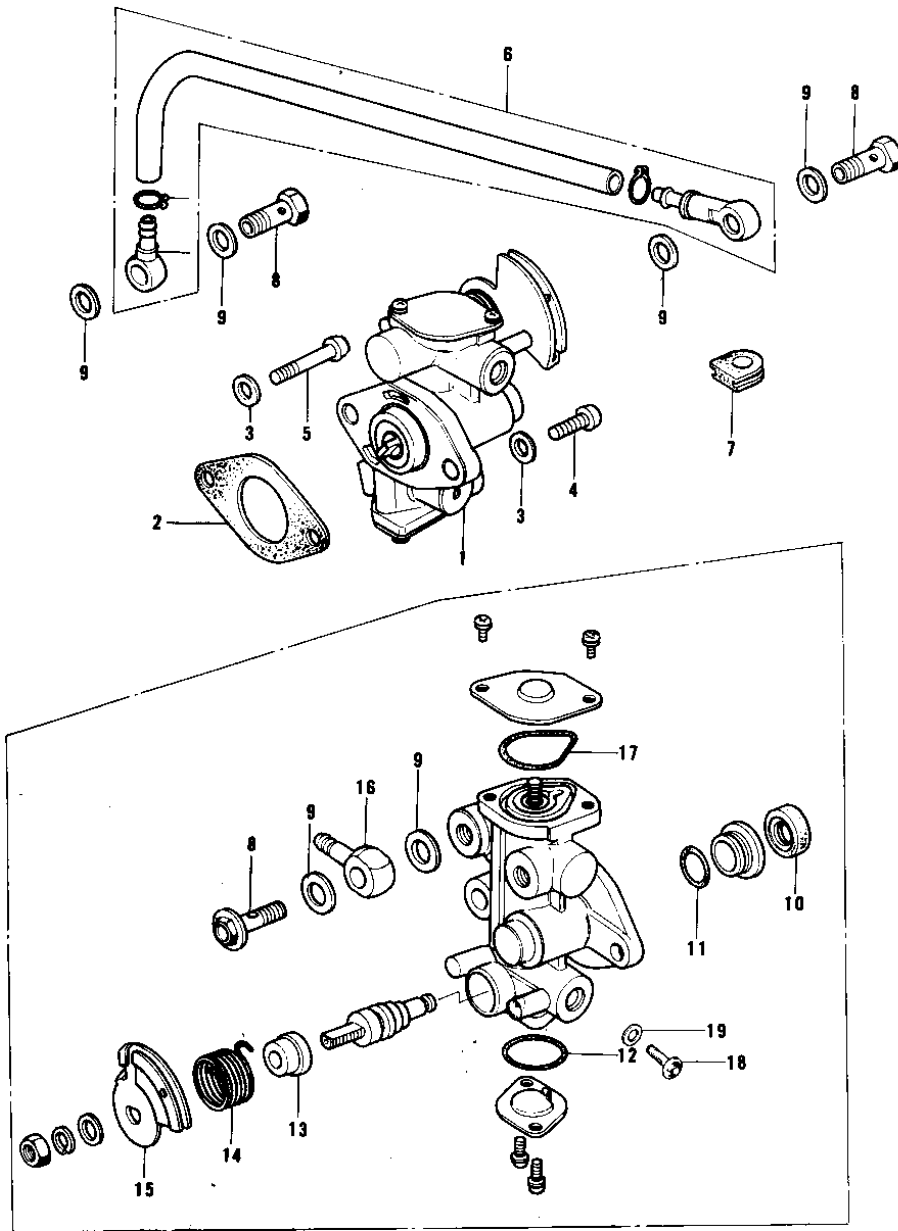

# 1976 KE175 PARTS LIST

## OIL PUMP

ITEM NAME	PART NUMBER	QUANTITY
OIL PUMP ASSY (Ref # 1)	16082-068	1
OIL PUMP ASSY (Ref # 1)	16082-068	1
GASKET,OIL PUMP (Ref # 2)	11060-1160	1
WASHER OIL PUMP (Ref # 3)	92022-037	2
SCREW-PAN-CROS (Ref # 4)	220B0514	1
SCREW PAN CROSS,5X28 (Ref # 5)	220B0528	1
PIPE ASSY,OIL (Ref # 6)	16134-028	1
GROMMET,OIL PUMP (Ref # 7)	92071-091	1
BOLT-BANJO,6MM (Ref # 8)	92060-013	3
WASHER OIL PUMP BANJO (Ref # 9)	92022-077	6
OIL SEAL OIL PUMP SHT (Ref # 10)	16091-001	1
"O" RING,OIL PUMP SHT (Ref # 11)	16090-002	1
"O" RING,LOWER CAP (Ref # 12)	16090-003	1
"O" RING,LOWER CAP (Ref # 12)	16090-004	1
SEAL-OIL,CAMSHAFT,"X" (Ref # 13)	92049-1294	1
SPRING OIL PUMP LEVER (Ref # 14)	16093-004	1
LEVER-OIL PUMP CABLE (Ref # 15)	16096-007	1
CONNECTOR BANJO (Ref # 16)	92061-009	1
"O" RING,UPPER CAP (Ref # 17)	16088-002	1
BOLT,AIR VENT (Ref # 18)	92009-1010	1
WASHER (Ref # 19)	92022-1006	1