

1978 KD175-A3 PARTS DIAGRAM

CABLES

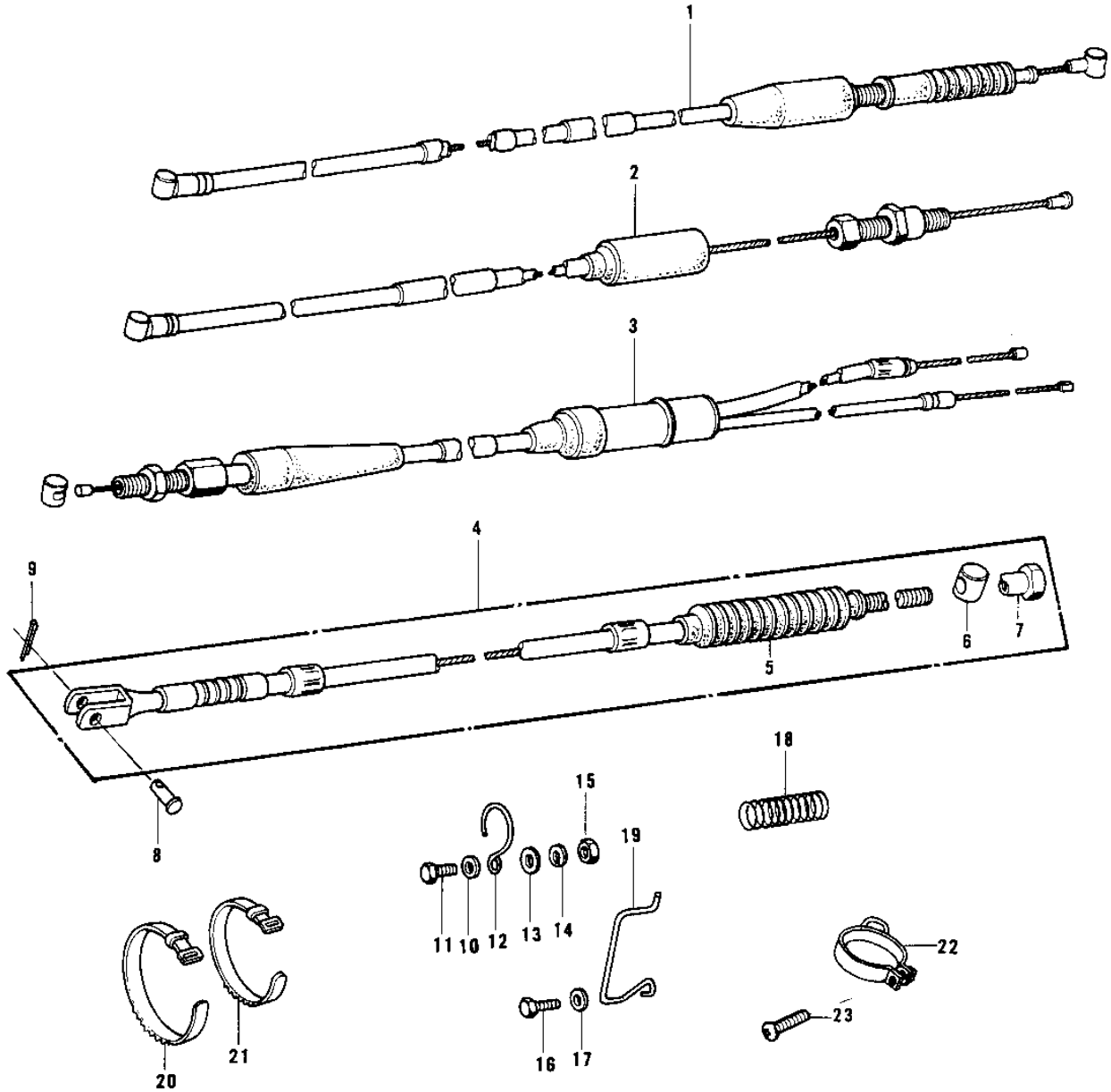

1978 KD175-A3 PARTS LIST

CABLES

| ITEM NAME | PART NUMBER | QUANTITY |
|----------------------------------|-------------|----------|
| CABLE,FRONT BRAKE (Ref # 1) | 54005-079 | |
| CABLE,CLUTCH (Ref # 2) | 54011-084 | |
| CABLE,CONTROL (Ref # 3) | 54012-130 | |
| CABLE,REAR BRAKE (Ref # 4) | 54022-028 | |
| DUST COVER-BRKE CABLE (Ref # 5) | 54009-007 | |
| PIN BRAKE ROD (Ref # 6) | 92043-053 | |
| NUT-BRAKE CABLE ADJST (Ref # 7) | 92015-041 | |
| PIN (Ref # 8) | 92043-125 | |
| PIN COTTER 2.0X15 (Ref # 9) | 550D2015 | |
| WASHER PLAIN 6MM (Ref # 10) | 410B0600 | |
| BOLT-UPSET (Ref # 11) | 112G0618 | |
| CLAMP,CABLE (Ref # 12) | 92037-092 | |
| WASHER PLAIN 6MM (Ref # 13) | 411B0600 | |
| WASHER SPRING 6MM (Ref # 14) | 461F0600 | |
| NUT 6MM (Ref # 15) | 311B0600 | |
| BOLT-UPSET,6X12 (Ref # 16) | 112G0612 | |
| WASHER PLAIN 6MM (Ref # 17) | 411B0600 | |
| SPRING,COIL (Ref # 18) | 54025-004 | |
| CLAMP,CABLE (Ref # 19) | 92037-175 | |
| BAND,LONG (Ref # 20) | 92072-032 | |
| BAND,SHORT (Ref # 21) | 92072-030 | |
| CLAMP,FRONT BRK CABLE (Ref # 22) | 92037-197 | |
| SCREW PAN HEAD 6X20 (Ref # 23) | 220B0620 | |