

1979 KD175-A4 PARTS DIAGRAM

SWING ARM/SHOCK ABSORBERS

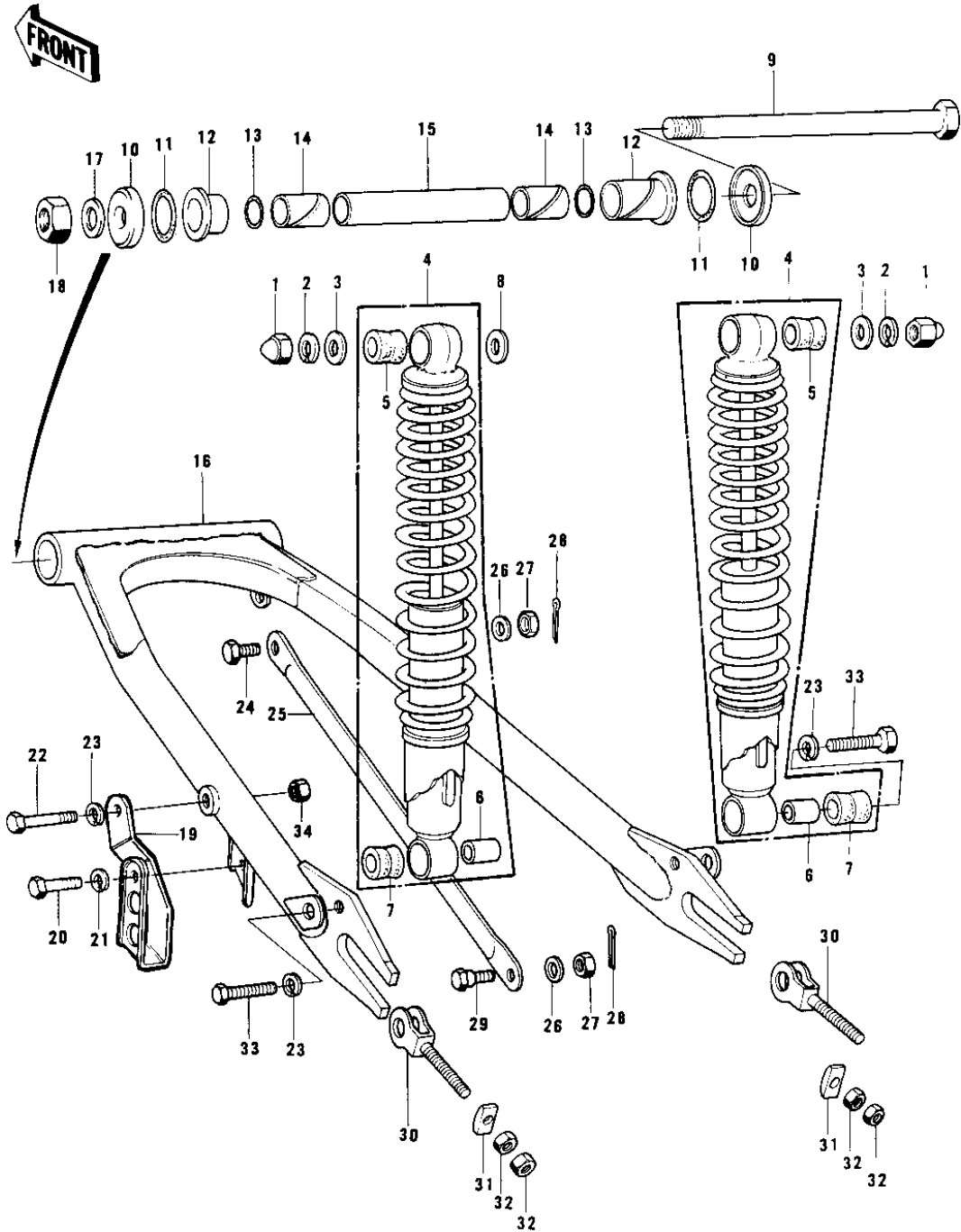

1979 KD175-A4 PARTS LIST

SWING ARM/SHOCK ABSORBERS

| ITEM NAME | PART NUMBER | QUANTITY |
|----------------------------------|-------------|----------|
| NUT SHOCK ABSORBER (Ref # 1) | 92020-003 | |
| WASHER SPRING 10MM (Ref # 2) | 461F1000 | |
| WASHER-PL-10.5X26X2.3 (Ref # 3) | 92022-044 | |
| SHOCK ABSBR RR (Ref # 4) | 45014-113 | |
| SHOCK ABSBR RR (Ref # 4) | 45014-1017 | |
| BUSH A-SHCK ABS RUBER (Ref # 5) | 45017-010 | |
| BUSHING,RUBBER (Ref # 6) | 92075-1020 | |
| BUSH SHCK ABS PVT SFT (Ref # 7) | 45016-003 | |
| WASHER PLAIN 12MM (Ref # 8) | 410B1200 | |
| SHAFT-SWING ARM PIVOT (Ref # 9) | 33032-034 | |
| CAP-SWINGING ARM (Ref # 10) | 33035-005 | |
| "0" RING,30MM (Ref # 11) | 671B2530 | |
| BUSHING-SWING ARM (Ref # 12) | 33033-009 | |
| "0" RING,16MM (Ref # 13) | 670B2016 | |
| "0" RING,16MM (Ref # 13) | 92055-001 | |
| SLEEVE-SWINGING ARM (Ref # 14) | 33034-016 | |
| COLLAR,SWING ARM,LONG (Ref # 15) | 33036-007 | |
| ARM,SWING (Ref # 16) | 33001-085 | |
| SWING ARM (Ref # 16) | 33001-080 | |
| WASHER PLAIN 12MM (Ref # 17) | 410B1200 | |
| NUT-LOCK,12MM (Ref # 18) | 92019-009 | |
| GUARD,CHAIN (Ref # 19) | 55020-016 | |
| BOLT-SMALL-UPSET,8X16 (Ref # 20) | 115G0816 | |
| WASHER SPRING 8MM (Ref # 21) | 461F0800 | |
| BOLT,HEX HEAD,10X50 (Ref # 22) | 92001-1254 | |
| WASHER SPRING 10MM (Ref # 23) | 461F1000 | |
| BOLT,HEX HEAD,AX24 (Ref # 24) | 92003-143 | |
| TORQUE LINK,REAR BRK (Ref # 25) | 43007-039 | |
| WASHER SPRING 8MM (Ref # 26) | 461F0800 | |

1979 KD175-A4 PARTS LIST

SWING ARM/SHOCK ABSORBERS

| ITEM NAME | PART NUMBER | QUANTITY |
|---------------------------------|-------------|----------|
| NUT,8MM (Ref # 27) | 320B0800 | |
| PIN COTTER 2.0X20 (Ref # 28) | 550D2020 | |
| BOLT,RR TORQUE LINK (Ref # 29) | 92003-144 | |
| ADJUSTER,CHAIN (Ref # 30) | 33040-073 | |
| PLATE,CHAIN ADJUSTER (Ref # 31) | 33041-005 | |
| NUT,8MM (Ref # 32) | 311B0800 | |
| BOLT HEX HEAD 10X35 (Ref # 33) | 113N1035 | |
| NUT,10MM (Ref # 34) | 314B1000 | |