

1973 F7-B PARTS DIAGRAM

HEADLIGHT ('71-'73 F7/F7-A/F7-B)

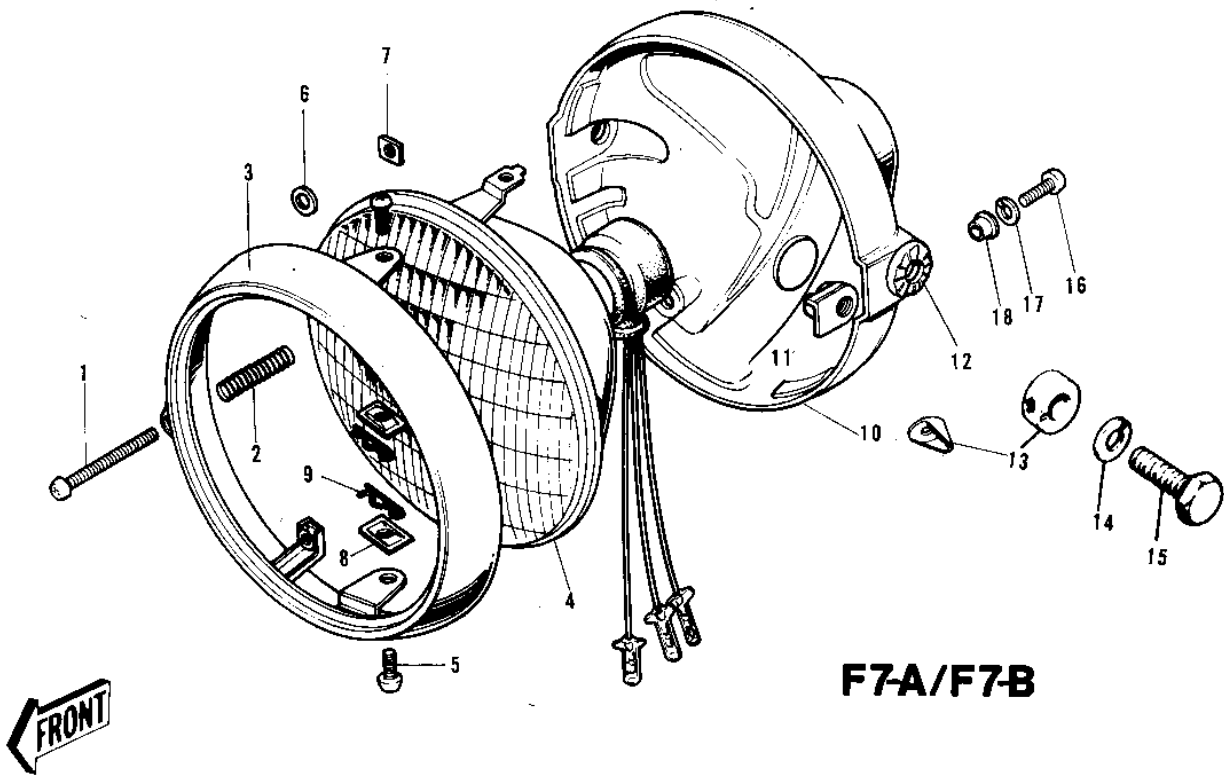
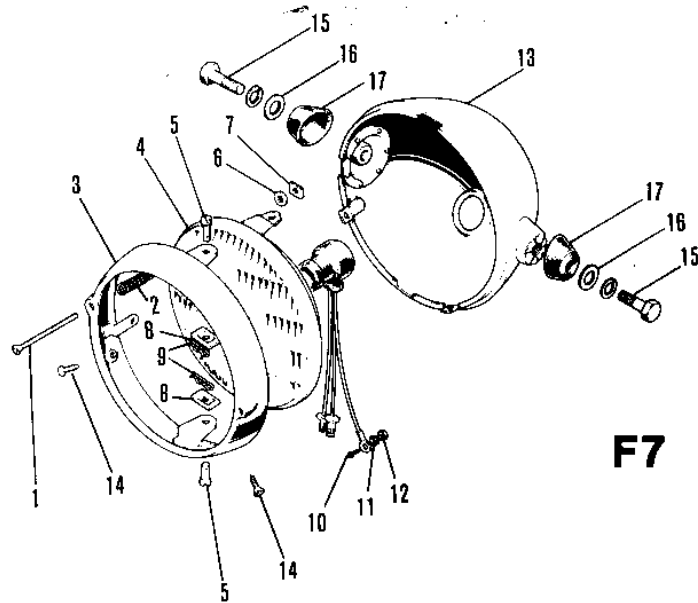

1973 F7-B PARTS LIST

HEADLIGHT ('71-'73 F7/F7-A/F7-B)

ITEM NAME	PART NUMBER	QUANTITY
LAMP UNIT-HEAD (Ref # 1~9)	23003-008	1
SCREW FORCUS ADJUST (Ref # 1)	23019-021	2
SPRING FOCUS ADJUST (Ref # 2)	23014-005	2
RIM HEAD LAMP (Ref # 3)	23006-014	1
SEALED BEAM UNIT (Ref # 4)	23007-022	1
SCREW LENS UNIT FITT (Ref # 5)	23019-018	2
WASHER (Ref # 6)	23021-004	2
NUT (Ref # 7)	23020-016	2
NUT LENS UNIT FITTING (Ref # 8)	23020-009	2
PIN LENS UNIT FITTING (Ref # 9)	23022-001	2
SCREW-PAN-HEAD 3X6 (Ref # 10)	220B0306	1
WASHER SPRING 3MM (Ref # 11)	461F0300	1
NUT-HEX (Ref # 12)	311B0300	1
BODY-HEAD LAMP, BLACK (Ref # 13)	23005-022-21	1
SCREW OVL CNTSNK 5X10 (Ref # 14)	222E0510	1
BOLT, HEX HEAD, 10X25 (Ref # 15)	92007-045	1
WASHER PLAIN 10MM (Ref # 16)	411B1000	1
DAMPER RUBBER (Ref # 17)	92075-058	1
LAMP UNIT-HEAD (Ref # 1~9)	23003-015	1
RIM-HEAD LAMP (Ref # 3)	23006-028	1
LENS UNIT-HEAD LAMP (Ref # 4)	23007-032	1
BODY-HEAD LAMP, BLACK (Ref # 10)	23005-034-10	1
NUT (Ref # 11)	23020-017	1
WASHER-LOCK (Ref # 12)	23021-011	1
DAMPER RUBBER (Ref # 13)	92075-079	1
DAMPER RUBBER (Ref # 13)	92075-134	1
WASHER SPRING 10MM (Ref # 14)	461F1000	1
BOLT, 10MM (Ref # 15)	92007-024	1
SCREW-PAN HEAD, 5MM (Ref # 16)	92011-024	1

1973 F7-B PARTS LIST

HEADLIGHT ('71-'73 F7/F7-A/F7-B)

ITEM NAME	PART NUMBER	QUANTITY
WASHER SPRING 5MM (Ref # 17)	461F0500	1
WASHER (Ref # 18)	23021-010	1