

1972 F7-A PARTS DIAGRAM

HEADLIGHT ('71-'73 F7/F7-A/F7-B)

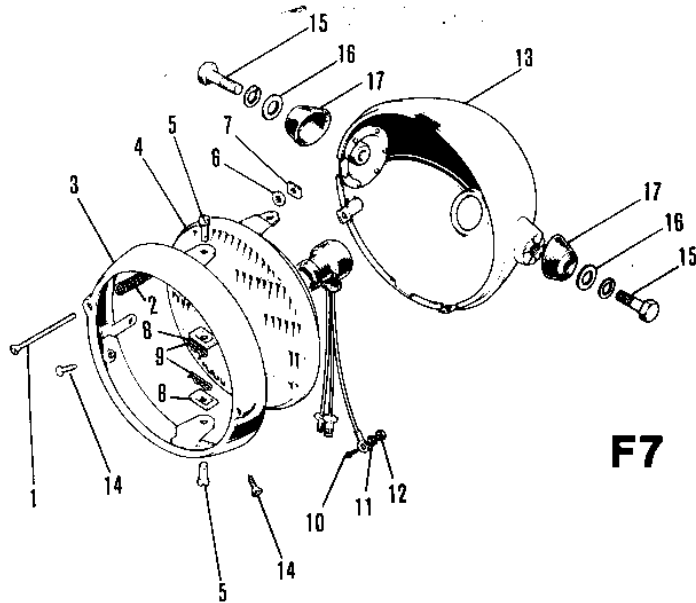

F7

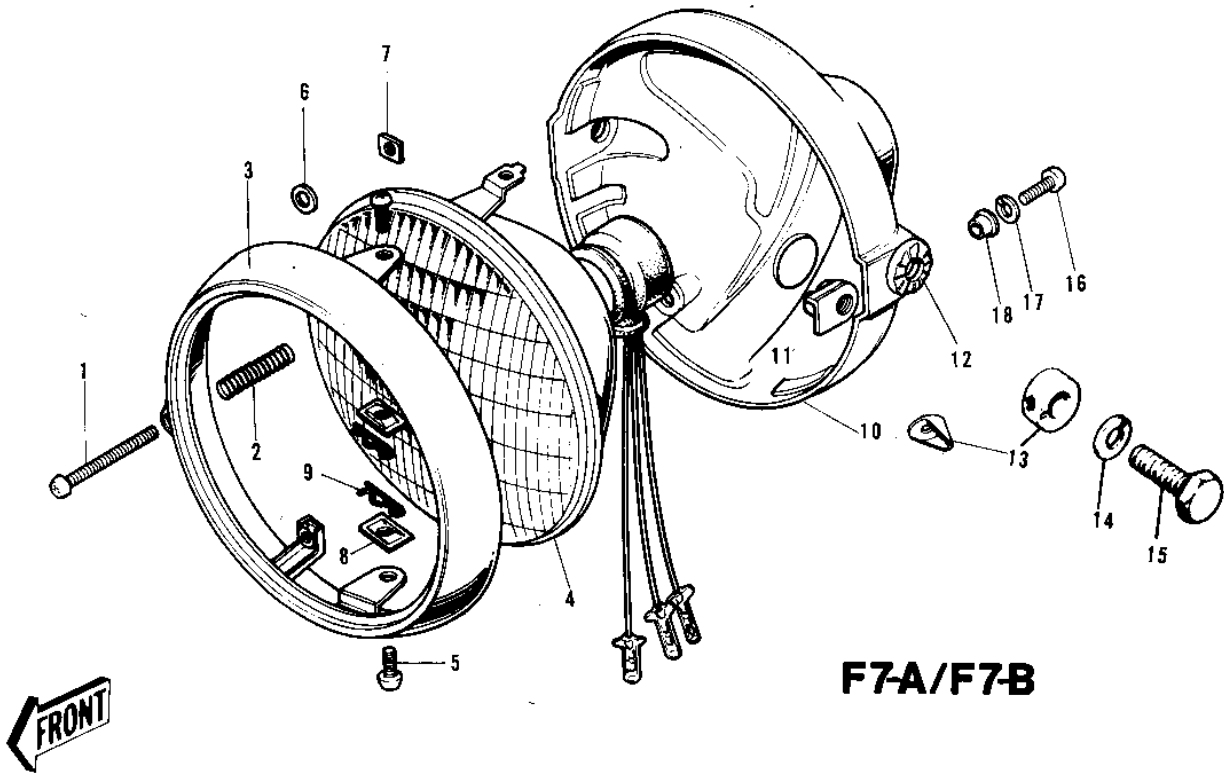

F7-A/F7-B

FRONT 

1972 F7-A PARTS LIST

HEADLIGHT ('71-73 F7/F7-A/F7-B)

ITEM NAME	PART NUMBER	QUANTITY
LAMP UNIT-HEAD (Ref # 1~9)	23003-008	
SCREW FORCUS ADJUST (Ref # 1)	23019-021	
SPRING FOCUS ADJUST (Ref # 2)	23014-005	
RIM HEAD LAMP (Ref # 3)	23006-014	
SEALED BEAM UNIT (Ref # 4)	23007-022	
SCREW LENS UNIT FITT (Ref # 5)	23019-018	
WASHER (Ref # 6)	23021-004	
NUT (Ref # 7)	23020-016	
NUT LENS UNIT FITTING (Ref # 8)	23020-009	
PIN LENS UNIT FITTING (Ref # 9)	23022-001	
SCREW-PAN-HEAD 3X6 (Ref # 10)	220B0306	
WASHER SPRING 3MM (Ref # 11)	461F0300	
NUT-HEX (Ref # 12)	311B0300	
BODY-HEAD LAMP,BLACK (Ref # 13)	23005-022-21	
SCREW OVL CNTSNK 5X10 (Ref # 14)	222E0510	
BOLT,HEX HEAD,10X25 (Ref # 15)	92007-045	
WASHER PLAIN 10MM (Ref # 16)	411B1000	
DAMPER RUBBER (Ref # 17)	92075-058	
LAMP UNIT-HEAD (Ref # 1~9)	23003-015	
SCREW FORCUS ADJUST (Ref # 1)	23019-021	
SPRING FOCUS ADJUST (Ref # 2)	23014-005	
RIM-HEAD LAMP (Ref # 3)	23006-028	
LENS UNIT-HEAD LAMP (Ref # 4)	23007-032	
SCREW LENS UNIT FITT (Ref # 5)	23019-018	
WASHER (Ref # 6)	23021-004	
NUT (Ref # 7)	23020-016	
NUT LENS UNIT FITTING (Ref # 8)	23020-009	
PIN LENS UNIT FITTING (Ref # 9)	23022-001	
BODY-HEAD LAMP,BLACK (Ref # 10)	23005-034-10	

1972 F7-A PARTS LIST

HEADLIGHT ('71-'73 F7/F7-A/F7-B)

ITEM NAME	PART NUMBER	QUANTITY
NUT (Ref # 11)	23020-017	
WASHER-LOCK (Ref # 12)	23021-011	
DAMPER RUBBER (Ref # 13)	92075-079	
DAMPER RUBBER (Ref # 13)	92075-134	
WASHER SPRING 10MM (Ref # 14)	461F1000	
BOLT,10MM (Ref # 15)	92007-024	
SCREW-PAN HEAD,5MM (Ref # 16)	92011-024	
WASHER SPRING 5MM (Ref # 17)	461F0500	
WASHER (Ref # 18)	23021-010	