

1976 KE125 PARTS DIAGRAM

SEAT/CHAIN COVER/CHAIN (76-'79)

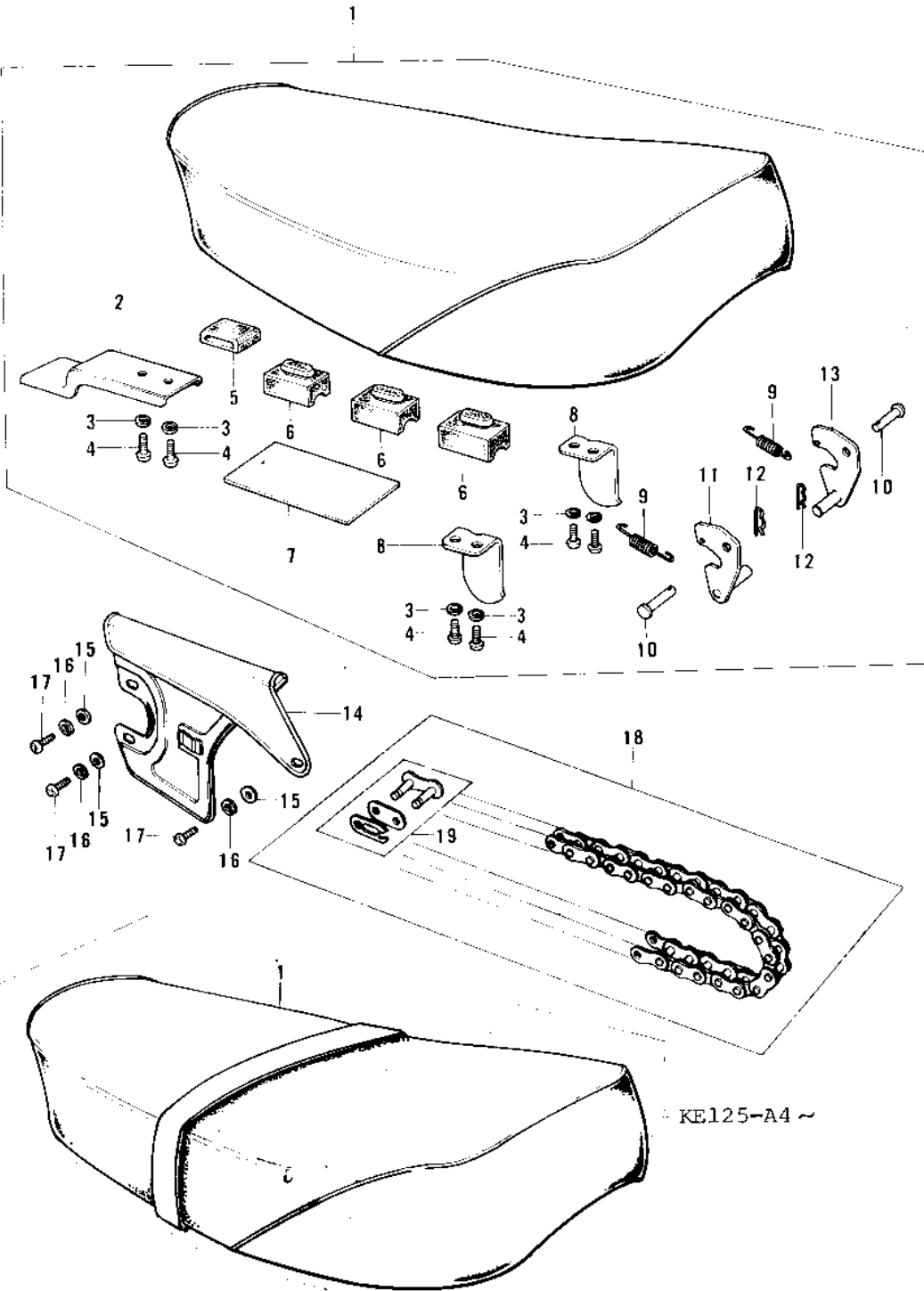

Ref.



- 1
- 1
- 1
- 1
- 1
- 1
- 1
- 1
- 1
- 1
- 1

1976 KE125 PARTS LIST

SEAT/CHAIN COVER/CHAIN ('76-'79)

| ITEM NAME | PART NUMBER | QUANTITY |
|---------------------------------|--------------|----------|
| SEAT ASSY,DUAL (Ref # 1) | 53002-068 | 1 |
| SEAT-ASSY,DUAL (Ref # 1) | 53001-1033 | 1 |
| SEAT-ASSY,DUAL (Ref # 1) | 53001-1033 | 1 |
| BRACKET,DUAL SEAT (Ref # 2) | 53032-005 | 1 |
| WASHER SPRING 6MM (Ref # 3) | 461F0600 | 6 |
| SCREW PAN HEAD 6X14 (Ref # 4) | 220B0614 | 6 |
| DAMPER RUBBER,SEAT (Ref # 5) | 92075-219 | 1 |
| DAMPER RUBBER,SEAT (Ref # 6) | 92075-216 | 6 |
| DAMPER RUBBER,BATTERY (Ref # 7) | 92075-224 | 1 |
| STOPPER,SEAT (Ref # 8) | 53059-001 | 2 |
| SPRING,HOOK (Ref # 9) | 53012-013 | 2 |
| PIN DUAL SEAT PIVOT (Ref # 10) | 53011-001 | 2 |
| HOOK,SEAT,L.H (Ref # 11) | 53008-028 | 1 |
| COTTER PIN (Ref # 12) | 92041-003 | 2 |
| HOOK,SEAT,R.H (Ref # 13) | 53008-029 | 1 |
| CASE-CHAIN,FR BLACK (Ref # 14) | 36014-051-21 | 1 |
| WASHER PLAIN (Ref # 15) | 92022-024 | 3 |
| WASHER SPRING 6MM (Ref # 16) | 461F0600 | 3 |
| SCREW PAN HEAD 6X14 (Ref # 17) | 220B0614 | 3 |
| DR CHAIN 428X118H (Ref # 18) | 92057-030 | 1 |
| JOINT-CHAIN (Ref # 19) | 92058-1015 | 1 |