

# 1976 KE125 PARTS DIAGRAM

CRANKCASE ('76-'79)

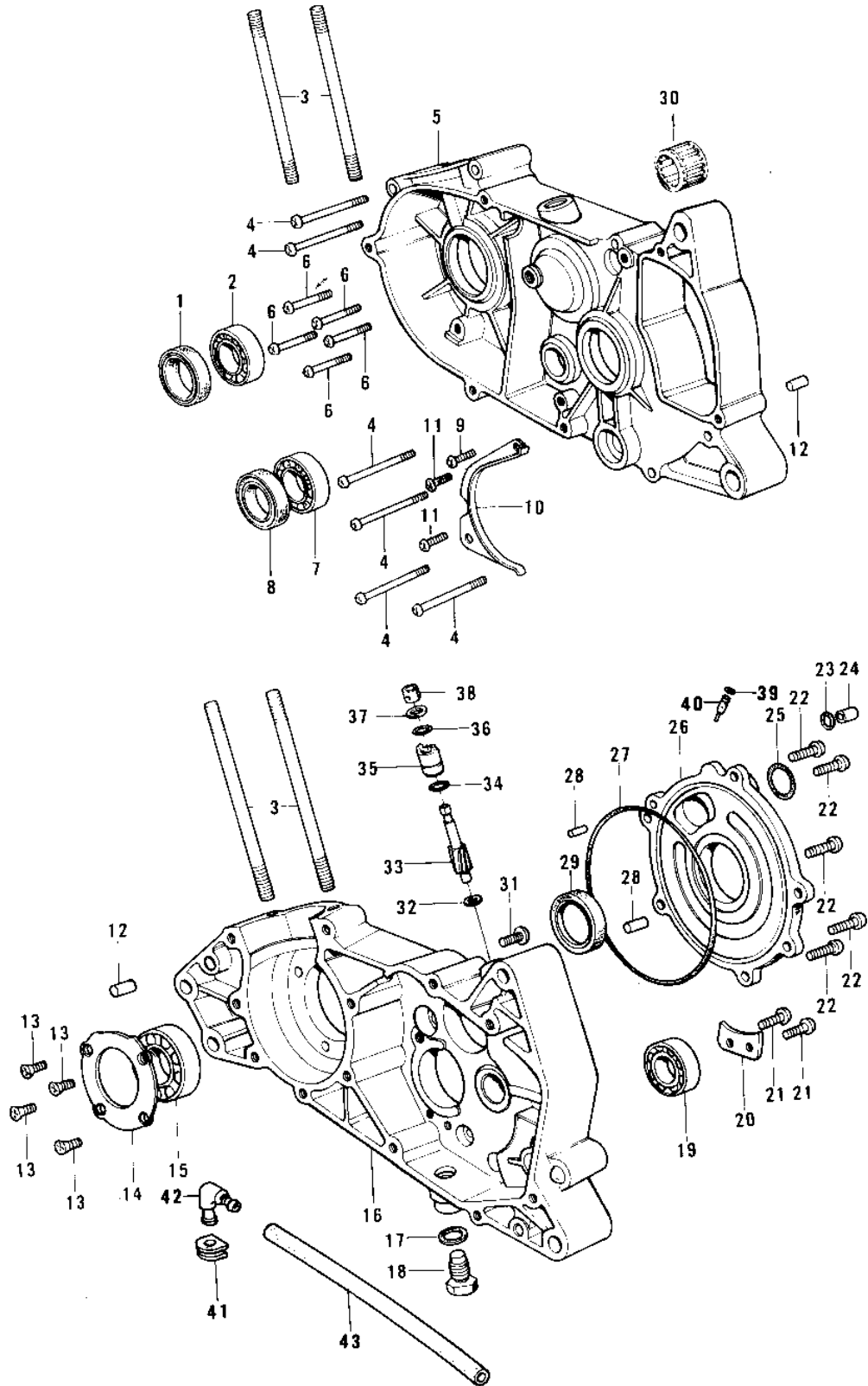

# 1976 KE125 PARTS LIST

CRANKCASE ('76-'79)

| ITEM NAME                        | PART NUMBER   | QUANTITY |
|----------------------------------|---------------|----------|
| SEAL-OIL (Ref # 1)               | 92049-1240    | 1        |
| BEARING BALL #6204 (Ref # 2)     | 601B6204      | 1        |
| STUD,8X70 (Ref # 3)              | 172G0870      | 4        |
| SCREW PAN HEAD 6X80 (Ref # 4)    | 220B0680      | 6        |
| SET-CRANKCASE,F.BLACK (Ref # 5)  | 14001-5149    | 1        |
| SET-CRANKCASE,F.BLACK (Ref # 5)  | 14001-5138    | 1        |
| SCREW PAN HEAD 6X40 (Ref # 6)    | 220B0640      | 5        |
| BEARING BALL #6004 (Ref # 7)     | 601B6004      | 1        |
| OIL SEAL SC25376 (Ref # 8)       | 92050-013     | 1        |
| SCREW PAN HEAD 6X20 (Ref # 9)    | 220B0620      | 1        |
| GUIDE,CHAIN (Ref # 10)           | 14077-003     | 1        |
| SCREW PAN HEAD 6X12 (Ref # 11)   | 220B0612      | 2        |
| PIN,DOWEL,10X14 (Ref # 12)       | 92043-1037    | 4        |
| PIN,DOWEL,10X14 (Ref # 12)       | 552B1014      | 4        |
| SCREW CNTSNK HD 6X16 (Ref # 13)  | 221B0616      | 4        |
| PLATE,CRANK BEARING (Ref # 14)   | 14014-028     | 1        |
| BEARING BALL #6304 (Ref # 15)    | 601B6304      | 1        |
| CRANKCASE,R.H.,BLACK (Ref # 16)  | 14002-1040-21 | 1        |
| SET-CRANKCASE,F.BLACK (Ref # 16) | 14001-5138    | 1        |
| GASKET-DRAIN PLUG (Ref # 17)     | 92065-073     | 1        |
| PLUG (Ref # 18)                  | 92066-1240    | 1        |
| BEARING BALL #6203 (Ref # 19)    | 601B6203      | 1        |
| PLATE,MISSION BERNG (Ref # 20)   | 14014-029     | 1        |
| SCREW PAN HEAD 6X12 (Ref # 21)   | 220B0612      | 2        |
| SCREW PAN HEAD 5X20 (Ref # 22)   | 220B0520      | 5        |
| "O" RING,8MM (Ref # 23)          | 92055-029     | 1        |
| PIN DOWEL 8X16 (Ref # 24)        | 92042-017     | 1        |
| PIN,DOWEL (Ref # 24)             | 92042-037     | 1        |
| "O" RING,28MM (Ref # 25)         | 670B3028      | 1        |

## 1976 KE125 PARTS LIST

CRANKCASE ('76-'79)

| ITEM NAME                        | PART NUMBER | QUANTITY |
|----------------------------------|-------------|----------|
| COVER ASY,ROTARY VLV (Ref # 26)  | 14019-054   | 1        |
| COVER,ROTARY DISC (Ref # 26)     | 14019-055   | 1        |
| "O" RING,VALVE COVER (Ref # 27)  | 92055-057   | 1        |
| PIN DOWEL 5X12 (Ref # 28)        | 610A0512    | 2        |
| SEAL-OIL (Ref # 29)              | 92049-1250  | 1        |
| BEARING,NEEDLE (Ref # 30)        | 92046-043   | 1        |
| SCREW PAN HEAD 6X25 (Ref # 31)   | 220B0625    | 1        |
| WASHER,THRUST (Ref # 32)         | 92026-094   | 1        |
| GEAR,TACHOMETER (Ref # 33)       | 13223-007   | 1        |
| GASKET,FUEL TAP JOINT (Ref # 34) | 11009-1567  | 1        |
| BUSHING (Ref # 35)               | 92028-136   | 1        |
| "O" RING (Ref # 36)              | 92055-060   | 1        |
| WASHER,PLAIN (Ref # 37)          | 92022-275   | 1        |
| BUSHING,TACHOMETER (Ref # 38)    | 92028-140   | 1        |
| "O" RING (Ref # 39)              | 92055-080   | 1        |
| NOZZLE (Ref # 40)                | 92062-012   | 1        |
| GROMMET (Ref # 41)               | 92071-042   | 1        |
| BREATHER ASSY (Ref # 42)         | 14069-1001  | 1        |
| BREATHER ASSY (Ref # 43)         | 14069-1001  | 1        |