

1979 KD125-A5 PARTS DIAGRAM

TRANSMISSION/CHANGE DRUM

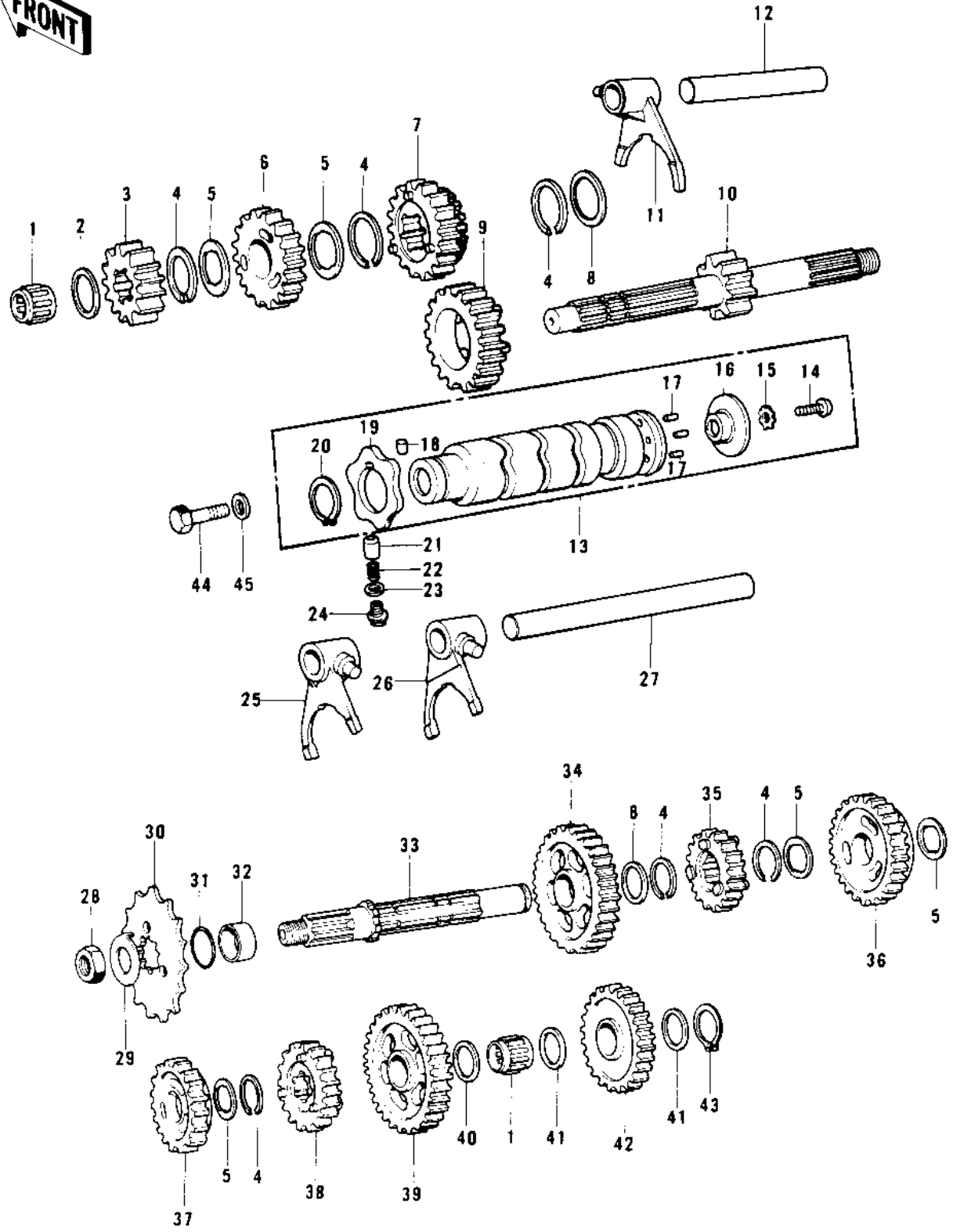

1979 KD125-A5 PARTS LIST

TRANSMISSION/CHANGE DRUM

| ITEM NAME | PART NUMBER | QUANTITY |
|----------------------------------|-------------|----------|
| BRG,N,7E-HK1412 (Ref # 1) | 92046-037 | |
| WASHER,PLAIN (Ref # 2) | 92022-272 | |
| 2ND GEAR,DRIVE SHAFT (Ref # 3) | 13130-036 | |
| CIRCLIP (Ref # 4) | 92033-028 | |
| WASHER,LOCK (Ref # 5) | 92024-055 | |
| TOP GEAR,DRIVE SHAFT (Ref # 6) | 13129-1019 | |
| TOP GEAR,DRIVE,SHAFT (Ref # 6) | 13129-1021 | |
| TOP GEAR,DRIVE,SHAFT (Ref # 6) | 13129-1021 | |
| 3RD/4TH GEAR,DRIVE SF (Ref # 7) | 13129-1008 | |
| 3RD&4TH GEAR,DRIVE SF (Ref # 7) | 13129-1010 | |
| 3RD&4TH GEAR,DRIVE SF (Ref # 7) | 13129-1010 | |
| WASHER,PLAIN (Ref # 8) | 92022-271 | |
| 5TH GEAR,DRIVE SHAFT (Ref # 9) | 13129-1016 | |
| 5TH GEAR,DRIVE SHAFT (Ref # 9) | 13129-1018 | |
| 5TH GEAR,DRIVE SHAFT (Ref # 9) | 13129-1018 | |
| SHAFT,DRIVE (Ref # 10) | 13127-045 | |
| FORK,SELECTOR,5TH&TOP (Ref # 11) | 13140-060 | |
| RODSHIFT,SHORT (Ref # 12) | 13209-014 | |
| DRUM ASSY,GEAR SHIFT (Ref # 13) | 13239-018 | |
| SCREW PAN HEAD 6X14 (Ref # 14) | 220B0614 | |
| WASHER LOCK 6MM (Ref # 15) | 464H0600 | |
| PLTE,SHIFT DRUM PIN (Ref # 16) | 13142-017 | |
| PIN,GEAR CHNGE DRUM (Ref # 17) | 92042-030 | |
| PIN-DOWEL,4X6 (Ref # 18) | 610A0406 | |
| CAM-CHANGE DRUM (Ref # 19) | 13145-1058 | |
| CIRCLIP,30MM (Ref # 20) | 480J3000 | |
| PIN-NEUTRAL POSITION (Ref # 21) | 92043-076 | |
| SPRING (Ref # 22) | 92081-112 | |
| GASKET (Ref # 23) | 92065-090 | |

1979 KD125-A5 PARTS LIST

TRANSMISSION/CHANGE DRUM

| ITEM NAME | PART NUMBER | QUANTITY |
|----------------------------------|-------------|----------|
| BOLT,10MM (Ref # 24) | 92001-131 | |
| FORK,SELECTOR,2ND&3RD (Ref # 25) | 13140-059 | |
| FORK,SELECTOR,LOW&4TH (Ref # 26) | 13140-058 | |
| ROD-SHIFT,10X102 (Ref # 27) | 49047-1060 | |
| NUT 14MM (Ref # 28) | 315B1400 | |
| WASHER, (Ref # 29) | 92024-052 | |
| SPROCKET-OUTPUT,14T (Ref # 30) | 13144-1058 | |
| SPROCKET-OUTPUT,14T (Ref # 30) | 13144-1058 | |
| ENGINE SPROCKET,13T (Ref # 30) | 13144-053 | |
| ENGINE SPROCKET,12T (Ref # 30) | 13144-058 | |
| "0" RING (Ref # 31) | 92055-022 | |
| COLLAR,ENG SPROCKET (Ref # 32) | 92027-1077 | |
| SHAFT,OUTPUT (Ref # 33) | 13128-040 | |
| 2ND GEAR,OUTPUT SHAFT (Ref # 34) | 13131-043 | |
| TOP GEAR,OUTPUT SHAFT (Ref # 35) | 13137-029 | |
| TOP GEAR,OUTPUT SHAFT (Ref # 35) | 13137-043 | |
| 3RD GEAR,OUTPUT SHAFT (Ref # 36) | 13129-1011 | |
| 3RD GEAR,OUTPUT SHAFT (Ref # 36) | 13129-1011 | |
| 4TH GEAR OUTPUT SHAFT (Ref # 37) | 13129-1013 | |
| 4TH GEAR,OUTPUT SHAFT (Ref # 37) | 13129-1015 | |
| 4TH GEAR,OUTPUT SHAFT (Ref # 37) | 13129-1015 | |
| 5TH GEAR,OUTPUT SHAFT (Ref # 38) | 13248-001 | |
| 5TH GEAR,OUTPUT SHAFT (Ref # 38) | 13248-003 | |
| LOW GEAR,OUTPUT SHAFT (Ref # 39) | 13129-050 | |
| WASHER,PLAIN (Ref # 40) | 92022-273 | |
| WASHER,PLAIN (Ref # 41) | 92022-267 | |
| IDLE GEAR,KICKSTARTER (Ref # 42) | 13073-011 | |
| CIRCLIP,13MM (Ref # 43) | 480J1300 | |
| BOLT,HEX HEAD,10X14 (Ref # 44) | 113G1014 | |