

# 1976 KE100 PARTS DIAGRAM

MUFFLER

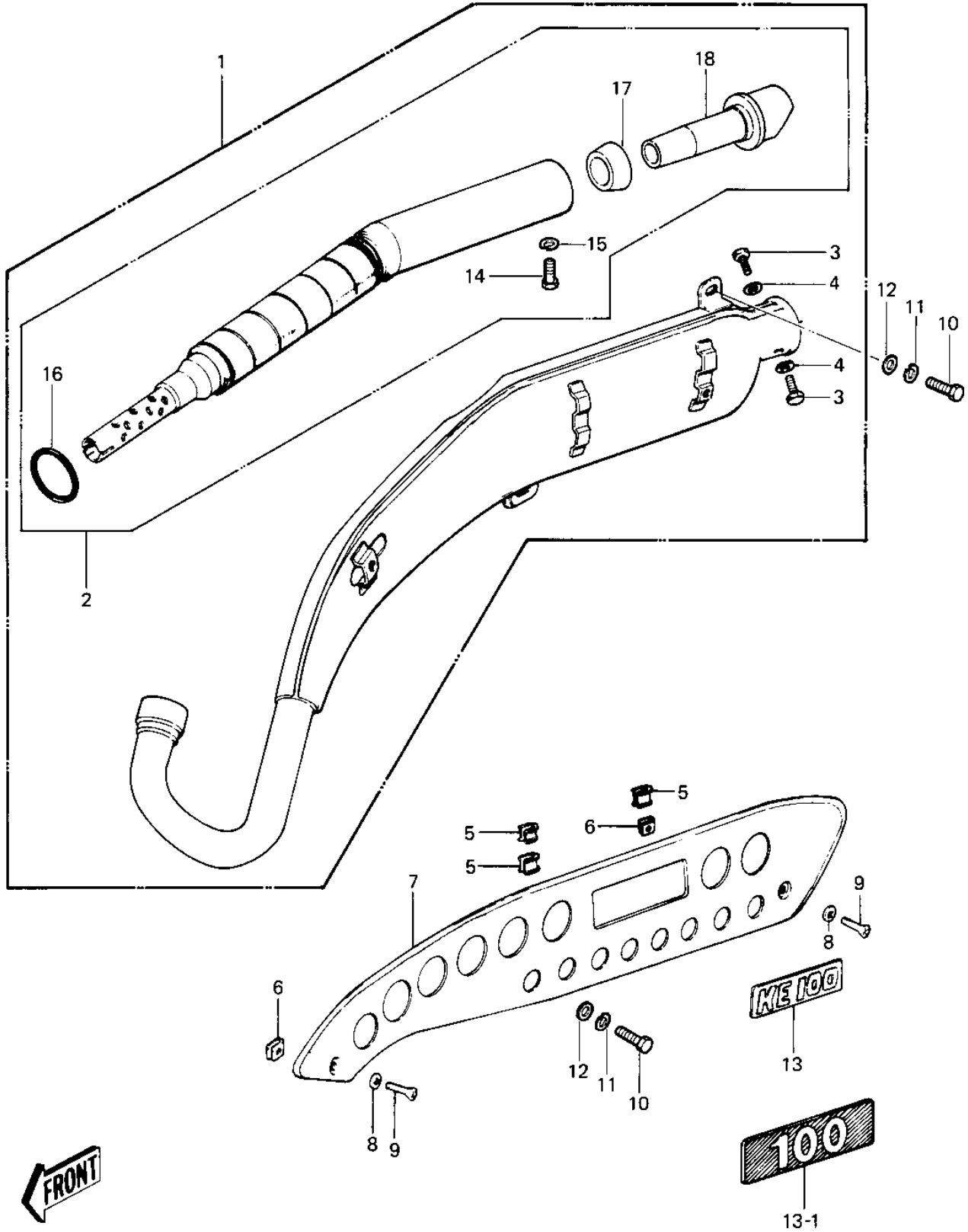

# 1976 KE100 PARTS LIST

## MUFFLER

| ITEM NAME                         | PART NUMBER | QUANTITY |
|-----------------------------------|-------------|----------|
| MUFFLER (Ref # 1)                 | 18001-1603  | 1        |
| MUFFLER (Ref # 1)                 | 18001-1603  | 1        |
| BAFFLE TUBE (Ref # 2)             | 18033-070   | 1        |
| BOLT-UPSET 6X14 (Ref # 3)         | 112B0614    | 2        |
| WASHER OIL PUMP BANJO (Ref # 4)   | 92022-077   | 2        |
| INSULATOR (Ref # 5)               | 18065-007   | 3        |
| INSULATOR-HEAT (Ref # 6)          | 18065-009   | 2        |
| COVER,MUFFLER (Ref # 7)           | 18057-047   | 1        |
| WASHER LOCK 6MM (Ref # 8)         | 463H0600    | 2        |
| SCREW PAN HEAD 6X12 (Ref # 9)     | 220E0612    | 2        |
| BOLT-SMALL-UPSET,8X16 (Ref # 10)  | 115G0816    | 2        |
| WASHER SPRING 8MM (Ref # 11)      | 461F0800    | 2        |
| WASHER PLAIN 8MM (Ref # 12)       | 411B0800    | 2        |
| EMBLEM,SIDE COVER (Ref # 13)      | 56018-222   | 1        |
| EMBLEM,MUFFLER COVER (Ref # 13-1) | 56018-1039  | 1        |
| BOLT-UPSET 6X14 (Ref # 14)        | 112B0614    | 1        |
| WASHER LOCK 6MM (Ref # 15)        | 464H0600    | 1        |
| 'O' RING (Ref # 16)               | 92093-1031  | 1        |
| BUSHING,RUBBER (Ref # 17)         | 92093-1009  | 1        |
| ARRESTOR CAP (Ref # 18)           | 59156-1005  | 1        |