

1975 G4TR-E PARTS DIAGRAM

MUFFLER (70-'73)

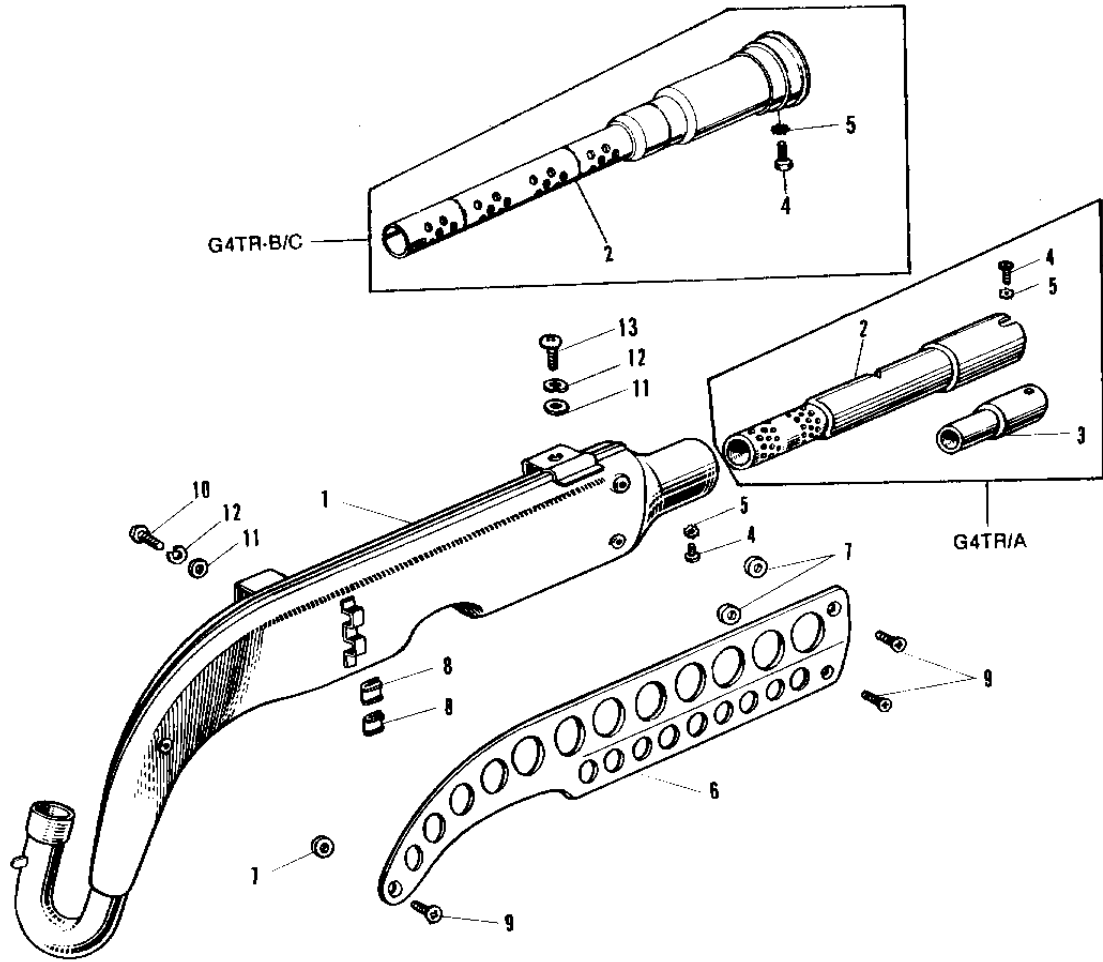

1975 G4TR-E PARTS LIST

MUFFLER ('70-'73)

| ITEM NAME | PART NUMBER | QUANTITY |
|----------------------------------|-------------|----------|
| MUFFLER ASSY (Ref # 1) | 18001-069 | 1 |
| MUFFLER ASSY (Ref # 1) | 18001-069 | 1 |
| SPARK ARRESTOR COMP (Ref # 2) | 18033-037 | 1 |
| BAFFLE TUBE (Ref # 2) | 18033-055 | 1 |
| BAFFLE TUBE (Ref # 3) | 18033-039 | 1 |
| BOLT,6X10 (Ref # 4) | 112G0610 | 2 |
| BOLT,6X10 (Ref # 4) | 112G0610 | 1 |
| WASHER LOCK 6MM (Ref # 5) | 464H0600 | 2 |
| WASHER LOCK 6MM (Ref # 5) | 464H0600 | 1 |
| COVER,MUFFLER (Ref # 6) | 18057-046 | 1 |
| COVER,MUFFLER (Ref # 6) | 18057-046 | 1 |
| COVER,MUFFLER (Ref # 6) | 18057-046 | 1 |
| INSULATOR (Ref # 7) | 18065-001 | 3 |
| INSULATOR (Ref # 8) | 18065-007 | 2 |
| SCREW PAN HEAD 6X10 (Ref # 9) | 221E0610 | 3 |
| BOLT-SMALL-UPSET,8X16 (Ref # 10) | 115G0816 | 1 |
| WASHER PLAIN 8MM (Ref # 11) | 410B0800 | 2 |
| WASHER SPRING 8MM (Ref # 12) | 461F0800 | 2 |
| SCREW-PAN HEAD,8X16 (Ref # 13) | 220B0816 | 1 |