

## 1970 Bushmaster PARTS DIAGRAM

OPTIONAL PARTS ('69-'73)

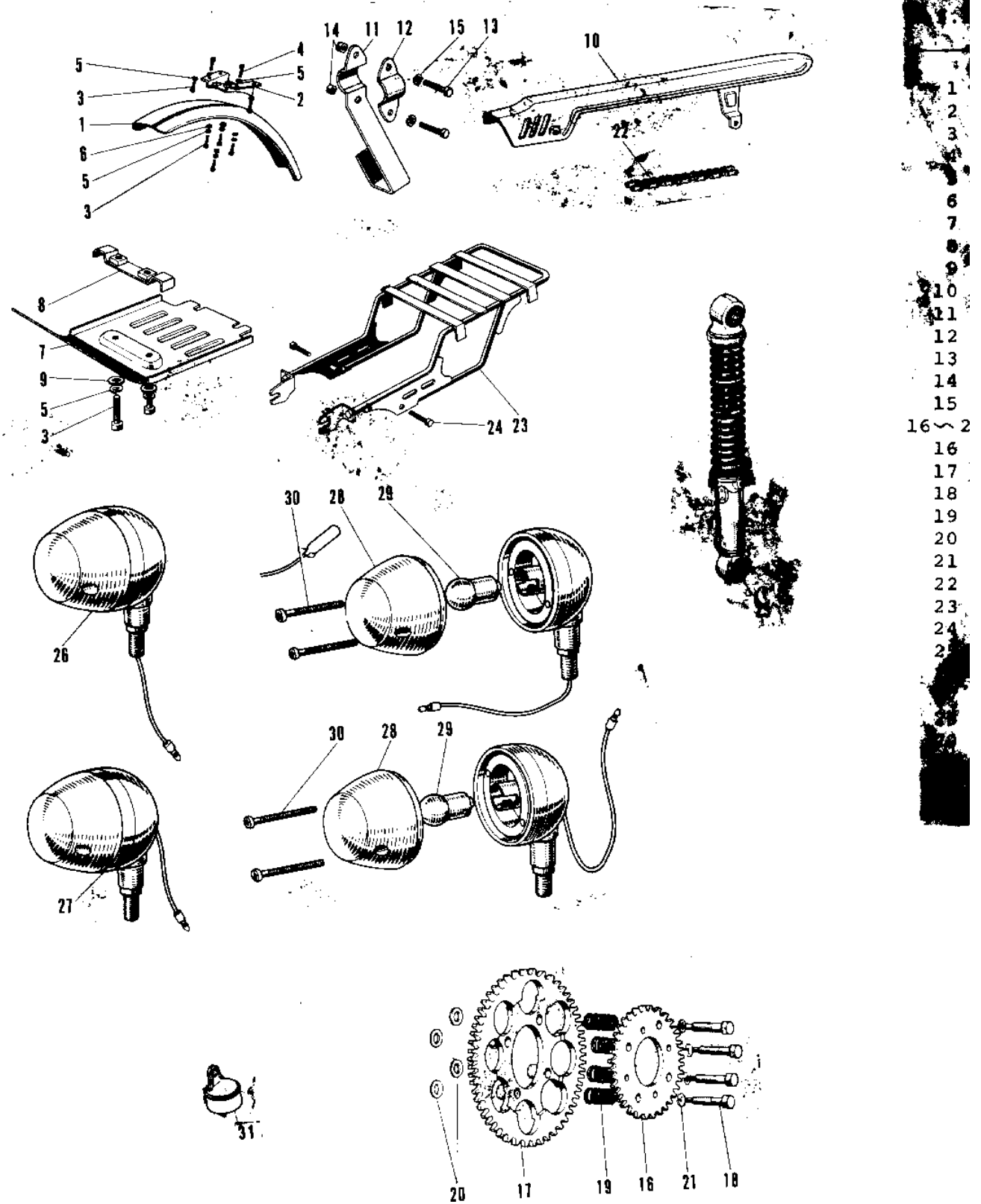

## 1970 Bushmaster PARTS LIST

OPTIONAL PARTS ('69-'73)

ITEM NAME	PART NUMBER	QUANTITY
FENDER-FR (Ref # 1)	35004-017	1
BRACKET FRONT FENDER (Ref # 2)	35012-004	1
BOLT-UPSET,6X12 (Ref # 3)	112G0612	1
BOLT 6X22 (Ref # 4)	112B0622	1
WASHER SPRING 6MM (Ref # 5)	461F0600	1
WASHER PLAIN 6MM (Ref # 6)	411B0600	1
GUARD ENGINE (Ref # 7)	55011-009	1
BRACKET ENGINE GUARD (Ref # 8)	55016-005	1
WASHER PLAIN 6MM (Ref # 9)	410B0600	1
CASE-CHAIN (Ref # 10)	36014-025	1
GUARD CHAIN (Ref # 11)	55020-001	1
STAY CHAIN GUARD (Ref # 12)	55021-001	1
BOLT,8X20 (Ref # 13)	115G0820	1
NUT,8MM (Ref # 14)	311B0800	1
WASHER SPRING 8MM (Ref # 15)	461F0800	1
DUAL SPROCKET ASSY (Ref # 16~21)	42040-004	1
REAR SPROCKET 37T (Ref # 16)	42041-020	1
REAR SPROCKET 59T (Ref # 17)	42041-021	1
BOLT REAR SPROCKET (Ref # 18)	92003-004	1
SPRING REAR SPROCKET (Ref # 19)	42042-002	1
WASHER REAR SPROCKET (Ref # 20)	92022-040	1
WASHER SPRING 10MM (Ref # 21)	461F1000	1
DR CHAIN 428X12 (Ref # 22)	695Y43012	1
CARRIER LUGGAGE (Ref # 23)	53029-028	1
BOLT HEX HEAD 8X63 (Ref # 24)	114B0863	1
SHOCK ABSBR RR (Ref # 25)	45014-036	1
LAMP FRNT TURN SIGNAL (Ref # 26)	23040-021	1
LAMP REAR TURN SIGNAL (Ref # 27)	23043-018	1
LENS TURN SIGNAL LAMP (Ref # 28)	23048-011	1

## 1970 Bushmaster PARTS LIST

OPTIONAL PARTS ('69-'73)

ITEM NAME	PART NUMBER	QUANTITY
BULB,6V 8W (Ref # 29)	92069-042	1
SCREW OVL CNTSNK 3X15 (Ref # 30)	222B0315A	1
RELAY TURN SIGNAL (Ref # 31)	27002-005	1