

1979 KX80 PARTS DIAGRAM

AIR CLEANER

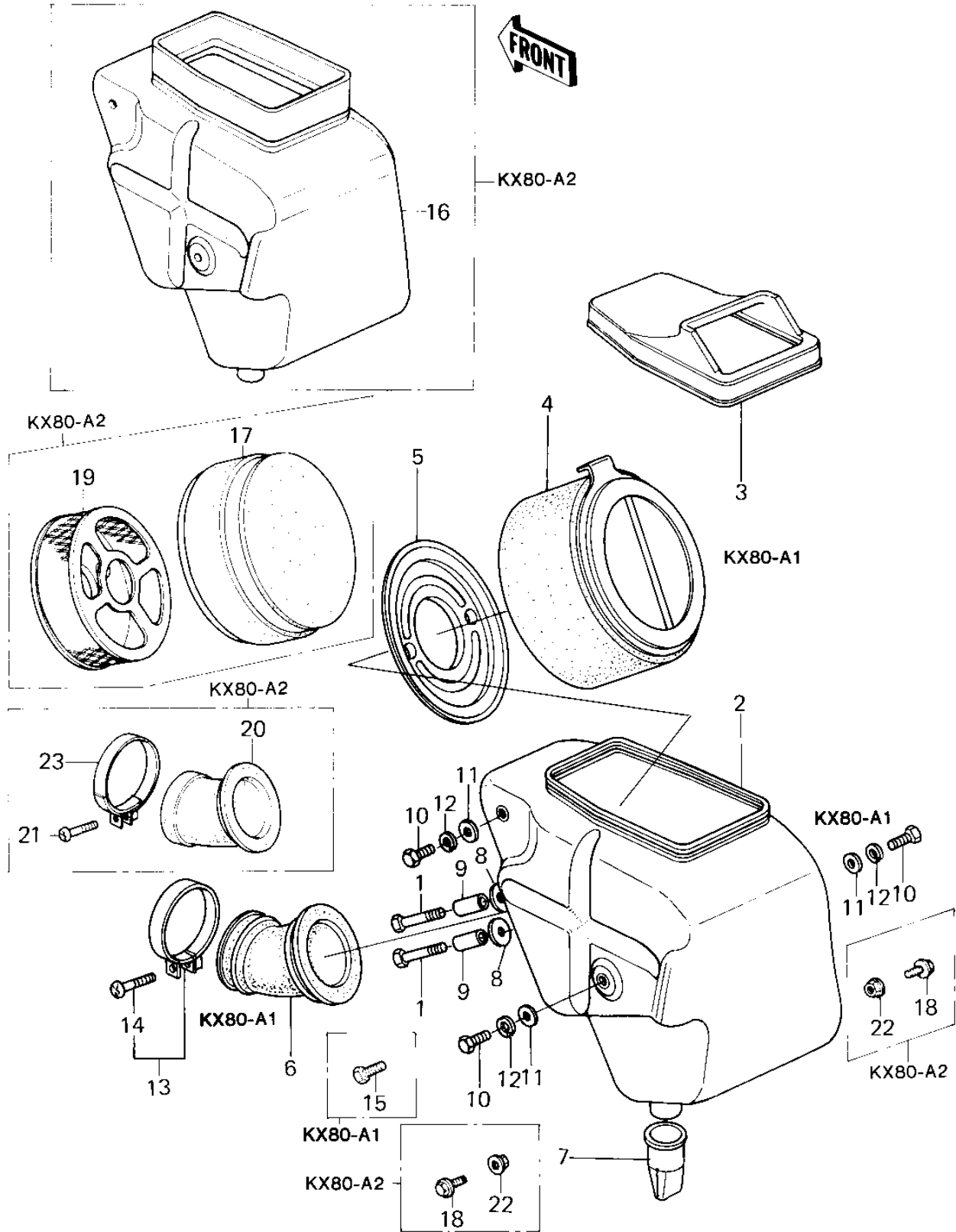

1979 KX80 PARTS LIST

AIR CLEANER

| ITEM NAME | PART NUMBER | QUANTITY |
|----------------------------------|-------------|----------|
| BOLT-UPSET (Ref # 1) | 112G0625 | 2 |
| CASE,AIR CLEANER (Ref # 2) | 11011-1045 | 1 |
| CAP,AIR CLEANER (Ref # 3) | 11012-1068 | 1 |
| ELEMENT,AIR CLNR (Ref # 4) | 11013-1016 | 1 |
| PLATE,AIR CLEANER (Ref # 5) | 13169-1162 | 1 |
| DUCT,AIR CLEANER (Ref # 6) | 14073-1017 | 1 |
| BOOT (Ref # 7) | 49006-1012 | 1 |
| WASHER 6.5X20X1.6T (Ref # 8) | 92022-125 | 2 |
| COLLAR (Ref # 9) | 92027-169 | 2 |
| BOLT-UPSET,6X12 (Ref # 10) | 112G0612 | 3 |
| WASHER PLAIN 6MM (Ref # 11) | 411B0600 | 3 |
| WASHER SPRING 6MM (Ref # 12) | 461F0600 | 3 |
| CLAMP (Ref # 13) | 92037-1326 | 1 |
| SCREW-PAN-CROS,6X35,B (Ref # 14) | 220C0635 | 1 |
| BOLT,6X10 (Ref # 15) | 112G0610 | 2 |
| CASE,AIR CLEANER (Ref # 16) | 11011-1045 | 1 |
| ELEMENT,AIR CLNR (Ref # 17) | 11013-1029 | 1 |
| BOLT,FLANGED,6X12 (Ref # 18) | 130G0612 | 3 |
| HOLDER,ELEMENT (Ref # 19) | 13091-1063 | 1 |
| DUCT,AIR CLEANER (Ref # 20) | 14073-1039 | 1 |
| SCREW PAN HEAD 4X25 (Ref # 21) | 220B0425 | 1 |
| NUT-6MM (Ref # 22) | 92015-1078 | 3 |
| CLAMP,CARBURETOR HOLD (Ref # 23) | 92037-1484 | 1 |