

1971 Mini-Trail PARTS DIAGRAM

FRONT FORK/FENDERS/CHAIN COVER ('71-'75)

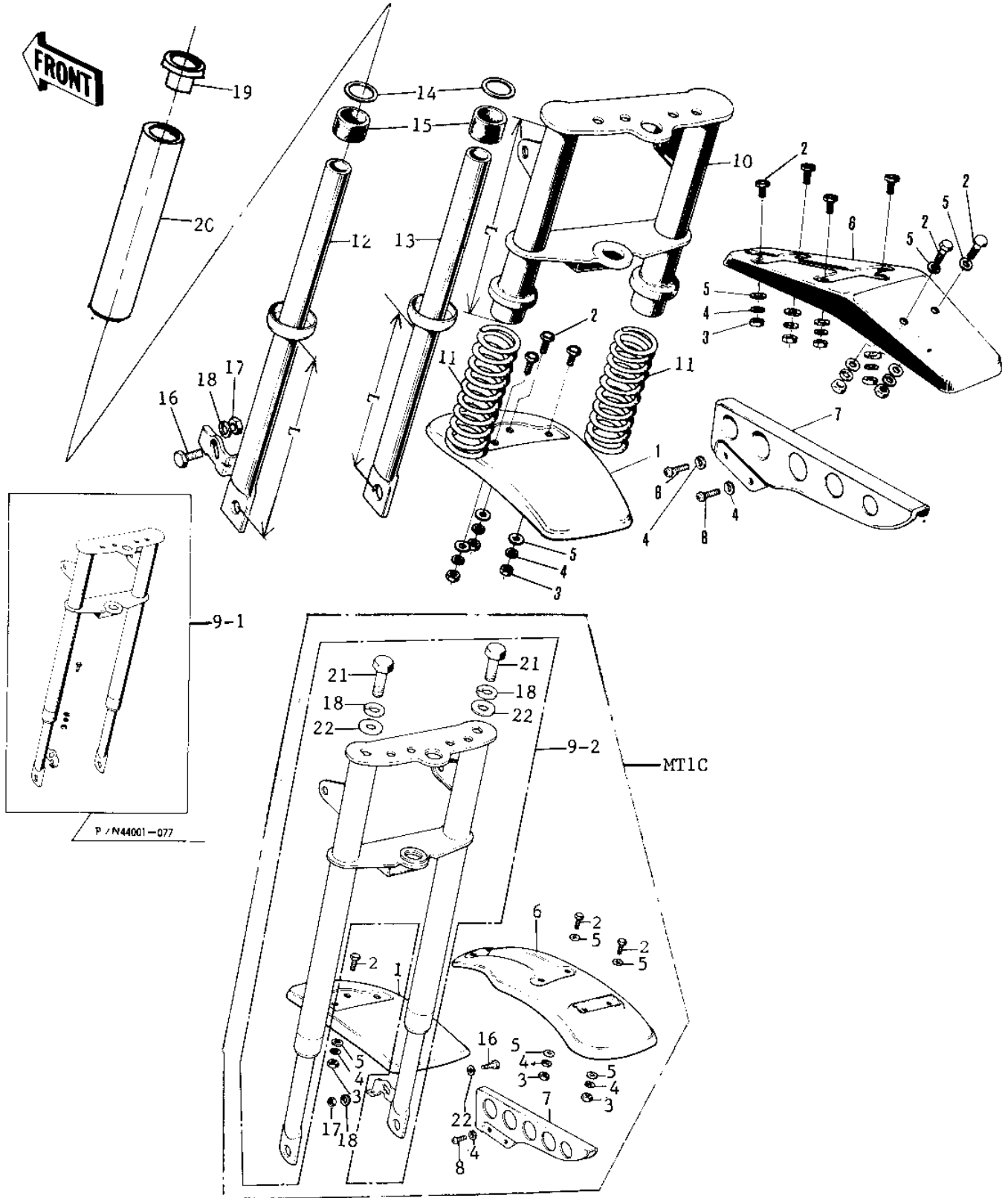

1971 Mini-Trail PARTS LIST

FRONT FORK/FENDERS/CHAIN COVER ('71-'75)

ITEM NAME	PART NUMBER	QUANTITY
FENDER-FR, GREEN (Ref # 1)	35004-058-54	1
FENDER-FR, B. ORANGE (Ref # 1)	35004-058-72	1
FENDER-FR, C. LIME (Ref # 1)	35004-087-1M	1
UNAVAILABLE IN PRICE BOOK (Ref # 1)	35004-087-3E	1
BOLT-UPSET 6X14 (Ref # 2)	112B0614	9
NUT 6MM (Ref # 3)	311B0600	9
WASHER SPRING 6MM (Ref # 4)	461F0600	11
WASHER PLAIN (Ref # 5)	92022-024	11
FENDER-REAR, BLACK (Ref # 6)	35023-011-10	1
FENDER-RR, C. LIME (Ref # 6)	35023-013-1M	1
FENDER-RR, BLACK (Ref # 6)	35023-013-10	1
CASE-CHAIN, BLACK (Ref # 7)	36014-036-21	1
SCREW PAN HEAD 6X10 (Ref # 8)	220B0610	2
FRONT FORK ASSY (Ref # 9 12)	44001-073	1
FRONT FORK ASSY (Ref # 9-1)	44001-077	1
FORK-FRONT (Ref # 9-2)	44001-159	1
BODY-FRONT FORK (Ref # 10)	44047-004	1
BODY-FRONT FORK (Ref # 10)	44047-005	1
SPRING-FORK (Ref # 11)	44026-032	2
TUBE, LH, FORK OUTER (Ref # 12)	44005-033	1
TUBE, LH, FORK OUTER (Ref # 12)	44005-036	1
TUBE, RH, FORK OUTER (Ref # 13)	44006-032	1
TUBE, RH, FORK OUTER (Ref # 13)	44006-034	1
GUIDE-FORK SPRING (Ref # 14)	44028-020	2
DAMPER RUBBER-FORK (Ref # 15)	92075-071	2
BOLT-UPSET, 10X20 (Ref # 16)	112B1020	1
NUT, 10MM (Ref # 17)	314B1000	1
NUT, 10MM (Ref # 17)	314B1000	1
WASHER SPRING 10MM (Ref # 18)	461F1000	1

1971 Mini-Trail PARTS LIST

FRONT FORK/FENDERS/CHAIN COVER ('71-'75)

ITEM NAME	PART NUMBER	QUANTITY
BUSH,SHORT (Ref # 19)	44065-002	2
BUSH-LONG (Ref # 20)	44065-003	2
BOLT,HEX HEAD,10X25 (Ref # 21)	113N1025	2
WASHER PLAIN 10MM (Ref # 22)	411B1000	3
FENDER-FR,GREEN (Ref # 1)	35004-058-54	1
FENDER-FR,B.ORANGE (Ref # 1)	35004-058-72	1
FENDER-FR,C.LIME (Ref # 1)	35004-087-1M	1
UNAVAILABLE IN PRICE BOOK (Ref # 1)	35004-087-3E	1
BOLT-UPSET 6X14 (Ref # 2)	112B0614	9
NUT 6MM (Ref # 3)	311B0600	9
WASHER SPRING 6MM (Ref # 4)	461F0600	11
WASHER PLAIN (Ref # 5)	92022-024	11
FENDER-REAR,BLACK (Ref # 6)	35023-011-10	1
FENDER-RR,C.LIME (Ref # 6)	35023-013-1M	1
FENDER-RR,BLACK (Ref # 6)	35023-013-10	1
CASE-CHAIN,BLACK (Ref # 7)	36014-036-21	1
SCREW PAN HEAD 6X10 (Ref # 8)	220B0610	2
FRONT FORK ASSY (Ref # 9 12)	44001-073	1
FRONT FORK ASSY (Ref # 9-1)	44001-077	1
FORK-FRONT (Ref # 9-2)	44001-159	1
BODY-FRONT FORK (Ref # 10)	44047-004	1
BODY-FRONT FORK (Ref # 10)	44047-005	1
SPRING-FORK (Ref # 11)	44026-032	2
TUBE,LH,FORK OUTER (Ref # 12)	44005-033	1
TUBE,LH,FORK OUTER (Ref # 12)	44005-036	1
TUBE,RH,FORK OUTER (Ref # 13)	44006-032	1
TUBE,RH,FORK OUTER (Ref # 13)	44006-034	1
GUIDE-FORK SPRING (Ref # 14)	44028-020	2
DAMPER RUBBER-FORK (Ref # 15)	92075-071	2