

# 1972 MT1A PARTS DIAGRAM

FRAME/FRAME FITTINGS/SEAT ('71-'75)

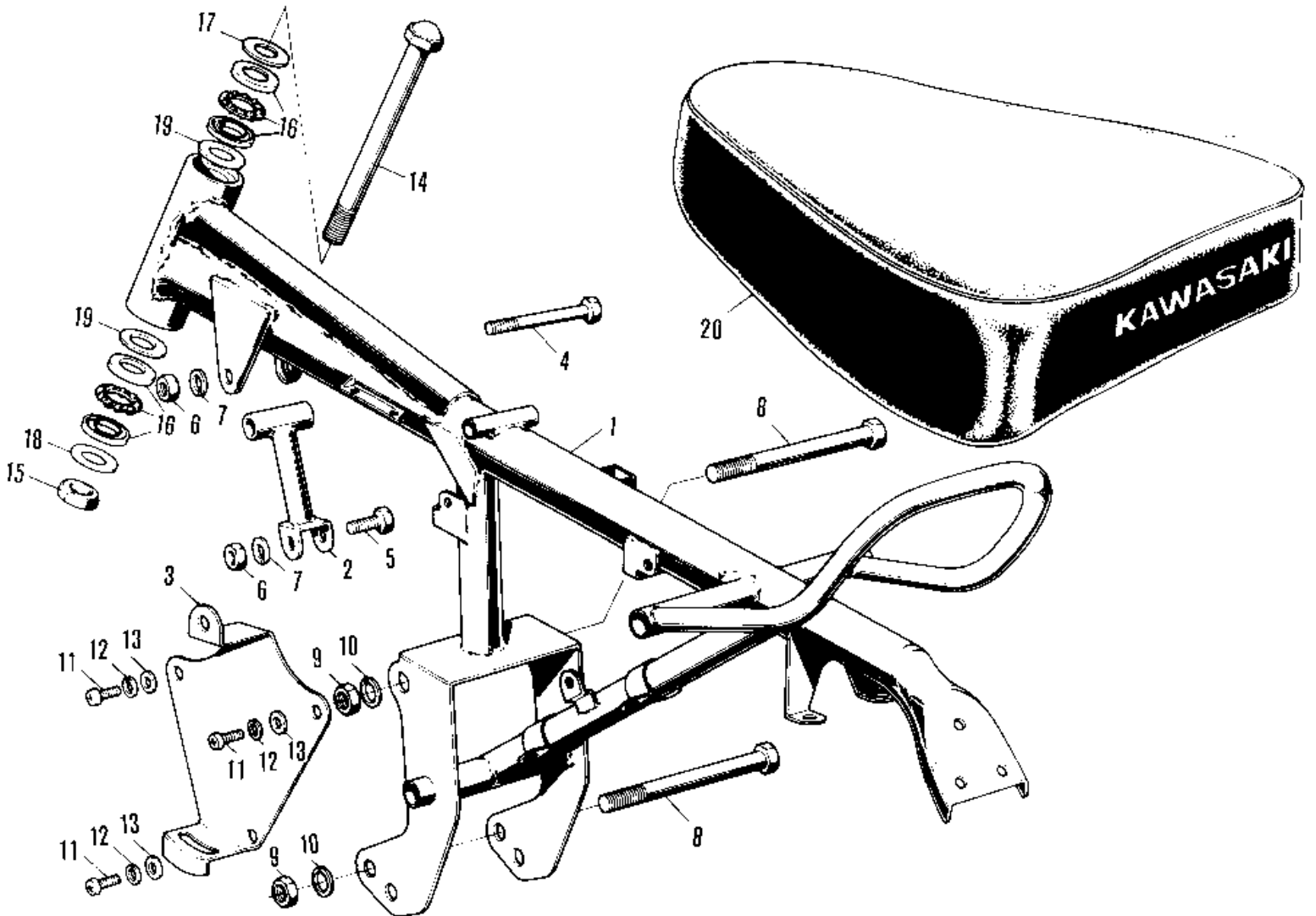

## 1972 MT1A PARTS LIST

FRAME/FRAME FITTINGS/SEAT ('71-'75)

| ITEM NAME                           | PART NUMBER | QUANTITY |
|-------------------------------------|-------------|----------|
| FRAME (Ref # 1)                     | 32002-144   |          |
| UNAVAILABLE IN PRICE BOOK (Ref # 1) | 32002-056   |          |
| TUBE-DOWN (Ref # 2)                 | 31076-016   |          |
| BRACKET-OIL TANK (Ref # 3)          | 32094-006   |          |
| UNAVAILABLE IN PRICE BOOK (Ref # 3) | 32094-007   |          |
| BOLT,HEX HEAD,8X85 (Ref # 4)        | 92001-1226  |          |
| BOLT (Ref # 5)                      | 92001-1578  |          |
| NUT,8MM (Ref # 6)                   | 311B0800    |          |
| WASHER SPRING 8MM (Ref # 7)         | 461F0800    |          |
| BOLT, FLANGED, 10X110 (Ref # 8)     | 92001-1602  |          |
| NUT,10MM (Ref # 9)                  | 314B1000    |          |
| WASHER SPRING 10MM (Ref # 10)       | 461F1000    |          |
| SCREW PAN HEAD 6X12 (Ref # 11)      | 220B0612    |          |
| WASHER SPRING 6MM (Ref # 12)        | 461F0600    |          |
| WASHER PLAIN 6MM (Ref # 13)         | 410B0600    |          |
| BOLT,STEERING HEAD (Ref # 14)       | 92001-156   |          |
| NUT-SELF LOCKING (Ref # 15)         | 92019-012   |          |
| THRUST BEARING (Ref # 16)           | 92119-001   |          |
| WASHER-PLAIN,16MM (Ref # 17)        | 411D1600    |          |
| WASHER-PLAIN,16MM (Ref # 18)        | 411B1600    |          |
| WASHER-PLAIN (Ref # 19)             | 92022-179   |          |
| COLLAR,STEERING (Ref # 19)          | 92027-1119  |          |
| SEAT (Ref # 20)                     | 53002-024   |          |