

1987 KX125 PARTS DIAGRAM

CLUTCH

E1350-0106

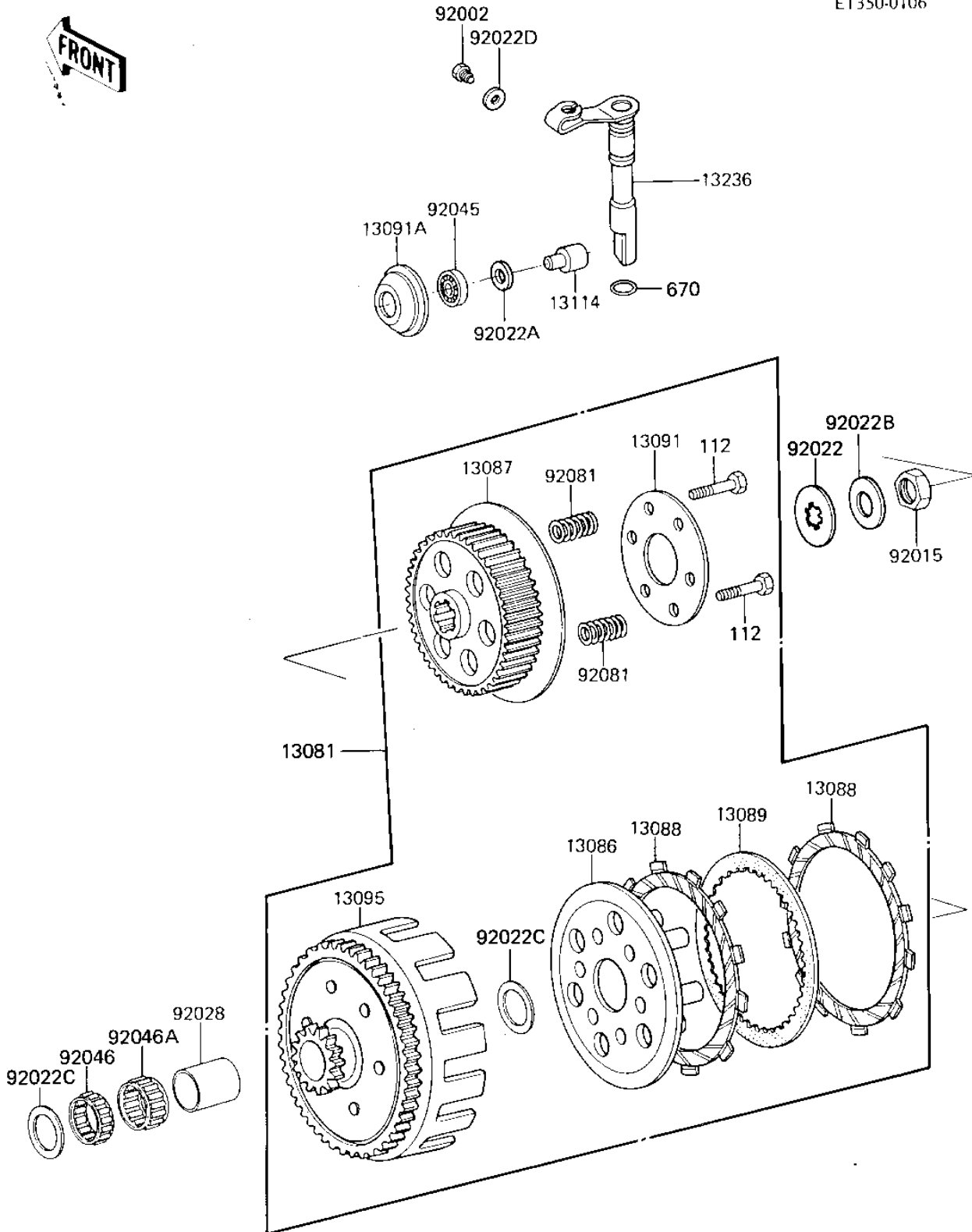

1987 KX125 PARTS LIST

CLUTCH

| ITEM NAME | PART NUMBER | QUANTITY |
|--------------------------------------|-------------|----------|
| CLUTCH-ASSY (Ref # 13081) | 13081-1187 | 1 |
| WHEEL-CLUTCH (Ref # 13086) | 13086-1056 | 1 |
| HUB-CLUTCH (Ref # 13087) | 13087-1060 | 1 |
| PLATE-FRICTION (Ref # 13088) | 13088-1058 | 1 |
| PLATE-CLUTCH (Ref # 13089) | 13089-1063 | 1 |
| HOLDER,CLUTCH (Ref # 13091) | 13091-1011 | 1 |
| HOLDER,CLUTCH PUSHER (Ref # 13091A) | 13091-1134 | 1 |
| HOUSING-COMP-CLUTCH (Ref # 13095) | 13095-1117 | 1 |
| PUSHER,CLUTCH (Ref # 13114) | 13114-1008 | 1 |
| LEVER-COMP,CLUTCH REL (Ref # 13236) | 13236-1121 | 1 |
| BOLT (Ref # 92002) | 92002-1706 | 1 |
| NUT,16MM (Ref # 92015) | 92015-1549 | 1 |
| WASHER,LOCK (Ref # 92022) | 92022-1124 | 1 |
| WASHER,7X12.5X0.8 (Ref # 92022A) | 92022-1290 | 1 |
| WASHER,16.3X29X1.75 (Ref # 92022B) | 92022-1356 | 1 |
| WASHER,17.3X30X1.4 (Ref # 92022C) | 92022-1761 | 1 |
| WASHER,PLAIN (Ref # 92022D) | 92022-304 | 1 |
| BUSHING,17X22X24.7 (Ref # 92028) | 92028-1325 | 1 |
| BEARING,BALL #627 (Ref # 92045) | 92045-026 | 1 |
| BEARING-NEEDLE,K22X26 (Ref # 92046) | 92046-1129 | 1 |
| BEARING-NEEDLE,K22X26 (Ref # 92046A) | 92046-1130 | 1 |
| SPRING,CLUTCH (Ref # 92081) | 92081-1637 | 1 |
| BOLT (Ref # 112) | 110G0520 | 1 |
| "O" RING,9MM (Ref # 670) | 670B1509 | 1 |