

# 1986 Ninja® 1000R PARTS DIAGRAM

## CANISTER

E1650-0616

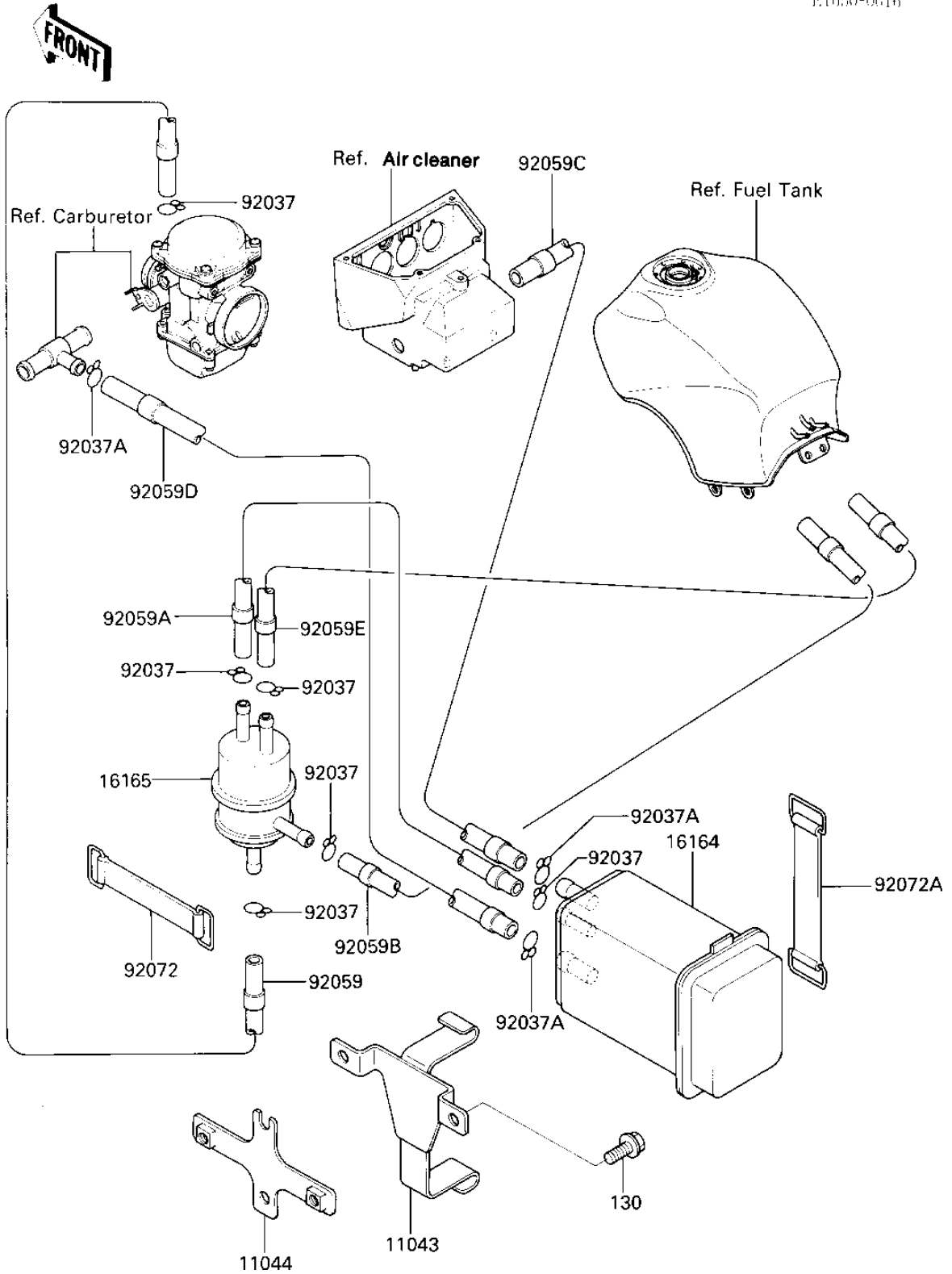

# 1986 Ninja® 1000R PARTS LIST

## CANISTER

| ITEM NAME                            | PART NUMBER | QUANTITY |
|--------------------------------------|-------------|----------|
| BRACKET,CANISTER (Ref # 11043)       | 11043-1831  | 1        |
| BRACKET,CANISTER (Ref # 11044)       | 11044-1236  | 1        |
| CANISTER (Ref # 16164)               | 16164-1064  | 1        |
| SEPARATOR (Ref # 16165)              | 16165-1001  | 1        |
| CLAMP FUEL PIPE (Ref # 92037)        | 92037-010   | 6        |
| CLAMP-HOSE (Ref # 92037A)            | 92037-1104  | 3        |
| TUBE (Ref # 92059)                   | 92059-1488  | 1        |
| TUBE,5X10X660,RED (Ref # 92059A)     | 92059-1502  | 1        |
| TUBE,5X8X980,BLUE (Ref # 92059B)     | 92059-1420  | 1        |
| TUBE,7X12X200,GREEN (Ref # 92059C)   | 92059-1642  | 1        |
| TUBE,TUBE,7X12X450,YE (Ref # 92059D) | 92059-1643  | 1        |
| TUBE,5X8X350,BLUE (Ref # 92059E)     | 92059-1644  | 1        |
| BAND,TOOL (Ref # 92072)              | 92072-066   | 1        |
| BAND,BATTERY (Ref # 92072A)          | 92072-071   | 1        |
| BOLT,FLANGED,6X10 (Ref # 130)        | 130B0610    | 4        |