

1986 ZL600 Eliminator PARTS DIAGRAM

CRANKCASE

E1411-0151

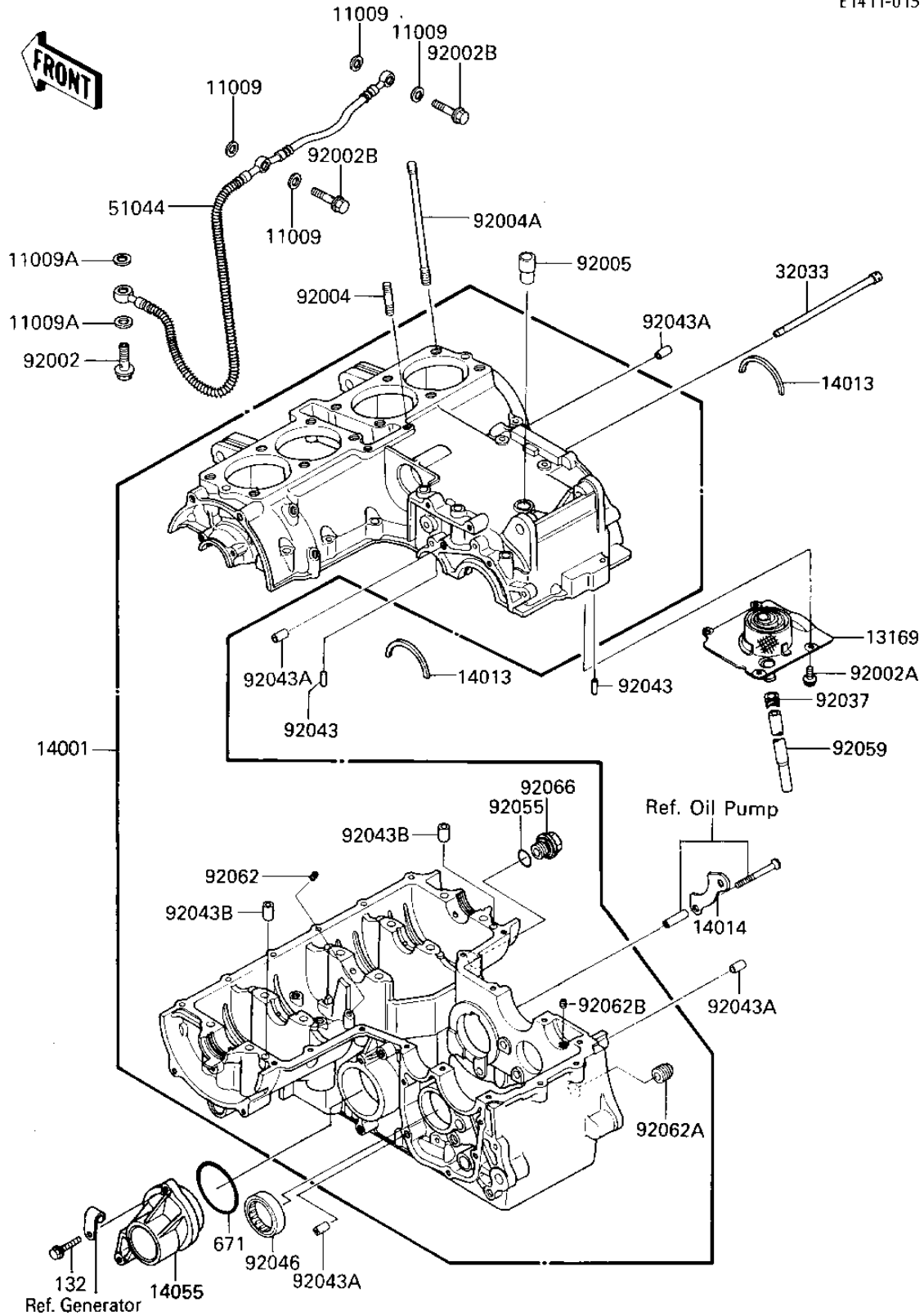

1986 ZL600 Eliminator PARTS LIST

CRANKCASE

ITEM NAME	PART NUMBER	QUANTITY
GASKET,OIL PIPE,8.2X1 (Ref # 11009)	11009-1344	4
GASKET,12.4X17X1.5 (Ref # 11009A)	11009-1376	2
PLATE,BREATHER (Ref # 13169)	13169-1966	1
SET-CRANKCASE (Ref # 14001)	14001-5217	1
RING BEARING SETTING (Ref # 14013)	14013-004	2
PLATE,POSITION (Ref # 14014)	14014-1006	1
CASE-GEAR (Ref # 14055)	14055-1078	1
PIPE,OIL (Ref # 32033)	32033-1858	1
TUBE-ASSY (Ref # 51044)	51044-1071	1
BOLT,BANJO,12X23 (Ref # 92002)	92001-1871	1
BOLT,6X10 (Ref # 92002A)	92002-1449	4
BOLT (Ref # 92002B)	92002-1858	2
STUD (Ref # 92004)	92004-059	2
STUD (Ref # 92004A)	92004-1161	12
FITTING,BREATHER (Ref # 92005)	92005-1129	1
CLAMP (Ref # 92037)	92037-1181	1
PIN DOWEL 6MM (Ref # 92043)	92042-016	2
PIN,DOWEL,6.2X8X14 (Ref # 92043A)	92043-1263	4
PIN,DOWEL,8.2X10X14 (Ref # 92043B)	92043-1264	2
BRG,NEDL,37BTM4312 (Ref # 92046)	92046-051	1
RING-O (Ref # 92055)	92055-1146	1
TUBE (Ref # 92059)	92059-1544	1
NOZZLE,OIL BIAS (Ref # 92062)	92062-011	1
NOZZLE (Ref # 92062A)	92062-014	1
NOZZLE (Ref # 92062B)	92062-015	1
PLUG,MAIN GALLERY,18X (Ref # 92066)	92066-1096	1
BOLT-FLANGED-SMALL (Ref # 132)	132J0625	2
"O" RING,55MM (Ref # 671)	671B2555	1