

1985 LTD Shaft PARTS DIAGRAM

MUFFLERS

E1140-0203

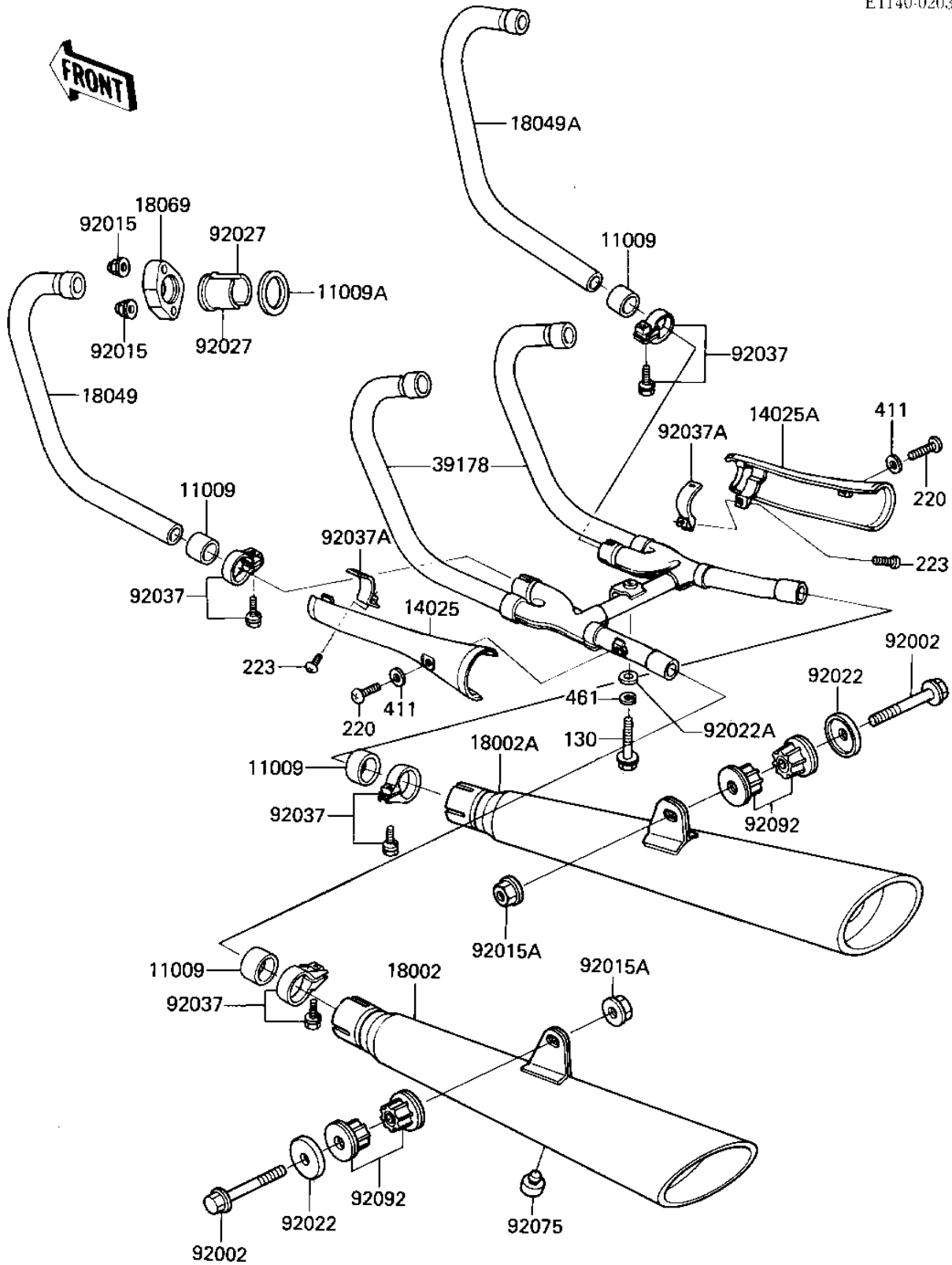

1985 LTD Shaft PARTS LIST

MUFFLERS

ITEM NAME	PART NUMBER	QUANTITY
GASKET,EXHAUST PIPE C (Ref # 11009)	11009-1667	4
GASKET,EXHAUST PIPE H (Ref # 11009A)	11009-1866	4
COVER,MUFFLER,LH (Ref # 14025)	14025-1840	1
COVER,MUFFLER,RH (Ref # 14025A)	14025-1841	1
BODY-COMP-MUFFLER,LH (Ref # 18002)	18002-1524	1
BODY-COMP-MUFFLER,RH (Ref # 18002A)	18002-1525	1
PIPE-EXHAUST,#2 (Ref # 18049)	18049-1162	1
PIPE-EXHAUST,#3 (Ref # 18049A)	18049-1163	1
HOLDER-EXHAUST PIPE (Ref # 18069)	18069-1030	4
MANIFOLD-COMP-EXHAUST (Ref # 39178)	39178-1056	1
BOLT,10X55 (Ref # 92002)	92002-1127	2
NUT,8MM (Ref # 92015)	92015-1398	8
NUT,LOCK,10MM (Ref # 92015A)	92019-021	2
WASHER,CUP TYPE (Ref # 92022)	92022-1270	2
WASHER-PLN,10X22X3.2 (Ref # 92022A)	92022-176	1
COLLAR,EXHAUST PIPE (Ref # 92027)	92027-1142	8
CLAMP,42MM (Ref # 92037)	92037-1349	4
CLAMP,MUFFLER COVER,C (Ref # 92037A)	92037-1373	2
DAMPER RUBBER,MAIN ST (Ref # 92075)	92075-1002	1
BUSHING-RUBBER (Ref # 92092)	92092-1013	4
BOLT-FLANGED (Ref # 130)	130Y0850	1
SCREW PAN HEAD 6X8 (Ref # 220)	220E0608	2
SCREW-PAN-WS-CROS (Ref # 223)	223X0616	2
WASHER-PLAIN,6MM (Ref # 411)	411D0600	2
WASHER-SPRING (Ref # 461)	461L0800	1