

# 1984 GPz PARTS DIAGRAM

## FRONT MASTER CYLINDER

F2291-0114

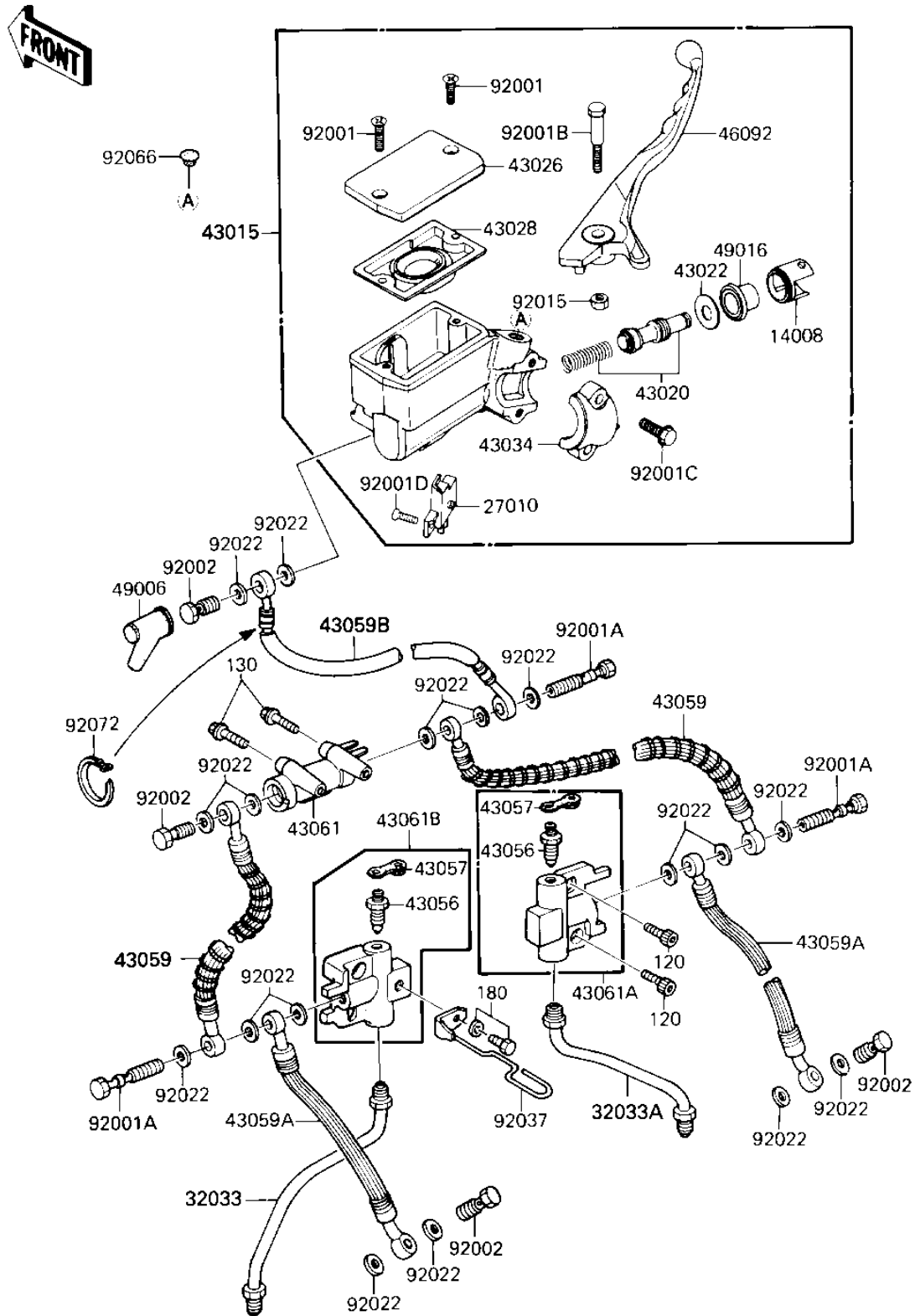

# 1984 GPz PARTS LIST

## FRONT MASTER CYLINDER

ITEM NAME	PART NUMBER	QUANTITY
LINER,PISTON (Ref # 14008)	14008-1035	1
SWITCH,BRAKE (Ref # 27010)	27010-1056	1
PIPE-A,BRAKE (Ref # 32033)	32033-1080	1
PIPE,FR,RH (Ref # 32033A)	32033-1176	1
CYLINDER-ASSY-MASTER (Ref # 43015)	43015-1085	1
PISTON-COMP-BRAKE (Ref # 43020)	43020-1079	1
STOPPER-BRAKE,PISTON (Ref # 43022)	43022-1009	1
CAP-BRAKE,FRONT (Ref # 43026)	43026-1017	1
DIAPHRAGM,MASTER CYL1 (Ref # 43028)	43028-1029	1
HOLDER-BRAKE,MASTER C (Ref # 43034)	43034-1013	1
BREATHER-BRAKE (Ref # 43056)	43056-1051	2
CAP-BREATHER (Ref # 43057)	43057-1001	2
HOSE-BRAKE,FR,LH,UPP, (Ref # 43059)	43059-1170	2
HOSE-BRAKE,FR,L=210 (Ref # 43059A)	43059-1256	2
HOSE-BRAKE,FR,L=305 (Ref # 43059B)	43059-1257	1
JOINT BRAKE (Ref # 43061)	43061-1004	1
JOINT-BRAKE,FR,RH (Ref # 43061A)	43061-1005	1
JOINT-BRAKE,FR,LH (Ref # 43061B)	43061-1006	1
LEVER-GRIP,MASTER CYL (Ref # 46092)	46092-1026	1
BOOT,DUST (Ref # 49006)	49006-1041	1
COVER-SEAL,BRK PISTON (Ref # 49016)	49016-1041	1
SCREW,COUNTERSUNK HED (Ref # 92001)	92001-1055	2
BOLT (Ref # 92001A)	92002-1909	3
BOLT,6X37.3,BLACK (Ref # 92001B)	92001-1512	1
BOLT,W/WASHER,6X25,BL (Ref # 92001C)	92001-1513	2
SCREW-COUNTERSUNK (Ref # 92001D)	92001-1532	1
BOLT,OIL,L=23 (Ref # 92002)	92002-1888	4
NUT,LOCK,6MM,BLACK (Ref # 92015)	92015-1191	1
WASHER-OIL BOLT (Ref # 92022)	43067-001	17

# 1984 GPz PARTS LIST

## FRONT MASTER CYLINDER

ITEM NAME	PART NUMBER	QUANTITY
CLAMP,BRAKE HOSE,LH,B (Ref # 92037)	92037-1393	1
PLUG,9.5X8 (Ref # 92066)	92066-1077	1
BAND,WIRING HARNESS (Ref # 92072)	92072-056	1
BOLT-SOCKET,6X14,BLAC (Ref # 120)	120S0614	4
BOLT-FLANGED,6X60 (Ref # 130)	130G0660	2
BOLT-UPSET-WS (Ref # 180)	180C0612	1