

# 1984 KDX200 PARTS DIAGRAM

REAR HUB/BRAKE/CHAIN

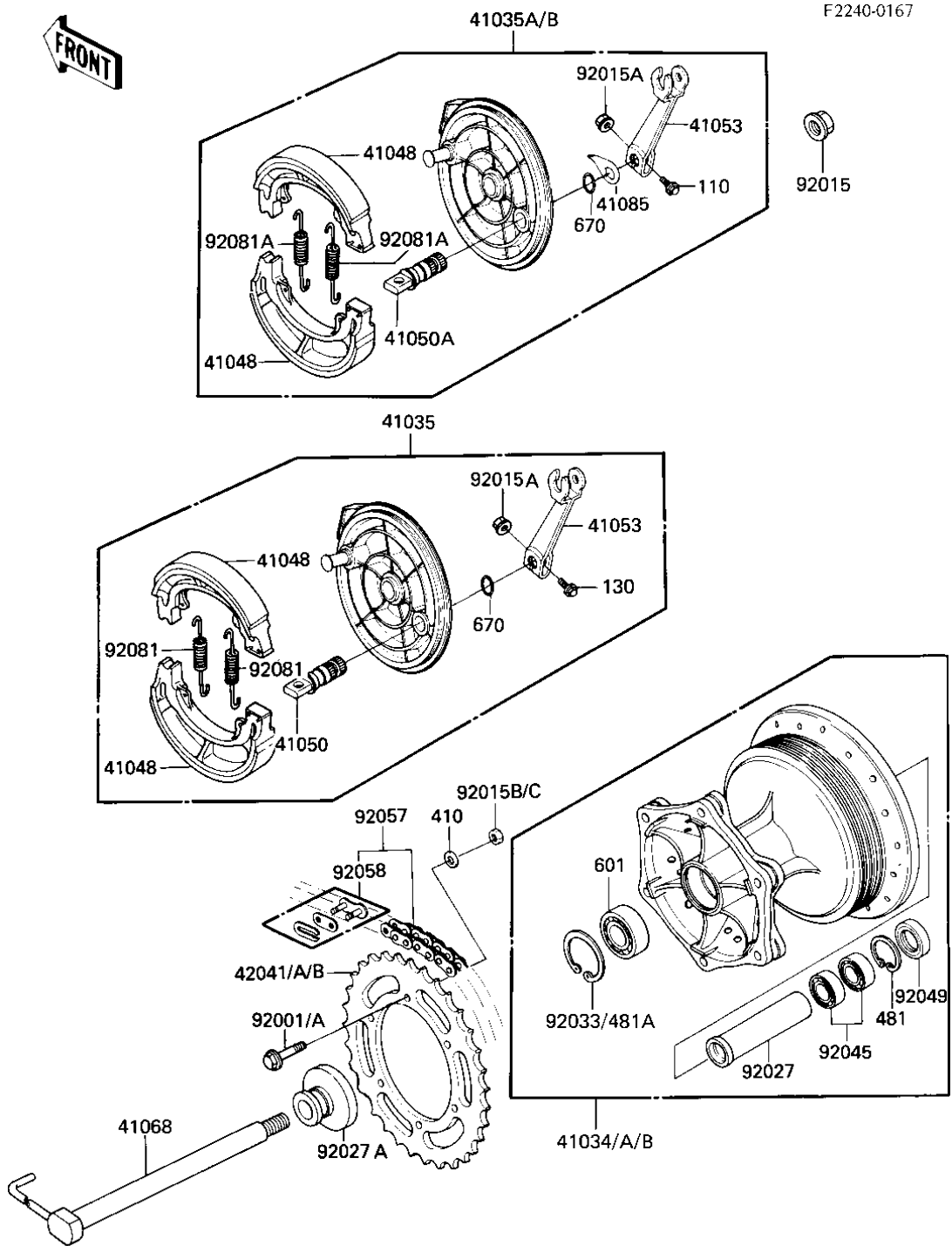

# 1984 KDX200 PARTS LIST

## REAR HUB/BRAKE/CHAIN

| ITEM NAME                           | PART NUMBER | QUANTITY |
|-------------------------------------|-------------|----------|
| DRUM-ASSY,REAR BRAKE (Ref # 41034A) | 41034-1108  | 1        |
| PANEL-ASSY-BRAKE,RR (Ref # 41035A)  | 41035-1157  | 1        |
| PANEL-ASSY-BRAKE,RR (Ref # 41035B)  | 41035-1186  | 2        |
| SHOE-BRAKE (Ref # 41048)            | 42019-013   | 2        |
| CAM-BRAKE (Ref # 41050A)            | 41050-1053  | 1        |
| LEVER-BRAKE CAM,RR (Ref # 41053)    | 41053-1033  | 1        |
| AXLE,RR (Ref # 41068)               | 41068-1074  | 1        |
| INDICATOR,BKSHOE (Ref # 41085)      | 41085-003   | 1        |
| SPROCKET-HUB,48T (Ref # 42041)      | 42041-1125  | 1        |
| SPROCKET-HUB,49T (Ref # 42041B)     | 42041-1183  | 1        |
| BOLT,HEX HEAD,8X32 (Ref # 92001)    | 92001-1040  | 6        |
| NUT,16M/M (Ref # 92015)             | 92015-1015  | 1        |
| NUT-6MM (Ref # 92015A)              | 92015-1078  | 1        |
| NUT-8MM (Ref # 92015C)              | 92015-1143  | 6        |
| COLLAR,REAR DRUM,L=10 (Ref # 92027) | 92027-1459  | 1        |
| COLLAR,AXLE (Ref # 92027A)          | 92027-1531  | 1        |
| BEARING-BALL (Ref # 92045)          | 92045-1053  | 2        |
| SEAL-OIL,BJN22325 (Ref # 92049)     | 92049-1103  | 1        |
| CHAIN,DRIVE,112L (Ref # 92057)      | 92057-1117  | 1        |
| JOINT-CHAIN (Ref # 92058)           | 92058-1051  | 1        |
| SPRING,BRAKE SHOE (Ref # 92081A)    | 92081-1766  | 2        |
| BOLT-UPSET (Ref # 110)              | 112G0630    | 1        |
| CIRCLIP 30MM (Ref # 481)            | 481J3000    | 1        |
| CIRCLIP,42MM (Ref # 481A)           | 92033-1041  | 1        |
| BEARING-BALL,#6004U (Ref # 601)     | 601B6004U   | 1        |
| "O" RING,12MM (Ref # 670)           | 670B2012    | 1        |