

1983 KDX200 PARTS DIAGRAM

TRANSMISSION

E1361-0112

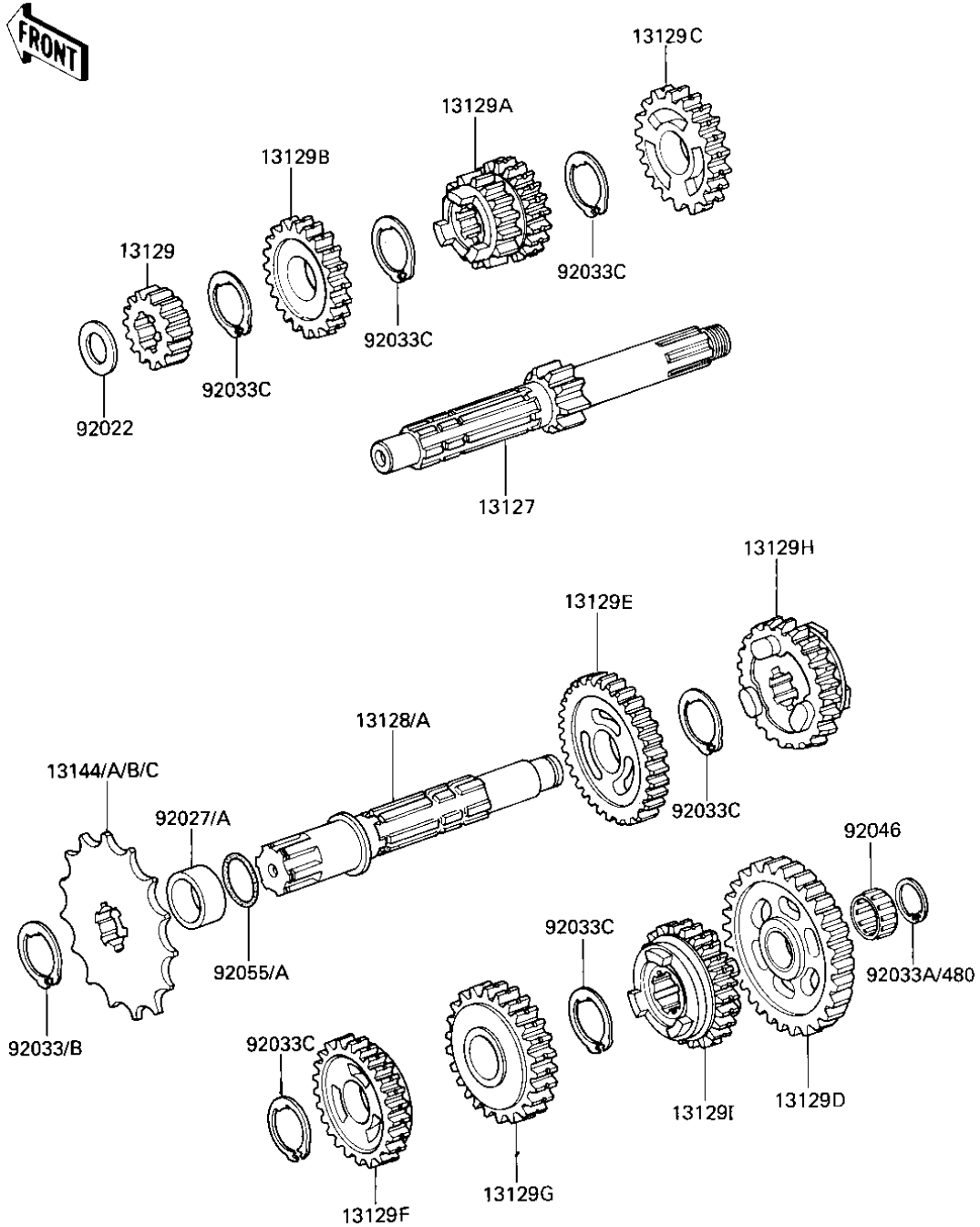

1983 KDX200 PARTS LIST

TRANSMISSION

ITEM NAME	PART NUMBER	QUANTITY
SHAFT-TRANSMISSION IN (Ref # 13127)	13127-1064	1
SHAFT-TRANSMISSION OU (Ref # 13128)	13128-1049	1
GEAR,INPUT 2ND,14T (Ref # 13129)	13129-1397	1
GEAR,INPUT 3RD&4TH,15 (Ref # 13129A)	13129-1398	1
GEAR,INPUT 5TH,24T (Ref # 13129B)	13129-1399	1
GEAR,INPUT TOP,23T (Ref # 13129C)	13129-1400	1
GEAR,OUTPUT LOW,36T (Ref # 13129D)	13129-1401	1
GEAR,OUTPUT 2ND,28T (Ref # 13129E)	13129-1402	1
GEAR,OUTPUT 3RD,23T (Ref # 13129F)	13129-1403	1
GEAR,OUTPUT 4TH,21T (Ref # 13129G)	13129-1404	1
GEAR,OUTPUT 5TH,25T (Ref # 13129H)	13129-1405	1
GEAR,OUTPUT TOP,20T (Ref # 13129I)	13129-1406	1
ENGINE SPROCKET,11T (Ref # 13144A)	13144-1036	1
SPROCKET-OUTPUT,12T (Ref # 13144B)	13144-1049	1
SPROCKET-OUTPUT 13T (Ref # 13144C)	13144-1050	1
WASHER-THRUST (Ref # 92022)	92022-170	1
COLLAR,20X25X10.8 (Ref # 92027)	92027-1445	1
RING-SNAP,18MM (Ref # 92033B)	92033-1079	1
RING-SNAP (Ref # 92033C)	92033-1231	1
BEARING-NEEDLE (Ref # 92046)	92046-1184	1
"O" RING,NEWTRAL PST (Ref # 92055A)	92055-078	1
CIRCLIP 15MM (Ref # 480)	480J1500	1