

1986 Eliminator PARTS DIAGRAM

TRANSMISSION

E1361-0159

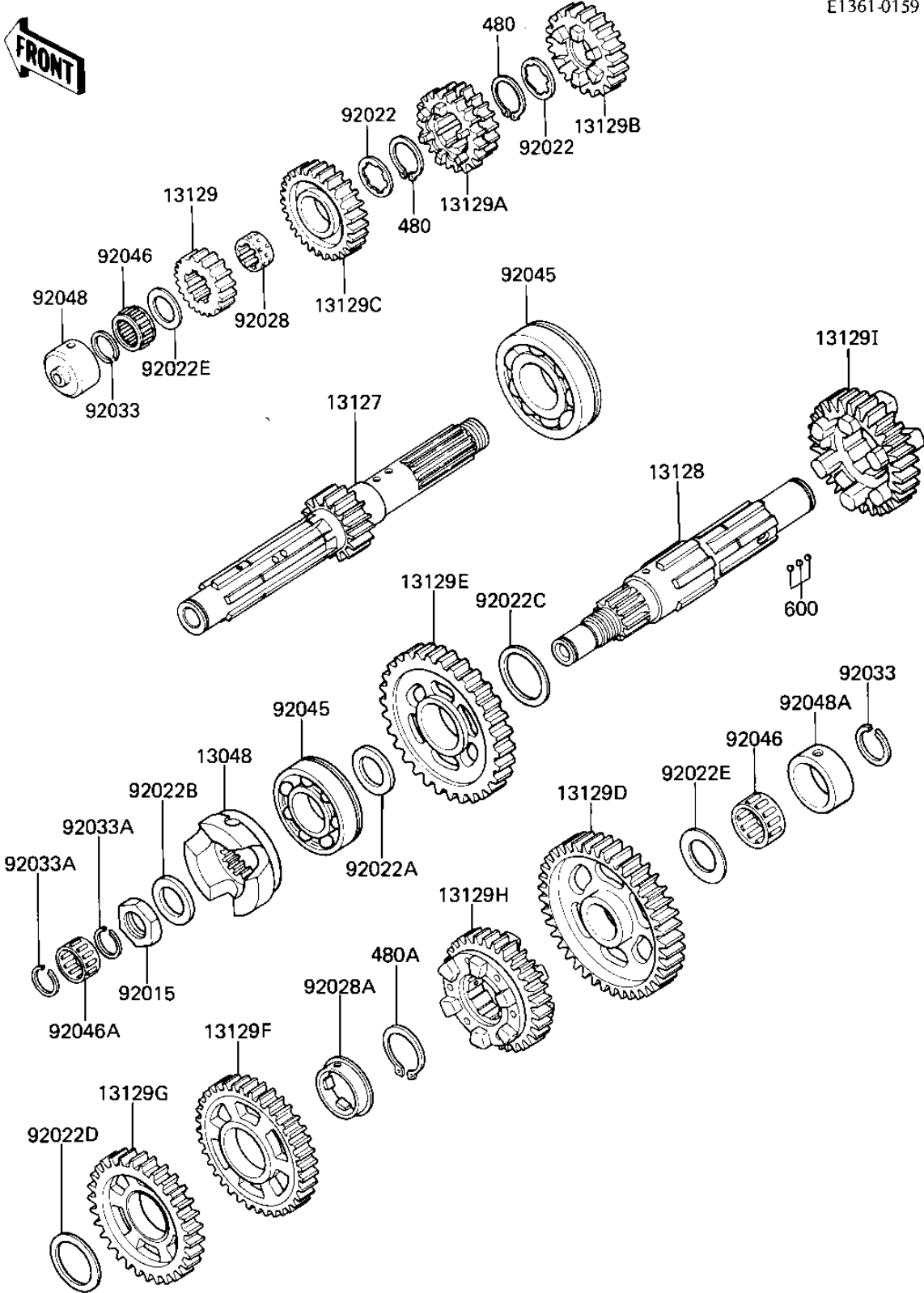

1986 Eliminator PARTS LIST

TRANSMISSION

ITEM NAME	PART NUMBER	QUANTITY
CAM-DAMPER (Ref # 13048)	13048-1060	1
SHAFT-TRANSMISSION IN (Ref # 13127)	13127-1196	1
SHAFT-TRANSMISSION OU (Ref # 13128)	13128-1138	1
GEAR,INPUT 2ND,19T (Ref # 13129)	13129-1530	1
GEAR,INPUT 3RD&4TH,22 (Ref # 13129A)	13129-1531	1
GEAR,INPUT 5TH,26T (Ref # 13129B)	13129-1532	1
GEAR,INPUT TOP,28T (Ref # 13129C)	13129-1533	1
GEAR,OUTPUT LOW,42T (Ref # 13129D)	13129-1534	1
GEAR,OUTPUT 2ND,38T (Ref # 13129E)	13129-1700	1
GEAR,OUTPUT 3RD,35T (Ref # 13129F)	13129-1701	1
GEAR,OUTPUT 4TH,32T (Ref # 13129G)	13129-1702	1
GEAR,OUTPUT 5TH,30T (Ref # 13129H)	13129-1703	1
GEAR,OUTPUT TOP,29T (Ref # 13129I)	13129-1704	1
NUT 20MM (Ref # 92015)	92016-028	1
WASHER,LOCK (O.D=35) (Ref # 92022)	92022-1077	2
WASHER,28.3X42X2.9 (Ref # 92022A)	92022-1219	1
WASHER,20.3X32X4.5 (Ref # 92022B)	92022-1692	1
WASHER,32X40X1.6 (Ref # 92022C)	92022-1693	1
WASHER,30X38X2.0 (Ref # 92022D)	92022-1694	1
WASHER,PLAIN,22MM (Ref # 92022E)	92022-212	2
BUSHING, TOP GEAR (Ref # 92028)	92028-1124	1
BUSHING,OUTPUT 3RD GE (Ref # 92028A)	92028-1374	1
CIRCLIP,25MM (Ref # 92033)	92033-025	2
CIRCLIP (Ref # 92033A)	92033-028	2
BEARING-BALL (Ref # 92045)	92045-1186	2
BEARING,PK223013.8 (Ref # 92046)	92046-031	2
BEARING-NEEDLE,K17X23 (Ref # 92046A)	92046-1145	1
RACE,INPUT SHAFT (Ref # 92048)	92048-1052	1
RACE,30X38X15 (Ref # 92048A)	92048-1053	1

1986 Eliminator PARTS LIST

TRANSMISSION

ITEM NAME	PART NUMBER	QUANTITY
CIRCLIP 28MM (Ref # 480)	480J2800	2
CIRCLIP (Ref # 480A)	480J2900	1
BALL STEEL 5/32' (Ref # 600)	600A0500	3