

1985 KL600 PARTS DIAGRAM

REAR SUSPENSION

F2150-0043

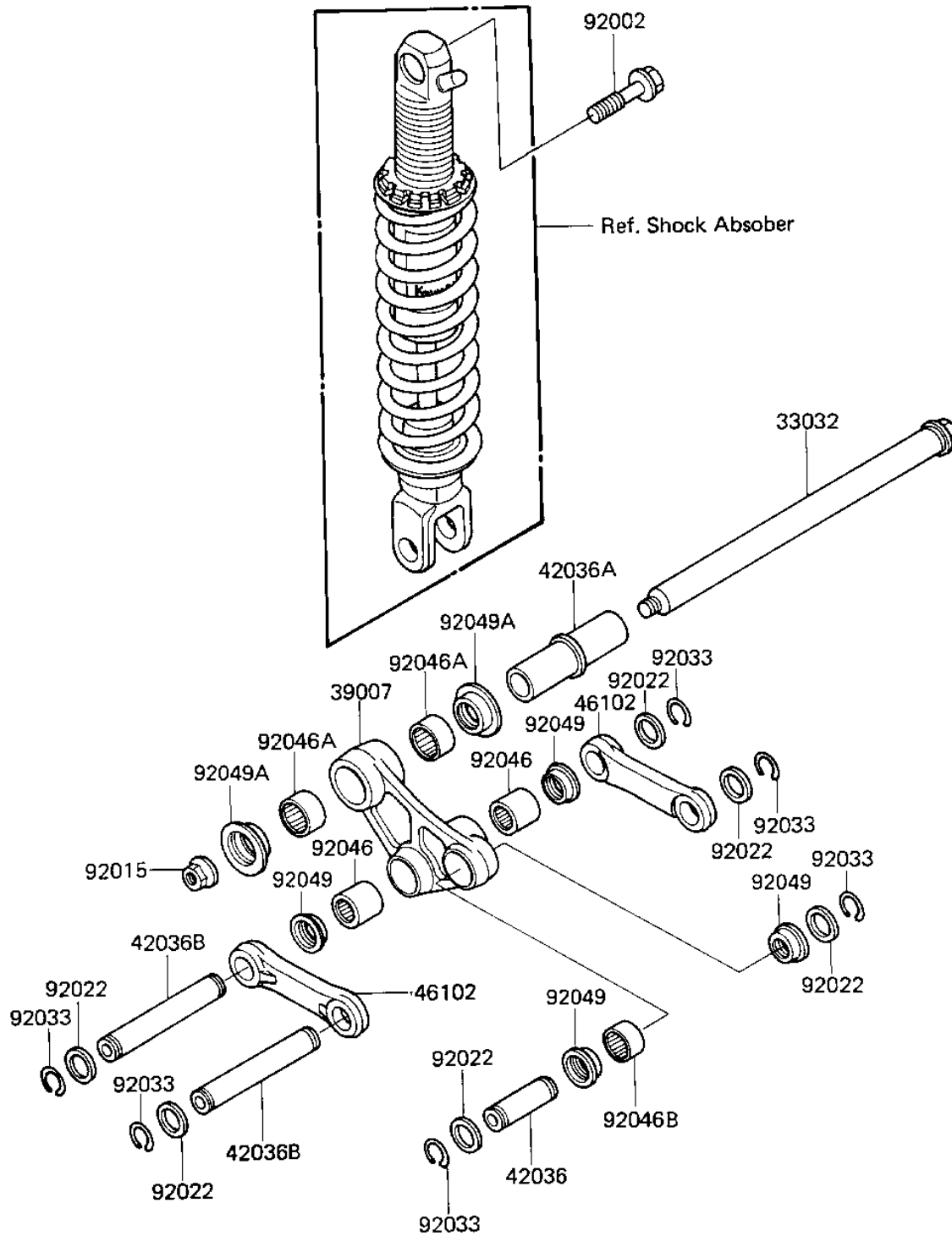

1985 KL600 PARTS LIST

REAR SUSPENSION

| ITEM NAME | PART NUMBER | QUANTITY |
|--------------------------------------|-------------|----------|
| SHAFT-SWING ARM (Ref # 33032) | 33032-1107 | 1 |
| ARM-SUSP,UNI TRAK (Ref # 39007) | 39007-1057 | 1 |
| SLEEVE (Ref # 42036) | 42036-1133 | 1 |
| SLEEVE (Ref # 42036A) | 42036-1135 | 1 |
| SLEEVE,L=121 (Ref # 42036B) | 42036-1140 | 1 |
| ROD,UNI TRAK (Ref # 46102) | 46102-1115 | 1 |
| BOLT,12X55 (Ref # 92002) | 92002-1130 | 1 |
| NUT,14MM (Ref # 92015) | 92015-1459 | 1 |
| WASHER,20.1X28X1 (Ref # 92022) | 92022-1547 | 1 |
| RING-SNAP,18.3MM (Ref # 92033) | 92033-1168 | 1 |
| BEARING-NEEDLE,BM2027 (Ref # 92046) | 92046-1110 | 1 |
| BEARING-NEEDLE,BM2834 (Ref # 92046A) | 92046-1111 | 1 |
| BEARING-NEEDLE,BM2027 (Ref # 92046B) | 92046-1112 | 1 |
| SEAL-OIL,ARM,CNT (Ref # 92049) | 92049-1109 | 1 |
| SEAL-OIL (Ref # 92049A) | 92049-1181 | 1 |