

## 1985 KL600 PARTS DIAGRAM

TRANSMISSION

E1361-0132

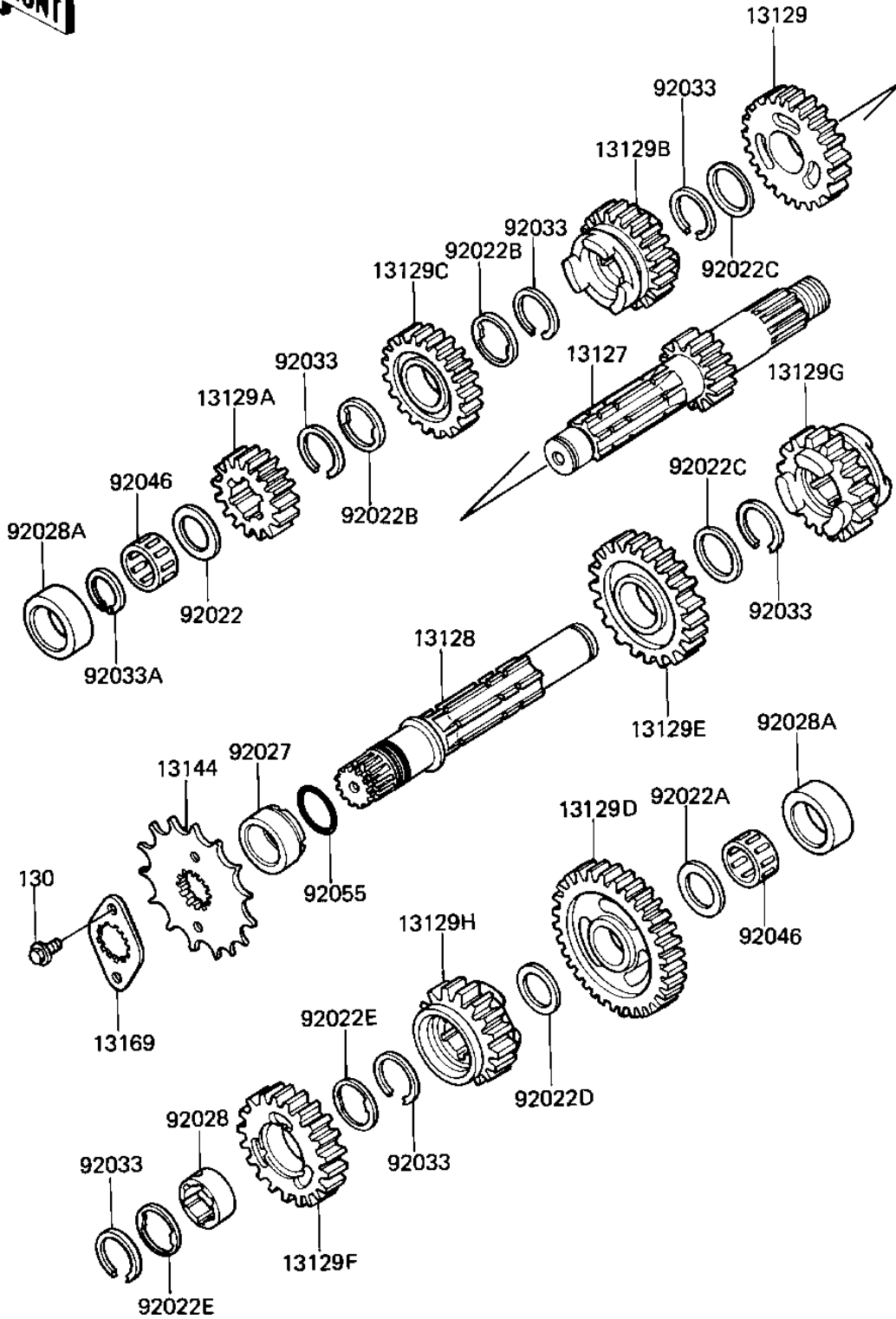

## 1985 KL600 PARTS LIST

### TRANSMISSION

ITEM NAME	PART NUMBER	QUANTITY
SHAFT-TRANSMISSION IN (Ref # 13127)	13127-1107	1
SHAFT-TRANSMISSION OU (Ref # 13128)	13128-1104	1
GEAR,INPUT TOP,24T (Ref # 13129)	13129-1410	1
GEAR,INPUT 2ND,17T (Ref # 13129A)	13129-1518	1
GEAR,INPUT 3RD,22T (Ref # 13129B)	13129-1519	1
GEAR,INPUT 4TH,22T (Ref # 13129C)	13129-1520	1
GEAR,OUTPUT LOW,39T (Ref # 13129D)	13129-1522	1
GEAR,OUTPUT 2ND,26T (Ref # 13129E)	13129-1523	1
GEAR,OUTPUT 3RD,26T (Ref # 13129F)	13129-1524	1
GEAR,OUTPUT 4TH,21T (Ref # 13129G)	13129-1525	1
GEAR,OUTPUT TOP,19T (Ref # 13129H)	13129-1575	1
SPROCKET-OUTPUT,15T (Ref # 13144)	13144-1103	1
PLATE,SPROCKET (Ref # 13169)	13270-1060	1
WASHER THRUST (Ref # 92022)	92022-112	1
WASHER,20.3X29X0.5 (Ref # 92022A)	92022-1479	1
WASHER,TOOTHED,25.3X2 (Ref # 92022B)	92022-1482	1
WASHER-PLAIN 25MM (Ref # 92022C)	92022-159	1
WASHER (Ref # 92022D)	92022-252	1
WASHER-LOCK (Ref # 92022E)	92024-038	1
COLLAR (Ref # 92027)	92027-1800	1
BUSHING,OUTPUT 3RD GE (Ref # 92028)	92028-1299	1
BUSHING (Ref # 92028A)	92028-131	1
CIRCLIP (Ref # 92033)	92033-026	1
CIRCLIP,18MM (Ref # 92033A)	92033-029	1
BEARING-NEEDLE,KT2026 (Ref # 92046)	92046-1170	1
RING-O (Ref # 92055)	92055-1293	1
BOLT-FLANGED (Ref # 130)	130G0608	1